

INSTALLATION MANUAL

CARGO CARRIER

Level of Difficulty

Easy

Parts List - Starter Kit

Item	Qty	Description
1	1	Base
2	1	Top frame
3	2	Upright post
4	2	Extension tube
5	2	Floor brace beam
6	6	Leveler, 5/16"-18 x 1"
7	8	Short screw, 5/16"-18 x 1/2"
8	10	Long screw, 5/16"-18 x 2"
9	1	Allen wrench, 3/16"

Parts List - Cargo Carrier Kit

Item	Qty	Description
10	4	Crossbar with receiver
11	16	Medium screw, 5/16"-18 x 1-1/2" (4 per upright frame)

NOTICE

To make products more compact when on display, try the following tips:

- Reverse-mount the crossbar with receiver and install the product through the back.
- Use 2nd hole-position on 'Receiver Beam'

A fifth mounting position exists to accommodate the following potential needs:

- If more headroom is desired between two of the product tiers
- If mounting a fifth product on side B is desired and is tested to be stable

Before you begin installation, read all instructions thoroughly.

Proper tools will improve the quality of installation and reduce the time required.

Display Photo (product not included)



CAUTION

Care must be taken to avoid damage or injury. Do not overload display.

The following cargo carrier part #s are authorized for installation on side B only after installing at least three cargo carriers on side A. The bottom half of the starter kit frame must also be flipped to be in the alternate position (see step XX)

- part #
- part #
- part #
- part #



ASSEMBLY

Parts List - Starter Kit

Item	Qty	Description
1	1	Base
2	1	Top frame
3	2	Upright post
4	2	Extension tube
5	2	Floor brace beam
6	6	Leveler, 5/16"-18 x 1"
7	8	Short screw, 5/16"-18 x 1/2"
8	10	Long screw, 5/16"-18 x 2"
9	1	Allen wrench, 3/16"

Parts List - Cargo Carrier Kit

Item	Qty	Description
10	4	Crossbar with receiver
11	16	Medium screw, 5/16"-18 x 1-1/2" (4 per upright frame)

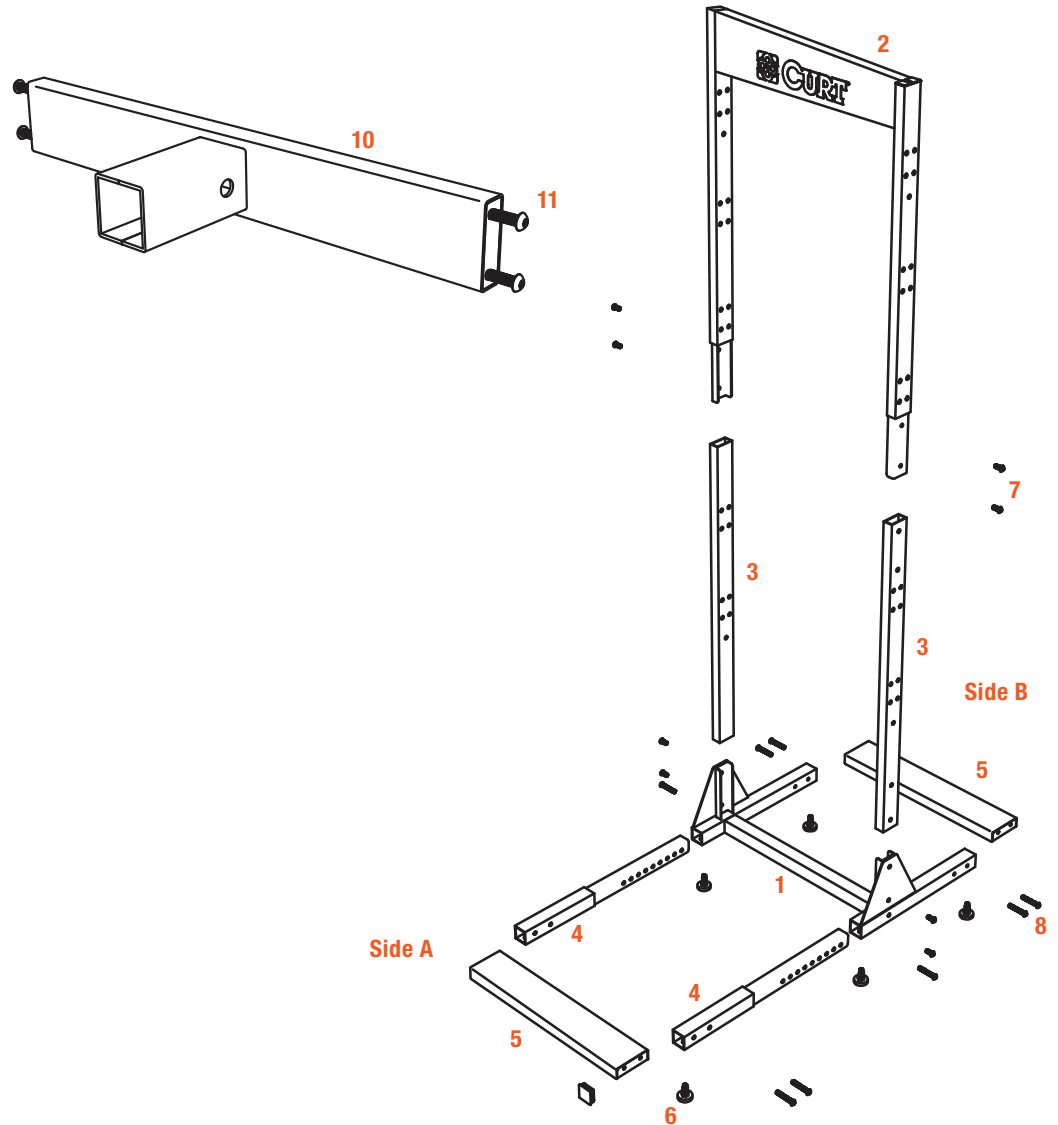

Step 1

Hold the base (#1) upside down and install four levelers (#6) to the outer corners.

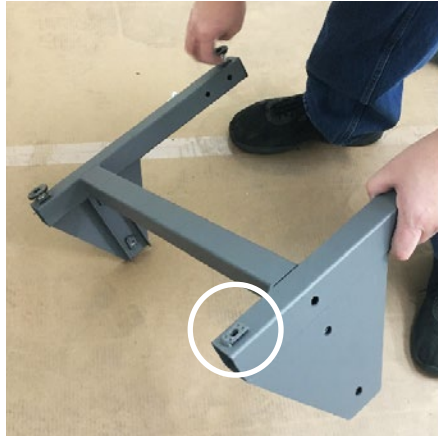

Step 2

Install the remaining levelers (#6) to the underside of the two extension tubes (#4).

Set aside for step 6.



Step 3

First, locate the floor brace beam (#5) with two threaded holes at each end.

Please note the threaded holes are not centered, as shown.

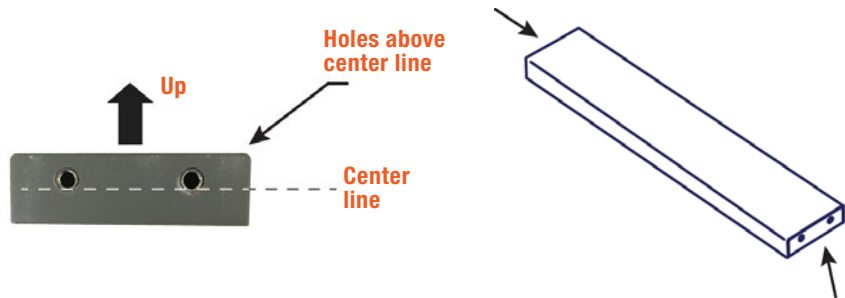

Step 4

Install the floor brace beam (#5) to the base (#1). Match the orientation of the threaded holes as shown. Secure at each end with two long screws (#8), using the included allen wrench (#9).

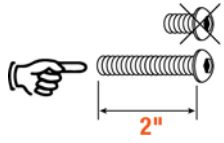

Install tip: Align the holes on the floor brace beam to the base. Look through to other side, and once light is visible through the holes, install one long screw on the left side then one on the opposite side. Insert the remaining two long screws.

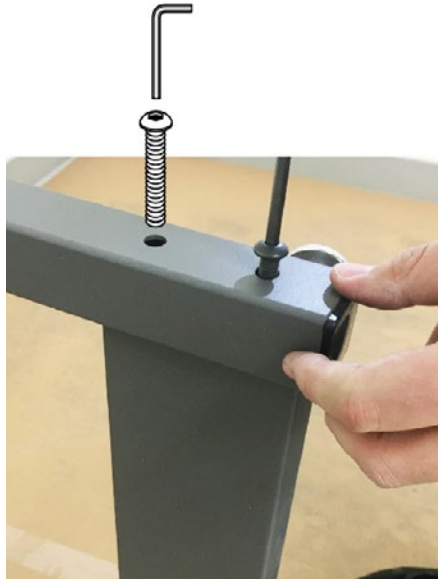

Step 5

Locate the two upright posts (#3).
The outer face will have more holes than the inner face.

Orient the tubes with the top edge facing up, matching the image shown to the right.

Install the upright posts to the base (#1). Secure from the sides of the base with two short screws (#7).

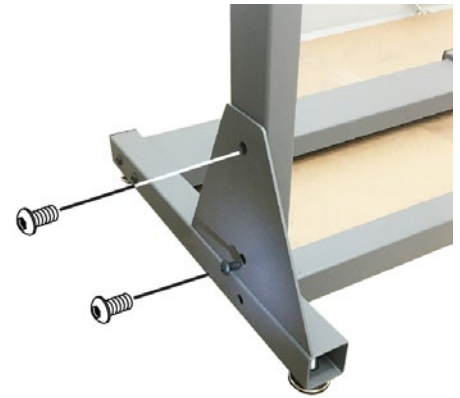
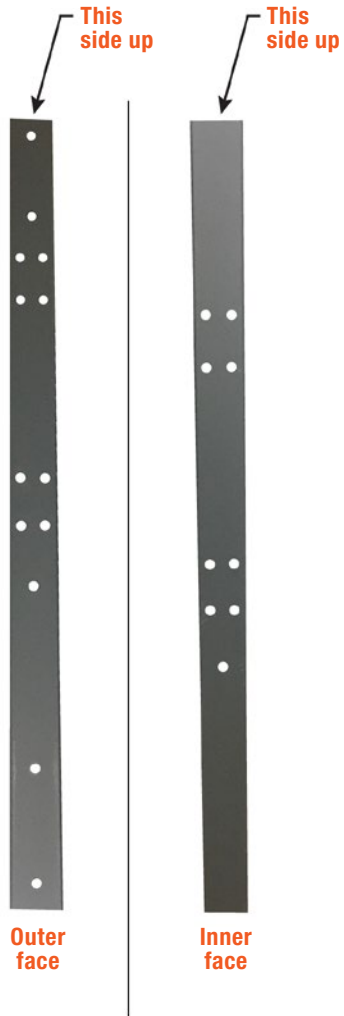

Step 6

Display can be adapted to accommodate various cargo carrier assortments by rotating the upright posts (#3) 180° vertically.

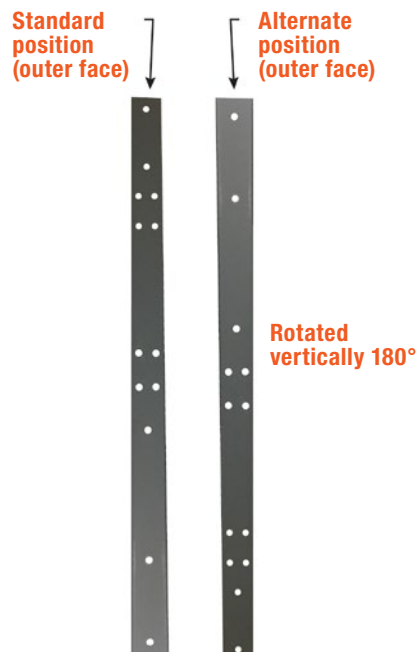

Step 7

Install the extension tubes (#4) to the base (#1). These tubes are designed to extend out at various increments and add increased stability.

NOTICE

For cargo carrier configuration, install extension tubes (#4) with 4-1/2 holes visible.

To lock the position of each tube, install one long screw (#8) at each location on the right and left side of the base.

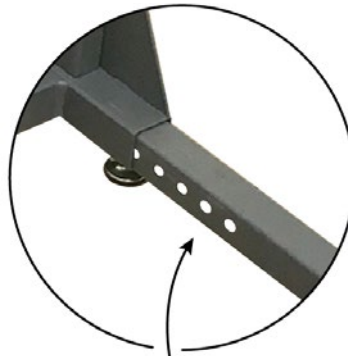

Hole spacing for adjustability

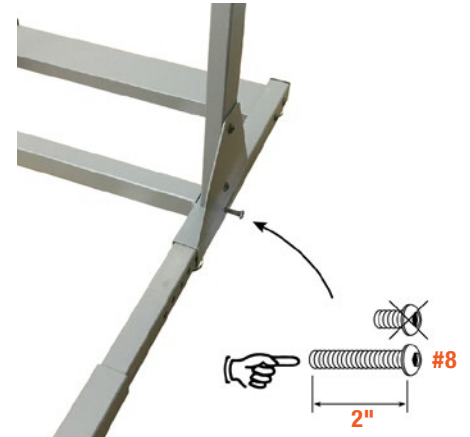

Step 8

Locate the floor brace beam (#5) with two threaded holes at each end.

Please note the threaded holes are not centered, as shown.

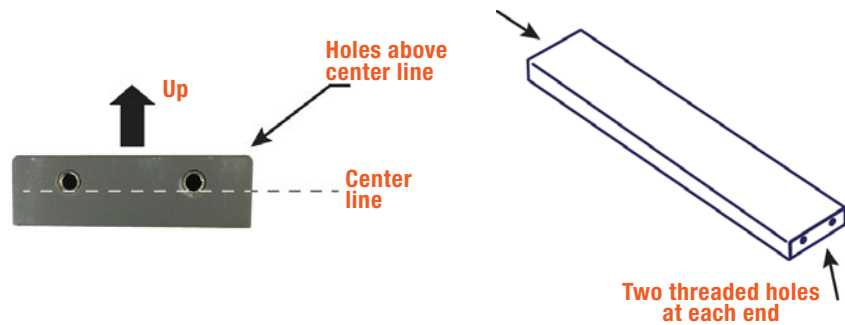

Step 9

Install the floor brace beam (#5) to the base (#1). Match the orientation of the threaded holes as shown. Secure at each end with two long screws (#8), using the included allen wrench (#9).

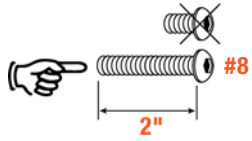

Install tip: Align the holes on the floor brace beam to the base. Look through to other side, and once light is visible through the holes, install one long screw on the left side then one on the opposite side. Insert the remaining two long screws.



Step 10

Carefully install the top frame (#2) over the upright posts (#3). Secure with two short screws (#7) at each of the upright posts on the right and left side.

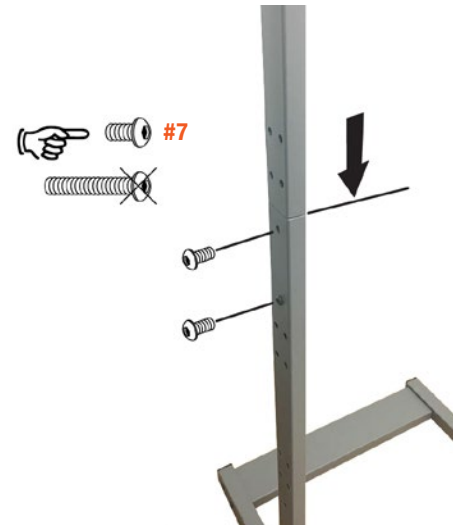

Step 11

Adjust the rear levelers (#6) so they are fully threaded into the base.

Adjust the front levelers (#6) so that the extension tubes (#4) are about 1" from the ground.

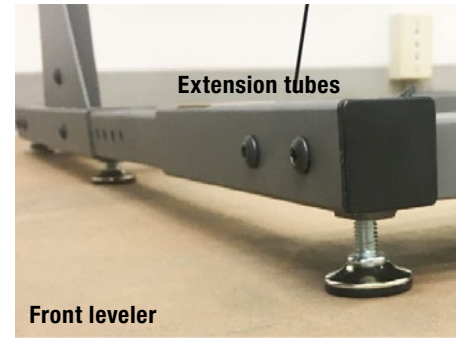
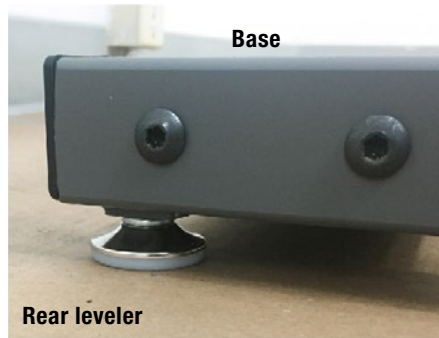

Step 12

Secure the crossbar with receiver (#10) to the frame of the display with two medium screws (#11). Do not fully tighten the screws.

Secure the other side of the receiver beam with two medium screws. Fully tighten all four screws.

NOTICE

The receiver beam can be installed to be either rear-facing or forward-facing.

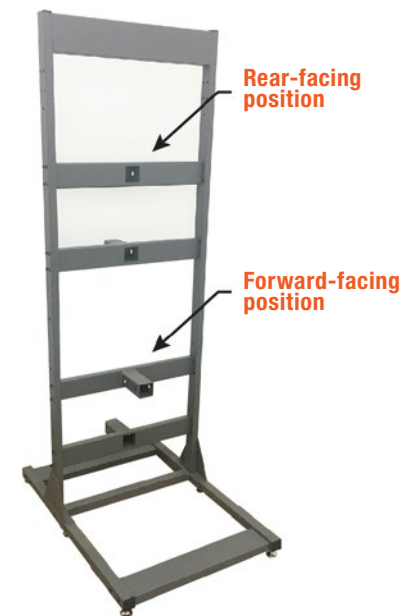
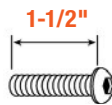
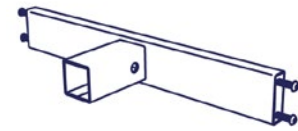

Step 13

CAUTION

Two people required for cargo carrier installation.

Carefully mount the cargo carrier to the receiver tube on the crossbar with receiver (#10).

Secure each cargo carrier with the heavy duty pin provided with the product.



Step 14

NOTICE

Adjust the levelers (#6) to make sure the unit tilts slightly back.

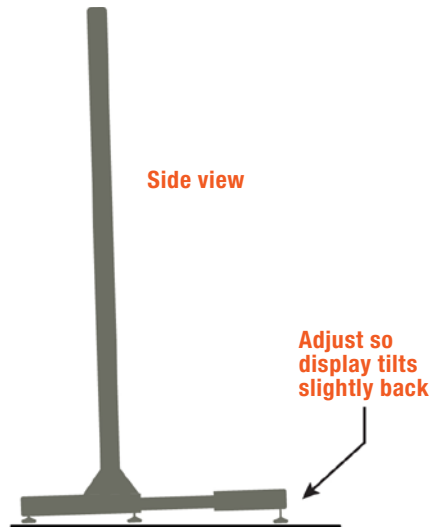



Additional
receiver-beams
for more carriers

Display product sold separately