



INSTALLATION MANUAL

BIKE RACK

Level of Difficulty

Easy

Parts List - Starter Kit

Item	Qty	Description
1	1	Base
2	1	Top frame
3	2	Upright post
4	2	Extension tube
5	2	Floor brace beam
6	6	Leveler, 5/16"-18 x 1"
7	8	Short screw, 5/16"-18 x 1/2"
8	10	Long screw, 5/16"-18 x 2"
9	1	Allen wrench, 3/16"

Parts List - Bike Rack Components

Item	Qty	Description
10	2	Crossbar with receiver
11	8	Medium screw, 5/16"-18 x 1-1/2" (four per upright frame)
12	2	Angled receiver
13	2	Short screw

Parts List - Banner Kit

Item	Qty	Description
14	2	Rod
15	1	Vinyl banner
16	4	Medium screw, 5/16"-18 x 1-1/2"
17	1	Allen wrench, 3/16"

NOTICE

Before you begin installation, read all instructions thoroughly.

Proper tools will improve the quality of installation and reduce the time required.

Display Photo (product not included)



⚠ CAUTION

Care must be taken to avoid damage or injury. Do not overload display.

This display-configuration is only authorized for use as follows:

- Two-sided product-presentation only. The display must have a CURT bike rack securely installed on both sides of the display at all times.
- Bike racks are only authorized for mounting in the lowest crossbar with receiver position.
- Tray-style bike racks are only authorized for installation on side B of the display and only when installed in conjunction with the leg extension kit (CURT part #99402).



ASSEMBLY

Parts List - Starter Kit

Item	Qty	Description
1	1	Base
2	1	Top frame
3	2	Upright post
4	2	Extension tube
5	2	Floor brace beam
6	6	Leveler, 5/16"-18 x 1"
7	8	Short screw, 5/16"-18 x 1/2"
8	10	Long screw, 5/16"-18 x 2"
9	1	Allen wrench, 3/16"

Parts List - Bike Rack Components

Item	Qty	Description
10	2	Crossbar with receiver
11	8	Medium screw, 5/16"-18 x 1-1/2" (four per upright frame)
12	2	Angled receiver
13	2	Short screw

Parts List - Banner Kit

Item	Qty	Description
14	2	Rod
15	1	Vinyl banner
16	4	Medium screw, 5/16"-18 x 1-1/2"
17	1	Allen wrench, 3/16"

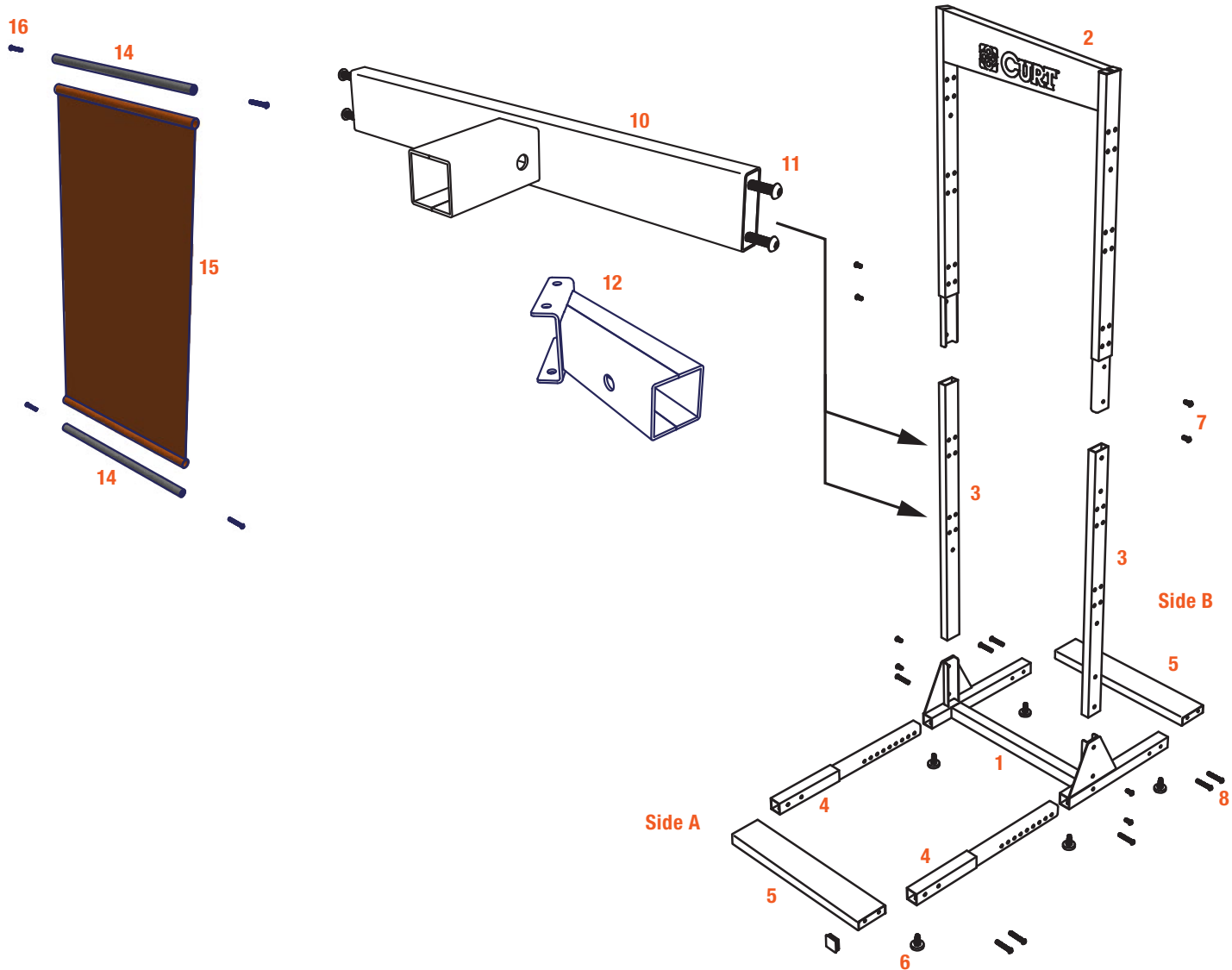

Step 1

Hold the base (#1) upside down and install four levelers (#6) to the outer corners.

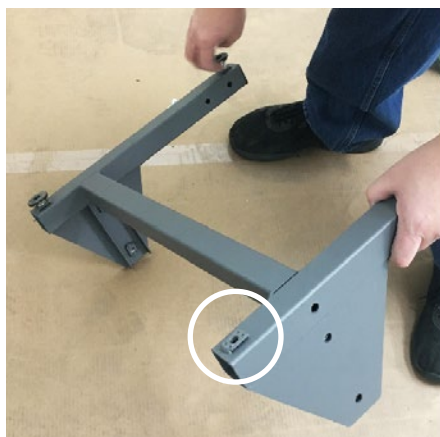

Step 2

Install the remaining levelers (#6) to the underside of the two extension tubes (#4).

Set aside for step 6.



Step 3

First, locate the floor brace beam (#5) with two threaded holes at each end.

Please note the threaded holes are not centered, as shown.

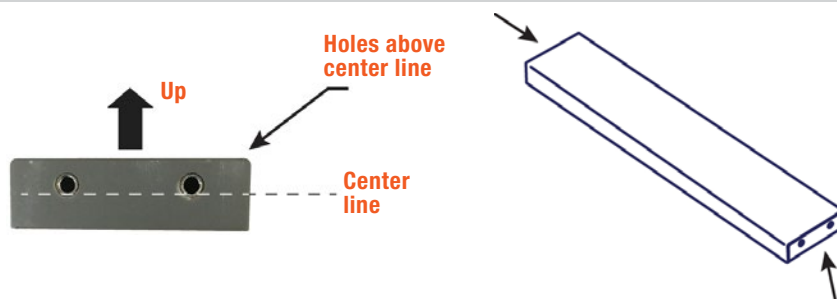

Step 4

Install the floor brace beam (#5) to the base (#1). Match the orientation of the threaded holes as shown. Secure at each end with two long screws (#8), using the included allen wrench (#9).

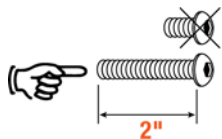

Install tip: Align the holes on the floor brace beam to the base. Look through to other side, and once light is visible through the holes, install one long screw on the left side then one on the opposite side. Insert the remaining two long screws.

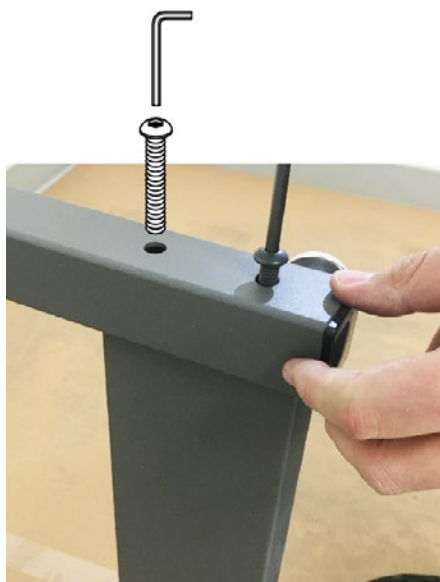
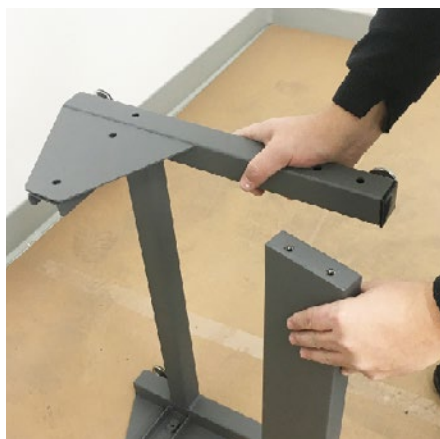

Step 5

Locate the two upright posts (#3).
The outer face will have more holes
than the inner face.

Orient the tubes with the top edge facing
up, matching the image shown to the right.

Install the upright posts to the
base (#1). Secure from the sides of
the base with two short screws (#7).

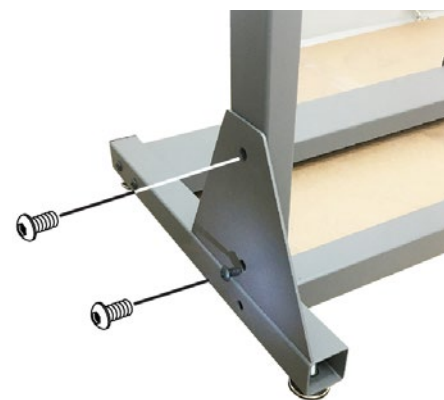
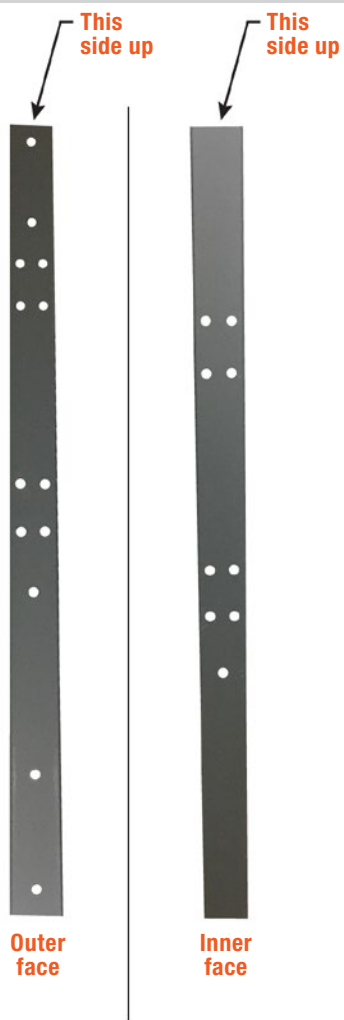

Step 7

Install the extension tubes (#4) to the base (#1). These tubes are designed to extend out at various increments and add increased stability.

NOTICE

For bike rack configuration, install extension tubes (#4) with 4-1/2 holes visible.

To lock the position of each tube, install one long screw (#8) at each location on the right and left side of the base.

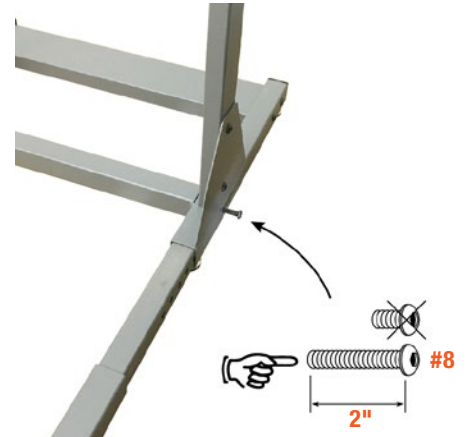
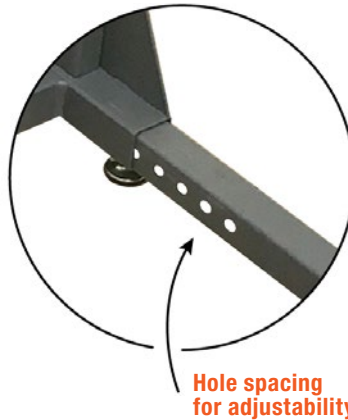

Step 7

Carefully install the top frame (#2) over the upright posts (#3). Secure with two short screws (#7) at each of the upright posts on the right and left side.

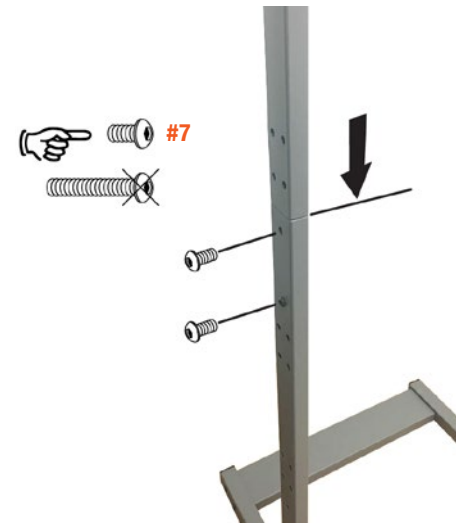

Step 8

Locate the floor brace beam (#5) with two threaded holes at each end.

Please note the threaded holes are not centered, as shown.

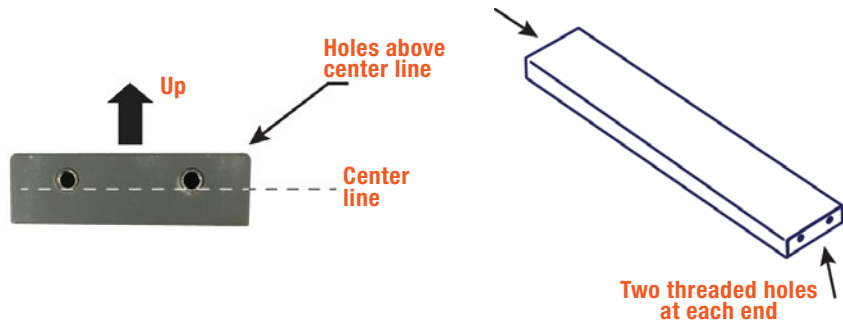

Step 9

Install the floor brace beam (#5) to the base (#1). Match the orientation of the threaded holes as shown. Secure at each end with two long screws (#8), using the included allen wrench (#9).

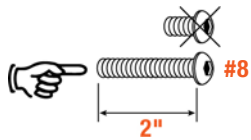

Install tip: Align the holes on the floor brace beam to the base. Look through to other side, and once light is visible through the holes, install one long screw on the left side then one on the opposite side. Insert the remaining two long screws.



Step 10

Install the rods (#15) to both sleeves of the vinyl banner (#16).



Step 11

Attach the banner (#15) to the centered holes of the outer faces of the top frame (#2).

Secure the banner to the centered holes of the outer faces of the lower upright post (#3) using the long screws (#8).

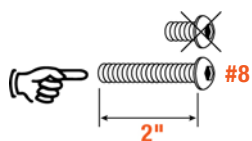

Reference the bottom photo to the right for correct orientation of the banner graphic.



Front side graphic

Step 12

NOTICE

Banner removed from photos.

Refer to the exploded view on page 1 to determine the location of the crossbar with receiver (#10) on the display. Next, install the crossbar with receiver to the inner face of the assembled display. Secure at each side with two medium screws (#11).

Do not fully tighten the screws until after all receiver beams are in place.

Install the second crossbar with receiver so that they are back-to-back on the display.

CAUTION

Bike racks vary and so do their weights and centers of gravity. Care must be taken in choosing how many hitches to display and heights to mount at. Generally, wider and heavier products should be mounted closest to the ground.

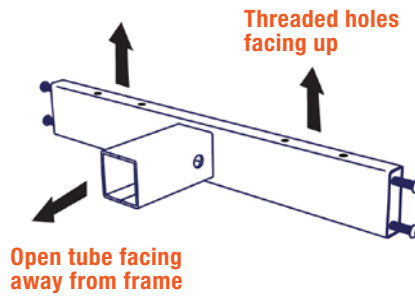

Step 13

Install the angled receiver (#12) to the front-facing crossbar with receiver (#10).



Step 14

Install a bike rack into each angled receiver (#12).

Secure each bike rack with the heavy duty pin provided with the product.



Final Installed Image

Side A



Side B



Display product sold separately