

INSTALLATION MANUAL

70147

Level of Difficulty

Moderate

Installation difficulty levels are based on time and effort involved and may vary depending on the installer level of expertise, condition of the vehicle and proper tools and equipment.

Installed Attachment Tabs

Height	19.5"
Width	30.5"

Parts List

Item	Qty	Description
1	2	Tow bar base plate
2	2	Tow bar mounting plate
3	2	Tow bar mounting tab
4	2	Safety cable, 7,500 lbs.
5	4	Hex bolt, 1/2"-13 UNC, 1-1/2", grade 8
6	4	Lock washer, 1/2"
7	4	Flat washer, 1/2"
8	4	Nylock nut, 1/2"-13 UNC, grade 8
9	4	Hex bolt, 7/16"-14 UNC, 1-1/2", grade 8
10	4	Serrated flange nut, 7/16"-14, grade 8
11	4	Flat washer, 7/16"
12	4	Fishwire, 7/16"
13	2	Quick link, 1/2"
14	2	Caplugs # dop-1375

Tools Required

Socket, 8mm	Socket extension
Socket, 10mm	Ratchet
Socket, 15mm	Torque wrench
Socket, 18mm	Paint marker
Socket, 11/16"	Safety glasses
Socket, 3/4"	Flathead screwdriver
Wrench, 18mm	Phillips screwdriver
Wrench, 11/16"	Angle grinder with cutoff wheel
Wrench, 3/4"	

⚠ WARNING

Never exceed the vehicle manufacturer's recommended towing capacity.

Product Photo



⚠ CAUTION

Take care when cutting any plastic or metal as injury may occur if done improperly.

NOTICE

Visit www.curtmfg.com for a full-color copy of this instruction manual, as well as helpful videos, guides and much more!

Before you begin installation, read all instructions thoroughly.

Proper tools will improve the quality of installation and reduce the time required.

This installation requires:

- Remove recovery loops / D-rings (Permanent)
- Remove bumper (Temporarily)
- Remove skid shield (Temporarily)
- Trimming is required.

Periodic inspection of your product should be performed to ensure all hardware and / or components remain secure.

To help prevent damage to the product or vehicle, refer to the specified torque specifications when securing hardware during the installation process.

Product Registration and Warranty

CURT stands behind our products with industry-leading warranties. To get copies of the product warranties, register your purchase or provide feedback, visit: warranty.curtgroup.com/surveys

ASSEMBLY

Parts List

Item	Qty	Description
1	2	Tow bar base plate
2	2	Tow bar mounting plate
3	2	Tow bar mounting tab
4	2	Safety cable, 7,500 lbs.
5	4	Hex bolt, 1/2"-13 UNC, 1-1/2", grade 8
6	4	Lock washer, 1/2"
7	4	Flat washer, 1/2"
8	4	Nylock nut, 1/2"-13 UNC, grade 8
9	4	Hex bolt, 7/16"-14 UNC, 1-1/2", grade 8
10	4	Serrated flange nut, 7/16"-14, grade 8
11	4	Flat washer, 7/16"
12	4	Fishwire, 7/16"
13	2	Quick link, 1/2"
14	2	Caplugs # dop-1375

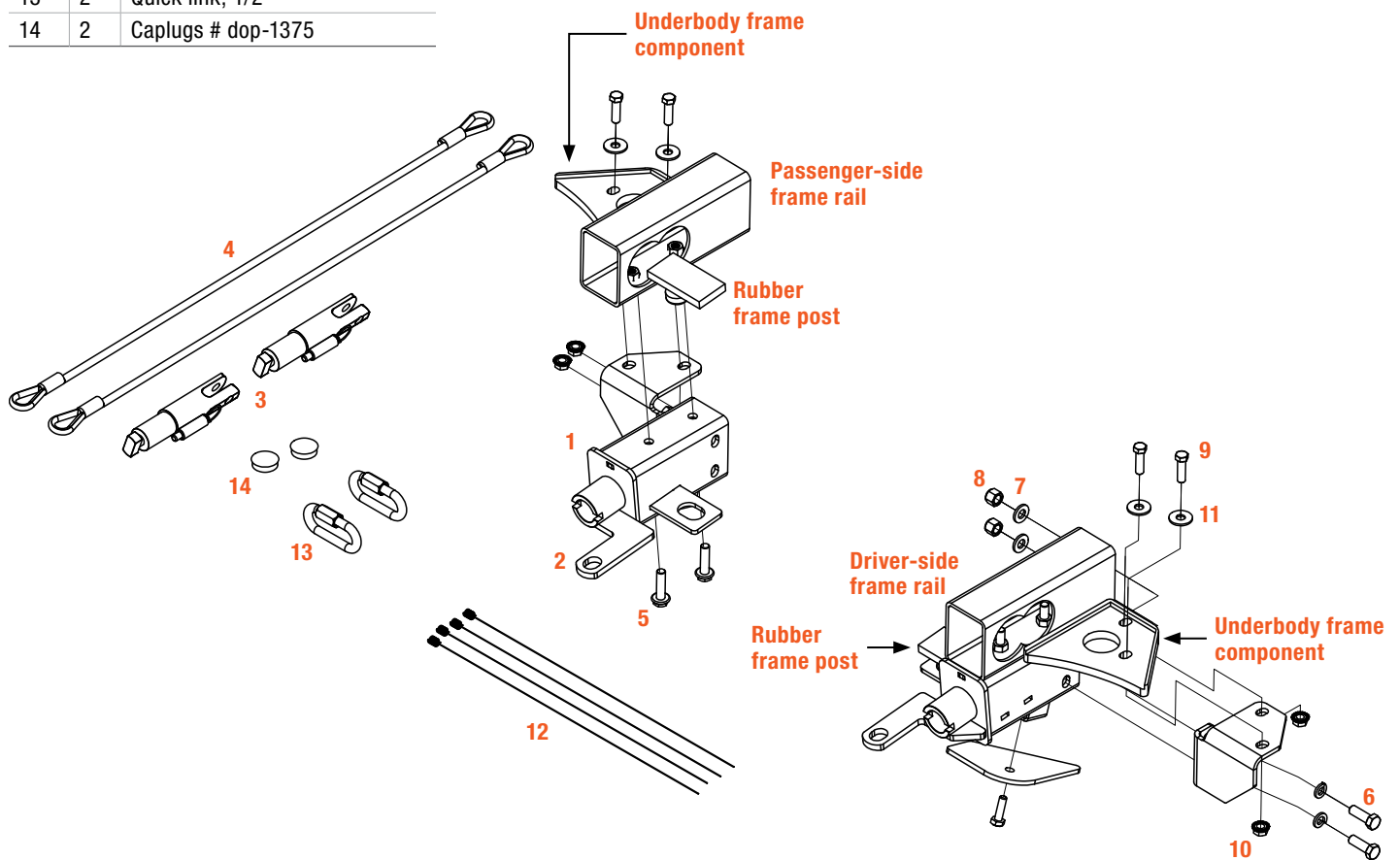

FISHWIRE TECHNIQUE

Insert coiled end of fishwire tool through hitch mounting hole in vehicle frame rail and out the access hole. Pass coiled end of fishwire through spacer and thread bolt into coil. Kink wire to keep spacer separate from bolt as shown. Pull fishwire, spacer and bolt through frame and out mounting hole. Use fishwire to guide hitch during mounting and prevent loss of bolt or spacer inside frame rail.

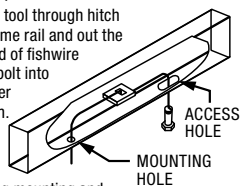

Step 1

Use a 15mm socket to remove three bolts from the skid plate from both sides of the vehicle (six total bolts). Remove the skid plate and save for possible reinstallation later.



Step 2

If the plastic part is present, pinch back area of the plastic shroud and remove from the tow hook on both sides of the vehicle.

Step 3

Use a 15mm socket to remove two bolts securing the tow hook to the frame. Do this on both sides of the vehicle and return tow hooks to owner.

Step 4

Install the base plates to the proper sides using the two existing bolts using a socket and socket extension. (Use base plate flange to properly install base plates on proper sides of the vehicle by making sure it lines up with rubber grommet extruding from frame of vehicle.)



Step 5

Secure the mounting bracket to the base plate using two supplied 1/2" x 1-1/2" hex bolts (#5) with lock washers (#6) and flat washers (#7) with nylock nuts (#8) on the inside of the base plate tube.

Do not fully tighten hardware at this time.

Repeat on the other side of the vehicle.



Step 6

Set up the supplied 7/16" x 1-1/2" fishwire by threading the 7/16" fishwire onto the 7/16" hex bolt (#9). Attach the 7/16" flat washer (#11) onto the fishwire on the bolt.

Insert the fishwire into the access hole (big hole) of the frame holding the bolt and washer side in your hand. Feed the fishwire into the mounting hole and once you grab the fishwire on the mounting hole side, begin pulling the bolt through the access hole through the mounting hole.

Note: Loosening the top bolt from the base plate may make it easier to feed the fishwire through the mounting hole.



Step 7

Torque all 7/16" hardware to 59 ft-lbs.

Torque all 1/2" hardware to 90 ft-lbs.

Secure the base plate safety cables and quick links provided.



Step 8

Hold skid plate close to its original position and mark with tape or paint marker and trim skid plate as needed for proper fit using an angle grinder and cut off wheel.

SAFETY CABLE INSTALLATION

Installing the Permanent Base Plate Safety Cables

When dinghy towing a vehicle with a tow bar, base plate safety cables should be used at all times. In the event of a disconnect, the safety cables are designed to help prevent complete vehicle separation. When installing the safety cables, use the illustrations below as a guide.

Installation guidelines

1. The cables must be connected to the base plate and the vehicle frame.
2. Two cables must be installed.
3. Each cable must meet or exceed the gross weight of the towed vehicle.
4. Make sure cables do not pinch or interfere with hoses, wiring or other components.

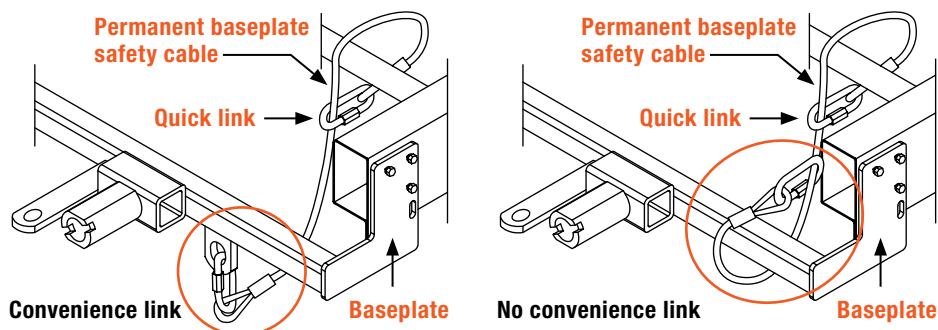

Note: Base plate safety cables are not a replacement for safety chains connecting the tow vehicle to the towed vehicle.

ADDITIONAL INFORMATION

Towing Tips

Check your equipment

Periodically check the condition of all towing equipment. Ensure all fasteners are tight and that all structural components are sound. Do not tow with worn or damaged parts.

Towing vehicle and trailer manufacturer's recommendations

Review the owner's manual for your towing vehicle and trailer for specific recommendations, capacities and requirements.