

INSTALLATION INSTRUCTIONS

⚠ WARNING: DO NOT EXCEED PRODUCT RATING OR TOW VEHICLE LAMP LOAD RATING, WHICHEVER IS LOWER

APPLICATIONS

Make	Model
Ford	Focus hatchback

CUSTOM WIRING HARNESS

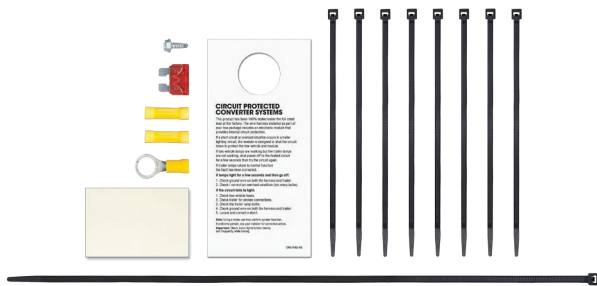
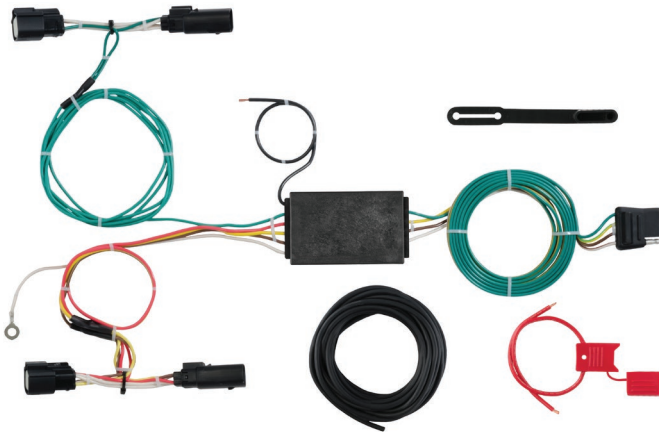

WIRING LOCATION GUIDE

PASSENGER CARS (P)

Representative vehicle shown below

P1 - Behind driver side taillight housing, outside of trunk

P2 - Behind passenger side taillight housing, outside of trunk



NOTICE

All steps must be followed to ensure the wiring harness will function properly. Once installed, test for proper function by using a test light or connecting a properly wired trailer.

TOOLS NEEDED

10mm socket
1/4" socket
T-20 Torx bit
Ratchet

Panel trim removal tool
Crimping tool
Wire cutters
Cutting tool

⚠ WARNING

The battery connection must be fuse-protected, 10-amp max. Exceeding the product rating can cause loss of warranty, overheating and potential fire. Do not exceed product rating or tow vehicle lamp load rating, whichever is lower.

Signal Circuits - 3.0 amps per side

Tail / Running Circuits - 6.0 amps total

Check vehicle owner's manual or contact the vehicle manufacturer for more information.

INSTALLATION / SAFETY INSTRUCTIONS

Step 1

Locate vehicle battery on the driver side under the hood and disconnect the negative battery terminal (A).

Step 2

Open the vehicle tailgate. Remove all trunk floor coverings and storage trays (B).

Step 3

Remove the push fasteners securing the rear scuff panel (C). Remove the scuff panel by pulling out on the bottom and then up taking care not to damage the alignment tabs on the back.

Step 4

Starting on the driver side, remove the two fasteners securing the side trim panel (D). Pull back on the side trim panel to access the taillight assembly fasteners and remove them (E). Remove the taillight assembly by gently pulling rearward and out.

Step 5

Behind the taillight, locate the vehicle taillight wiring harness connectors (F). The connectors will be similar to those on the custom wiring harness. Separate the connectors from the taillight housing taking care not to damage the locking tabs. Set the taillight aside.

Step 6

Behind the taillight, remove the grommet with wires running from the inside of the trunk to the taillight (G). Make a small slit in the grommet large enough to route the wiring harness wires through.

Step 7

Route the wiring harness end with the yellow wire out through the grommet opening and through the slit in the grommet. Insert the wiring harness end with yellow wire between the separated connectors. Make sure the connectors are fully inserted with locking tabs in place (H).

Step 8

Seat the grommet with the wiring harness wires passing through. Use a sealant (not included) to seal grommet where the wires pass through and where grommet was cut.

 **WARNING:** Check for miscellaneous items that may be hidden behind or under any surface before drilling to avoid damage and / or personal injury.

Step 9

Locate a suitable grounding point near the connector such as an existing screw with nut in the vehicle frame or drill a 3/32" pilot hole for the provided screw. The area should be free of rust, dirt and paint. Secure white ground wire using ring terminal and provided screw.

Step 10

Locate a flat spot inside the vehicle, near the taillight. Adhere the black converter box using the provided double-sided tape (I).

Step 11

Route the CURT wiring harness end with the green wire to the passenger side behind the removed scuff panels. Repeat steps 4-8 on the passenger side using the harness end with the green wire.

Step 12

Route the black power wire from the vehicle battery as shown on the included CME-PCL-INS sheet.

Step 13

When in use, route the 4-flat to the center of the vehicle and out of the trunk. When not in use, roll up and store in a convenient, out of the way location inside the trunk. Secure any loose wires with the provided cable ties.

Step 14

Reinstall all items removed during install and reconnect negative battery terminal. Install the provided 4-flat dust cover to help prevent corrosion.

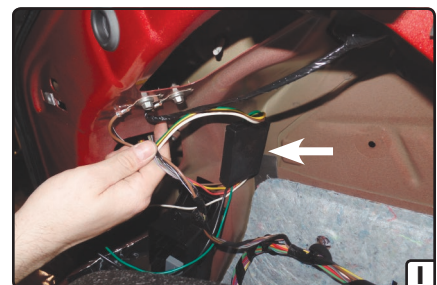
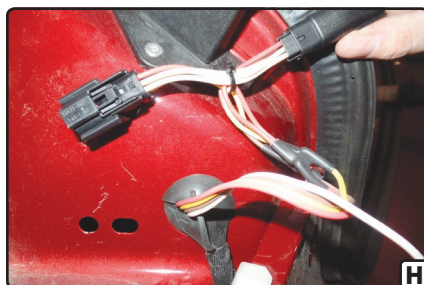
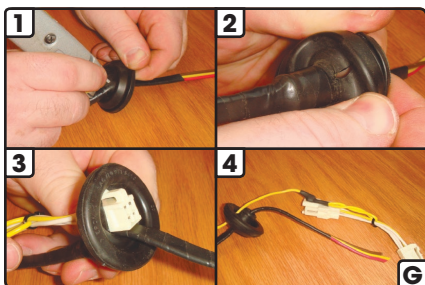

POWERED CONVERTER LEAD INSTRUCTION SHEET

FICHE DE CONSIGNES DU CONVERTISSEUR D'ALIMENTATION

HOJA DE INSTRUCCIONES DEL CONDUCTOR DEL ADAPTADOR ALIMENTADO POR BATERÍA

NOTICE AVIS / AVISO

Illustrations are for reference only. Battery location may differ depending on the vehicle.

Les images ne sont fournies qu'à des fins de référence. L'emplacement de la batterie peut varier en fonction du véhicule.

Las ilustraciones son solo para referencia. La ubicación de la batería puede variar según el vehículo.

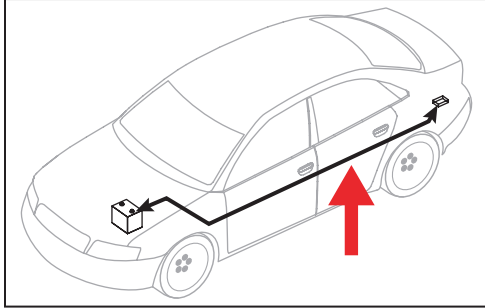

WARNING AVERTISSEMENT / ADVERTENCIA

Route 12 GA wire to vehicle battery location, taking care to avoid any pinch points and hot or rotating components.

Acheminer le câble de calibre 12 à la batterie du véhicule en prenant soin d'éviter les points de pincement et les éléments chauds ou pivotants.

Pase el cable calibre 12 hacia la ubicación de la batería del vehículo, con cuidado de evitar atascos y componentes calientes o giratorios.

WARNING AVERTISSEMENT / ADVERTENCIA

To avoid personal injury or property damage, check for miscellaneous items that may be behind or under any surface before drilling.

Pour éviter les blessures et les dommages matériels, vérifier les divers articles qui peuvent se trouver derrière ou sous la surface avant de percer.

Para evitar lesiones personales o daños materiales, verifique que no haya ningún elemento detrás o debajo de la superficie antes de perforar.

NOTICE AVIS / AVISO

1. This converter system is to be used only on 12 volt negative ground systems.
2. Secure power wire to vehicle chassis using cable ties provided.
3. When passing the power wire through sheet metal, use an existing grommet, add a grommet or use silicone to protect the power wire from sharp edges.
4. Overall T-connector design may differ from illustration. The illustration should be used for power lead instruction only. Illustration is not to scale.

1. Ce système de convertisseur ne doit être utilisé qu'avec une prise de masse de polarité négative de 12 volts.
2. Fixer le câble d'alimentation au châssis du véhicule à l'aide des courroies d'attache de câble fournies.
3. Utiliser un œillet existant, ajouter un œillet ou appliquer du silicone pour protéger le câble d'alimentation des rebords tranchants au moment de le passer à travers la tôle.
4. La disposition générale du connecteur en T peut différer de l'illustration. Celle-ci ne doit être utilisée que pour le convertisseur d'alimentation. L'illustration n'est pas à l'échelle.

1. Este sistema de adaptadores solo se debe utilizar con sistemas con polo negativo a masa de 12 voltios.
2. Sujete el cable de alimentación al chasis del vehículo utilizando los sujetacables suministrados.
3. Al pasar el cable de alimentación por la lámina de metal, utilice la arandela pasacable existente, agregue una arandela pasacable o utilice silicona para proteger el cable de alimentación de los bordes filosos.
4. El diseño general del conector T puede ser distinto de la ilustración. La ilustración solo se debe utilizar para la instrucción del conductor de alimentación. La ilustración no está a escala.

