

56212 SCION FR-S SUBARU BRZ

WIRING LOCATION GUIDE GUÍA DE UBICACIÓN DEL CABLEADO IDE D'EMPLACEMENT DES FILS

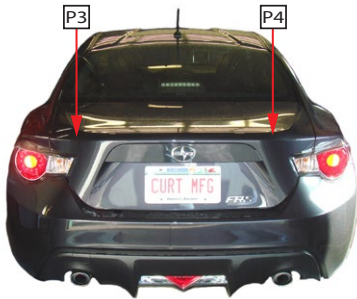

MUST READ FIRST!

All steps must be followed to ensure correct function of the T-Connector. To verify proper installation once installed, test by connecting a test light or properly wired trailer.

¡DEBE LEERSE PRIMERO!

Debe seguirse todos los pasos para asegurar el correcto funcionamiento del Conector-T. Para verificar la correcta instalación, pruebe conectando una luz de prueba o un remolque debidamente cableado.

À LIRE D'ABORD!

Pour assurer le bon fonctionnement du T-Connector, il faut suivre toutes les étapes. Pour vérifier que l'installation a été bien effectuée, branchez un feu de test ou une remorque correctement filéée.

01/06/2014

English

1. Access the vehicle's wiring harness connectors in the trunk behind the taillight in positions P3 and P4 as shown in the Wiring Location Guide.
2. Locate the vehicle's battery on the passenger's side under the hood and disconnect the negative battery terminal.
3. Open the trunk. Remove all trunk floor coverings (A). Remove the three plastic push fasteners located on the rear scuff panel (B). Remove the scuff panel by pulling out on the bottom and then up (C).
4. Remove the three plastic push fasteners located on each side of the trunk that holds the felt trunk liner in place (D).
5. Starting on the passenger's side pull back on the felt trunk liner to locate the vehicle's taillight wiring harness connectors (E). The connectors will be similar to those on the T-Connector harness. Separate the connectors from the taillight housing taking care not to damage the locking tabs (F).

6. Insert the T-Connector end with the green wire between the separated connectors (G). Make sure the connectors are fully inserted with locking tabs in place.

WARNING!

Verify miscellaneous items that may be hidden behind or under any surface before drilling to avoid damage and/or personal injury.

7. Locate a suitable grounding point near the connector such as an existing screw with nut in the vehicle's frame or drill a 3/32" pilot hole for the provided screw. The area should be free of rust, dirt or paint. Secure the white ground wire using the ring terminal and screw provided.

8. Route the black power wire from the battery as shown on the CME-PCL-INS sheet (included).
9. Route the T-Connector end with the yellow wire to the driver's side behind the felt trunk liner and removed scuff panel. Repeat Steps 5 & 6 on the driver side using the T-Connector end with the yellow wire (H). Use the provided cable ties to secure any loose wires.
10. Inside the vehicle, locate a flat spot and adhere the black converter box using the double-sided tape provided (I).

11. Route the 4-flat wire to the center of the vehicle when in use. When not in use roll up and store in a convenient, out of the way location.
12. Reinstall all items removed during install.
13. Connect negative battery terminal.

IMPORTANT!

The battery connection must be fuse protected, 10 amp max. Exceeding the product rating can cause loss of warranty, overheating and potential fire. Do not exceed the tow vehicle's lamp load rating or the product rating, whichever is lower:

Signal Circuits - 3.0 amps per side

Tail/Running Circuits - 6.0 amps total

Check vehicle owner's manual or contact the vehicle manufacturer for more information.

INSTALLATION QUESTIONS? CALL TECHNICAL SUPPORT AT 1-800-798-0813

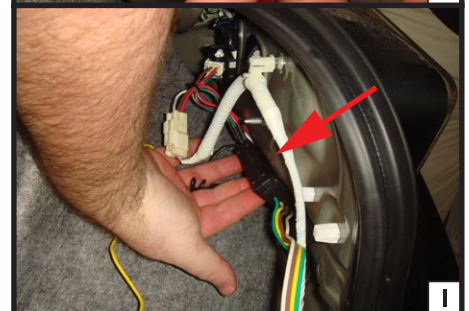
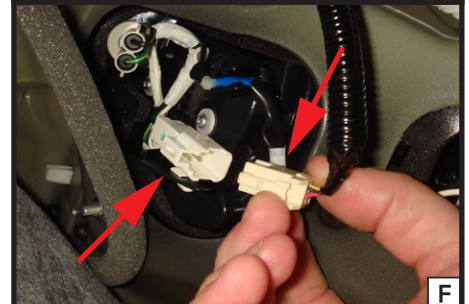
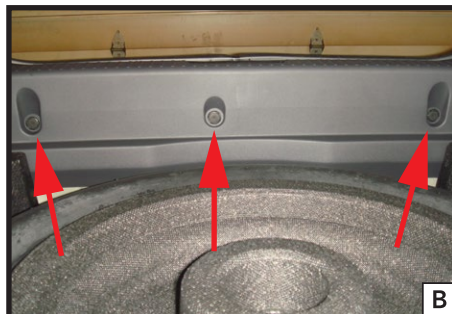
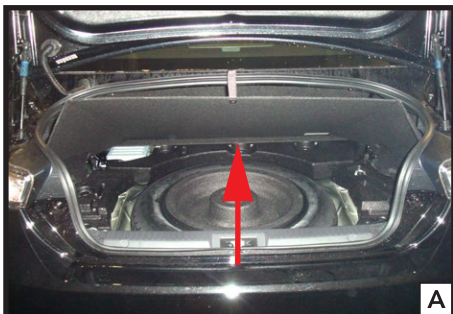

PACKAGE CONTENTS

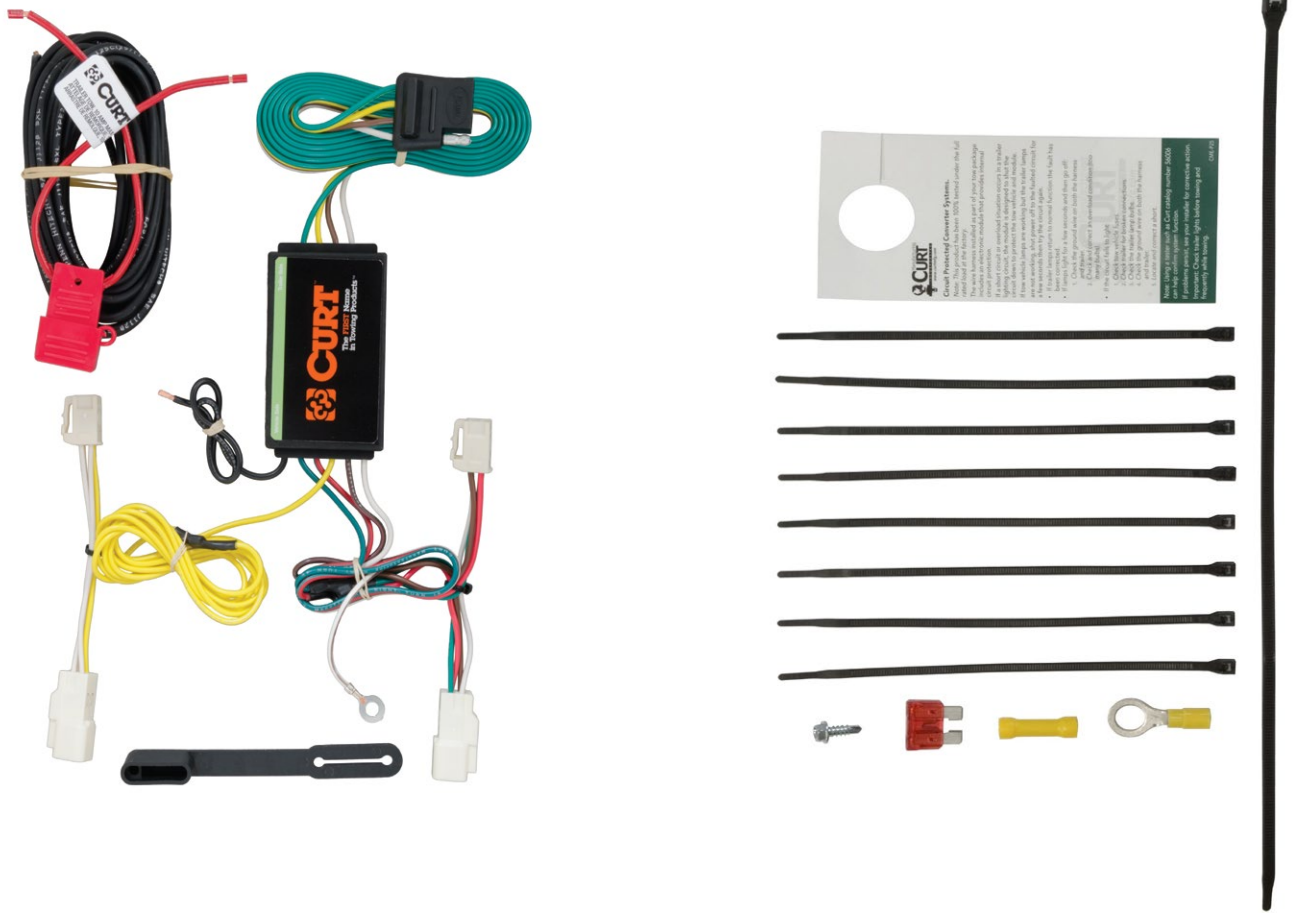

4-FLAT OEM TYPE REPLACEMENT W/INSTALL KIT