

INSTALLATION MANUAL

19107

Level of Difficulty

Easy

Installation difficulty levels are based on time and effort involved and may vary depending on the installer level of expertise, condition of the vehicle and proper tools and equipment.

Parts List

Item	Qty	Description
1	1	Locking handle
2	1	Shoulder bolt, M6
3	1	Hex bolt, M8
4	1	Nylock nut, M6
5	1	Nylock nut, M8
6	2	Nylon flat washer

Tools Required

Allen key, 4mm	--
----------------	----

Product Registration and Warranty

CURT stands behind our products with industry-leading warranties. To get copies of the product warranties, register your purchase or provide feedback, visit: warranty.curtgroup.com/surveys

WARNING

Never exceed the vehicle manufacturer's recommended towing capacity.

Product Photo

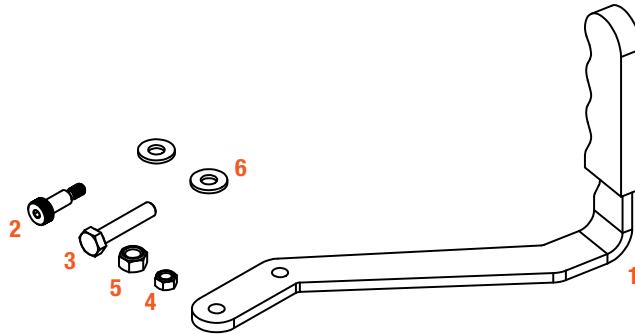

NOTICE

Visit www.curtmfg.com for a full-color copy of this instruction manual, as well as helpful videos, guides and much more!

Before you begin installation, read all instructions thoroughly.

Proper tools will improve the quality of installation and reduce the time required.

Periodic inspection of your product should be performed to ensure all hardware and / or components remain secure.

To help prevent damage to the product or vehicle, refer to the specified torque specifications when securing hardware during the installation process.

ASSEMBLY

Step 1

Unhook the locking bar spring in the center of the slider.

Align the upper mounting point with the mounting hole on the locking bar. Secure the handle to the locking bar using the M8 hex bolt and M8 nylon lock nut. Torque M8 hardware to 25 ft-lbs.

Insert one nylon flat washer on either side of the handle, aligning the lower mounting hole with the reset bracket. Secure using an M6 shoulder bolt and M6 nylon lock nut. Torque M6 hardware to 10 ft-lbs.

