

# INSTALLATION MANUAL

# 13652

## Level of Difficulty

Easy

Installation difficulty levels are based on time and effort involved and may vary depending on the installer level of expertise, condition of the vehicle and proper tools and equipment.

## Weight Carrying Capacity

Gross trailer weight (GTW) 4,500 lbs.

Tongue weight (TW) 675 lbs.

## Weight Distribution Capacity

Weight distribution (WD) 4,500 lbs.

WD tongue weight (WDTW) 675 lbs.

## Parts List

Item	Qty	Description
1	1	Trailer hitch
2	4	Hex bolt, M12 – 1.25 x 35mm, CL 10.9
3	4	Conical-toothed washer, 1/2"

## Tools Required

Ratchet	Socket extension, 8"
Socket, 12mm	Socket, 19mm
Torque wrench	Torque adapter, 19mm

\* For a tools reference guide visit [curtmfg.com/trailer-hitch-installation](http://curtmfg.com/trailer-hitch-installation)

## ⚠ WARNING

Never exceed the vehicle manufacturer's recommended towing capacity.

## Product Photo



## NOTICE

Visit [www.curtmfg.com](http://www.curtmfg.com) for a full-color copy of this instruction manual, as well as helpful videos, guides and much more!

Before you begin installation, read all instructions thoroughly.

Proper tools will improve the quality of installation and reduce the time required.

This installation requires:

- Existing weldnuts.
- No drilling required.

Periodic inspection of the trailer hitch should be performed to ensure all mounting hardware remains tight and structural components are secure.

To help prevent damage to the product or vehicle, refer to the specified torque specifications when securing hardware during the installation process.

## SAFETY INSTRUCTIONS

Safety glasses should be worn at all times while installing this product.

## Product Registration and Warranty

CURT stands behind our products with industry-leading warranties. To get copies of the product warranties, register your purchase or provide feedback, visit: [warranty.curtgroup.com/surveys](http://warranty.curtgroup.com/surveys)

# ASSEMBLY

## Parts List

Item	Qty	Description
1	1	Trailer hitch
2	4	Hex bolt, M12 – 1.25 x 35mm, CL 10.9
3	4	Conical-toothed washer, 1/2"

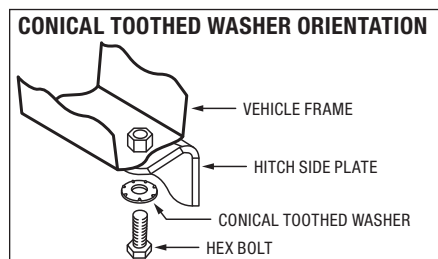
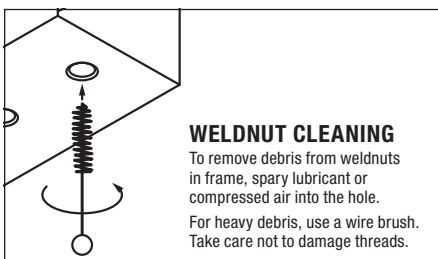
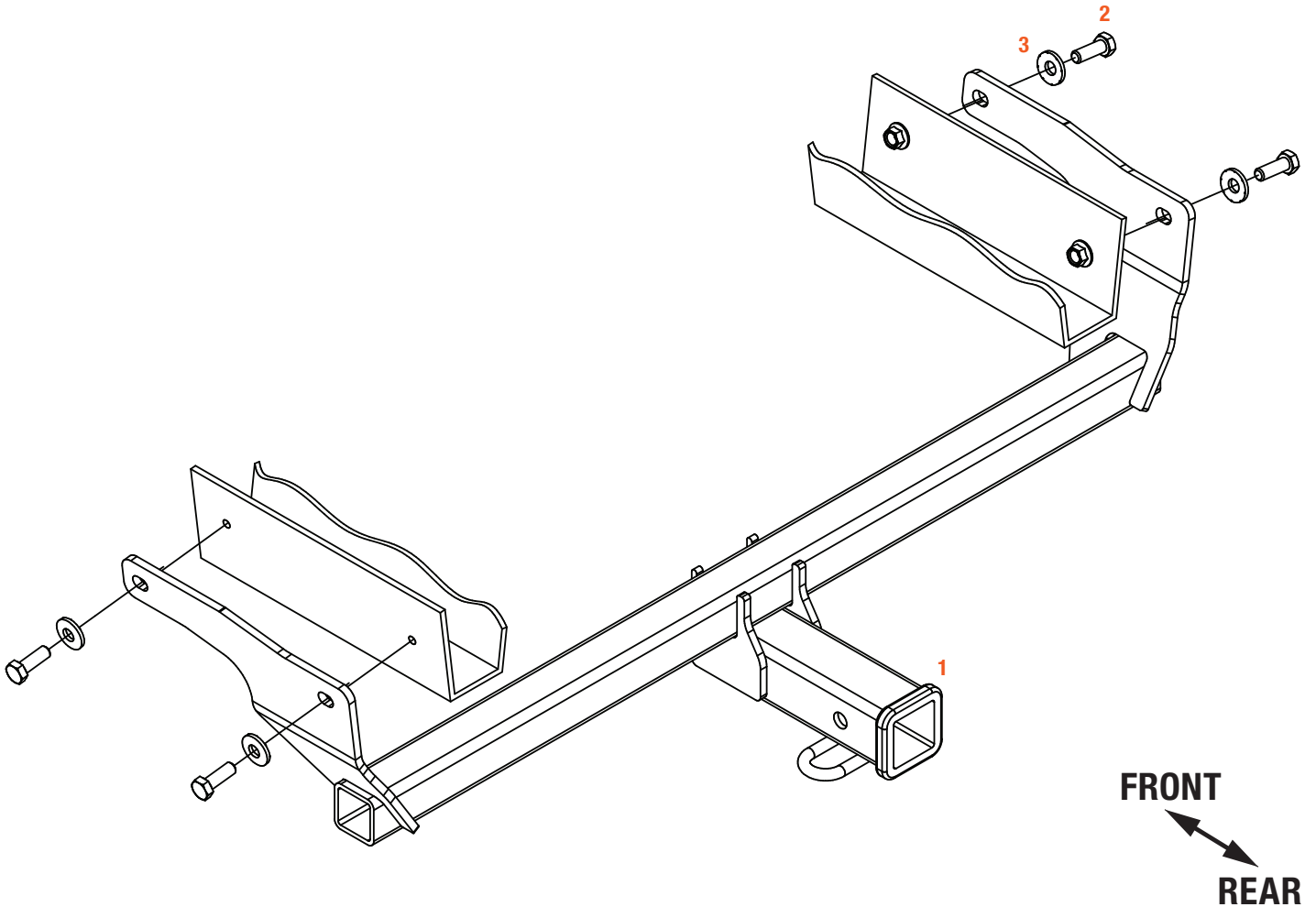

### Step 1

Remove stickers covering holes on outside of frame rails.



### Step 2

Raise hitch into position and loosely secure with supplied hardware.

**Note:** Lowering the exhaust using 12mm socket may ease installation on some models, be sure to support exhaust if lowering.



### Step 3

Torque M12 hardware to 86 ft-lbs.

**Note:** If heat shield is contacting hitch, bend the heat shield up to prevent rattling.



### Final Installed Image



### TOWING BASICS & SAFETY INFORMATION

For information on safely towing your trailer, visit [curtmfg.com/understanding-towing](https://www.curtmfg.com/understanding-towing).