



INSTALLATION MANUAL

13637

Level of Difficulty

Difficult

Installation difficulty levels are based on time and effort involved and may vary depending on the installer level of expertise, condition of the vehicle and proper tools and equipment.

Weight Carrying Capacity

Gross trailer weight (GTW)	3,500 lbs.
Tongue weight (TW)	525 lbs.

Parts List

Item	Qty	Description
1	1	Trailer hitch
2	6	Carriage bolt, 1/2" - 13 x 1.5", grade 8
3	6	Serrated-flange nut, 1/2" - 13
4	6	Fishwire, 1/2"

Tools Required

Ratchet	Torque wrench
Socket, 7mm	Socket, 8mm
Socket, 10mm	Socket, 13mm
Socket, 3/4"	Socket extension, 10"
Torx bit, T-30	Flathead screwdriver

* For a tools reference guide visit curtmfg.com/trailer-hitch-installation

Product Registration and Warranty

CURT stands behind our products with industry-leading warranties. To get copies of the product warranties, register your purchase or provide feedback, visit: warranty.curtgroup.com/surveys

⚠ WARNING

Never exceed the vehicle manufacturer's recommended towing capacity.

Product Photo



NOTICE

Visit www.curtmfg.com for a full-color copy of this instruction manual, as well as helpful videos, guides and much more!

Before you begin installation, read all instructions thoroughly.

Proper tools will improve the quality of installation and reduce the time required.

Periodic inspection of the trailer hitch should be performed to ensure all mounting hardware remains tight and structural components are secure.

To help prevent damage to the product or vehicle, refer to the specified torque specifications when securing hardware during the installation process.

SAFETY INSTRUCTIONS

Safety glasses should be worn at all times while installing this product.

ASSEMBLY

Parts List

Item	Qty	Description
1	1	Trailer hitch
2	6	Carriage bolt, 1/2" - 13 x 1.5", grade 8
3	6	Serrated-flange nut, 1/2" - 13
4	6	Fishwire, 1/2" (Not Shown)

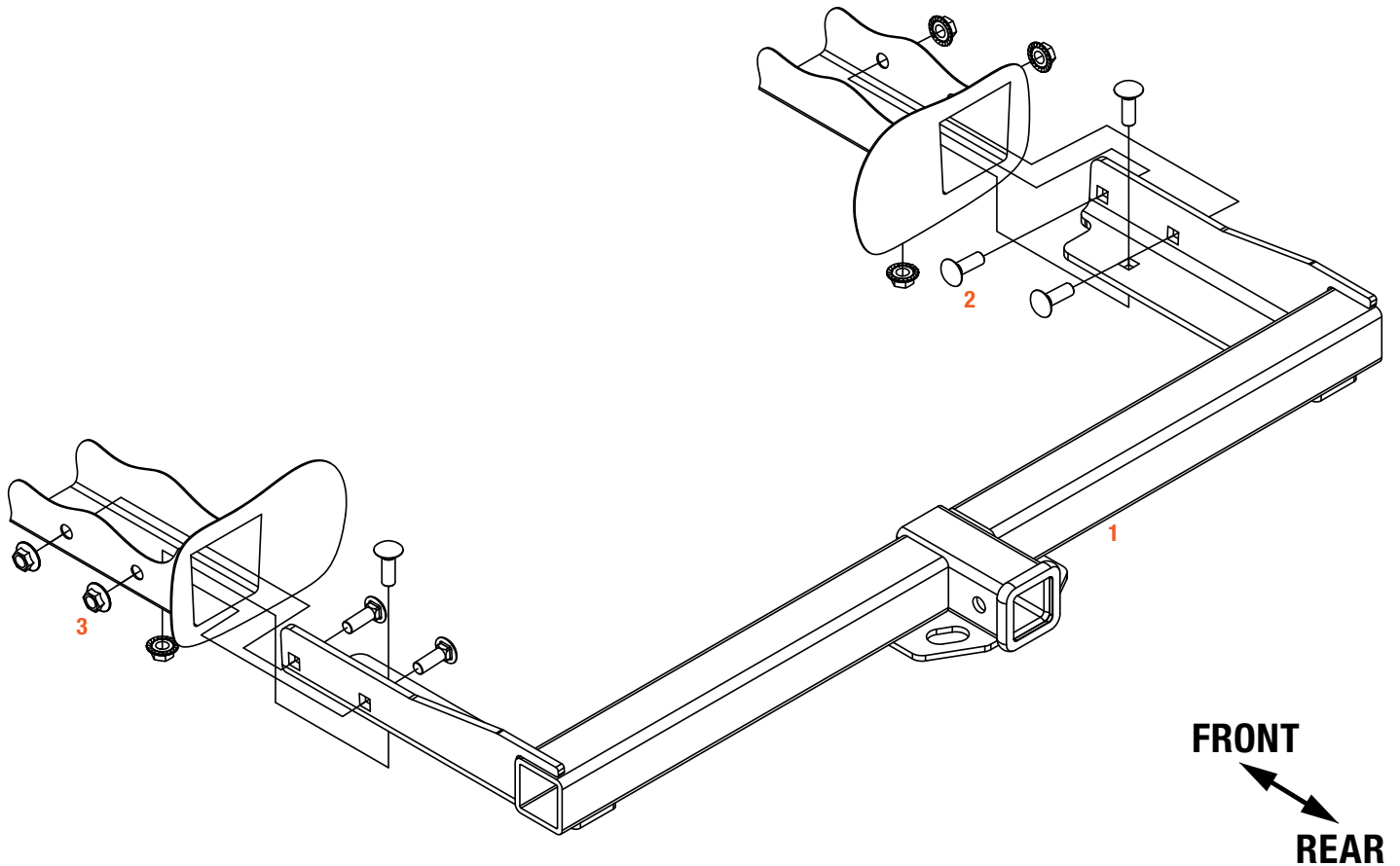

CONICAL TOOTHED WASHER ORIENTATION

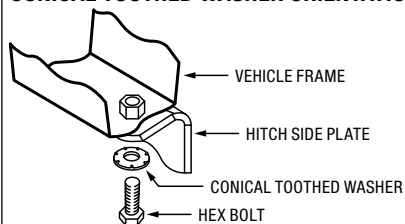

FISHWIRE TECHNIQUE

Insert coiled end of fishwire tool through hitch mounting hole in vehicle frame rail and out the access hole. Pass coiled end of fishwire through spacer and thread bolt into coil. Kink wire to keep spacer separate from bolt as shown. Pull fishwire, spacer and bolt through frame and out mounting hole. Use fishwire to guide hitch during mounting and prevent loss of bolt or spacer inside frame rail.

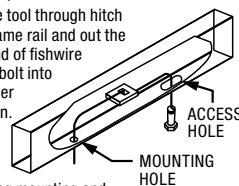

Step 1

Remove underbody panel by using an 8mm socket to remove five bolts from the bottom and removing two bolts from the rear of each wheel well liner starting from the bottom working up.

Remove three bolts from the middle of the panel using a 10mm socket.

Set panel and hardware aside for reinstallation.

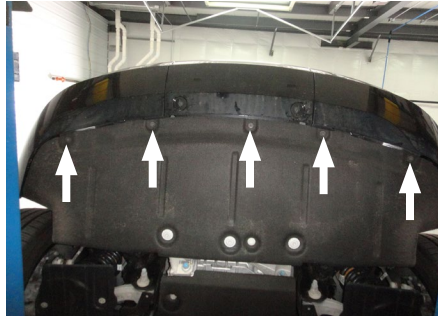

Step 2

Remove two bolts from the bottom of the bumper cover using a 8mm socket.

Remove four bolts from the rear of each wheel well liner starting from the bottom working up using an 8mm socket.

Remove one push fastener from behind each wheel well.

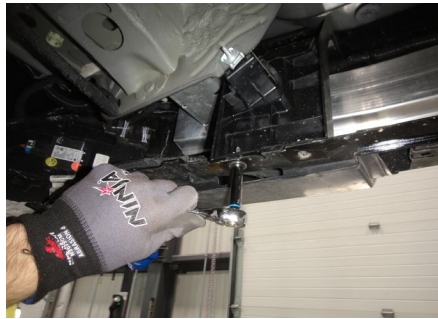

Step 3

Gently pull the wheel trim away from the vehicle starting at the bottom and working up.

Squeezing the clips behind the wheel liner may ease removal.

Remove newly exposed bolt using a 7mm socket.

Repeat on opposite side.



Step 4

Disconnect electrical connectors located behind the bumper cover to the rear of the rear tires by pulling the tab of the connector out then pushing it down.

Remove the clip holding the electrical harness to the end of the trunk pan.



Step 5

With the rear lift gate open use a T30 torx bit to remove the bolts near the bottom of the opening and at the top of the cover for the taillights.

Then remove the covers by carefully pulling them away from the vehicle.

Set aside for reinstallation.

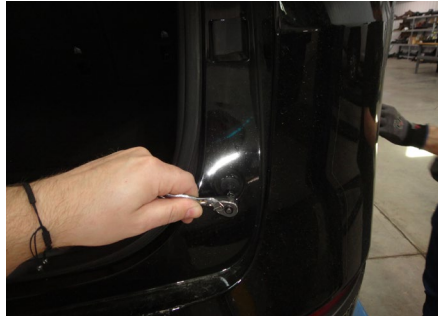

Step 6

Remove the bumper cover by gently pulling it away from the vehicle, starting at the wheel well and working towards the rear.

Set aside for reinstallation.



Step 7

Remove rear bumper beam by removing (3) bolts from the end of each bumper beam to frame rail attachment using a 13mm socket.

Return the bumper beam and fasteners to the vehicle owner.



Step 8

Insert hitch side plates into the end of the frame rails and loosely secure with supplied 1/2" carriage bolts and serrated flange nuts by reaching in the end of the frame rail to install the bottom bolts using fishwires if required.



Step 9

Torque 1/2" hardware to 110 ft-lbs.

Reinstall bumper cover following Steps 1-6 in reverse order.

Note: When not in use, the hitch can be hidden behind the factory bumper cover.



TOWING BASICS & SAFETY INFORMATION

For information on safely towing your trailer, visit curtmfg.com/understanding-towing.