

INSTALLATION MANUAL

13617

Level of Difficulty

Moderate

Installation difficulty levels are based on time and effort involved and may vary depending on the installer level of expertise, condition of the vehicle and proper tools and equipment.

Weight Carrying Capacity

Gross trailer weight (GTW)	3,500 lbs.
Tongue weight (TW)	350 lbs.

Parts List

Item	Qty	Description
1	1	Trailer hitch
2	4	Carriage bolt, 1/2"-13 x 1-3/4"
3	4	Serrated-flange nut, 1/2"-13
4	4	Spacer, 1/4" x 1" x 2-1/2"

Tools Required

Ratchet	Torque wrench
Socket, 7mm	Socket, 3/4"
Socket extension, 3"	Die grinder
Rotary tool	Torx bit, T-15

* For a tools reference guide visit curtmfg.com/trailer-hitch-installation

Product Registration and Warranty

CURT stands behind our products with industry-leading warranties. To get copies of the product warranties, register your purchase or provide feedback, visit: warranty.curtgroup.com/surveys

⚠ WARNING

Never exceed the vehicle manufacturer's recommended towing capacity.

Product Photo



NOTICE

Visit www.curtmfg.com for a full-color copy of this instruction manual, as well as helpful videos, guides and much more!

Before you begin installation, read all instructions thoroughly.

Proper tools will improve the quality of installation and reduce the time required.

This installation requires:

- Temporary removal of the underbody panel and trim
- Hole enlargement

Periodic inspection of the trailer hitch should be performed to ensure all mounting hardware remains tight and structural components are secure.

To help prevent damage to the product or vehicle, refer to the specified torque specifications when securing hardware during the installation process.

SAFETY INSTRUCTIONS

Safety glasses should be worn at all times while installing this product.

ASSEMBLY

Parts List

Item	Qty	Description
1	1	Trailer hitch
2	4	Carriage bolt, 1/2"-13 x 1-3/4"
3	4	Serrated-flange nut, 1/2"-13
4	4	Spacer, 1/4" x 1" x 2-1/2"

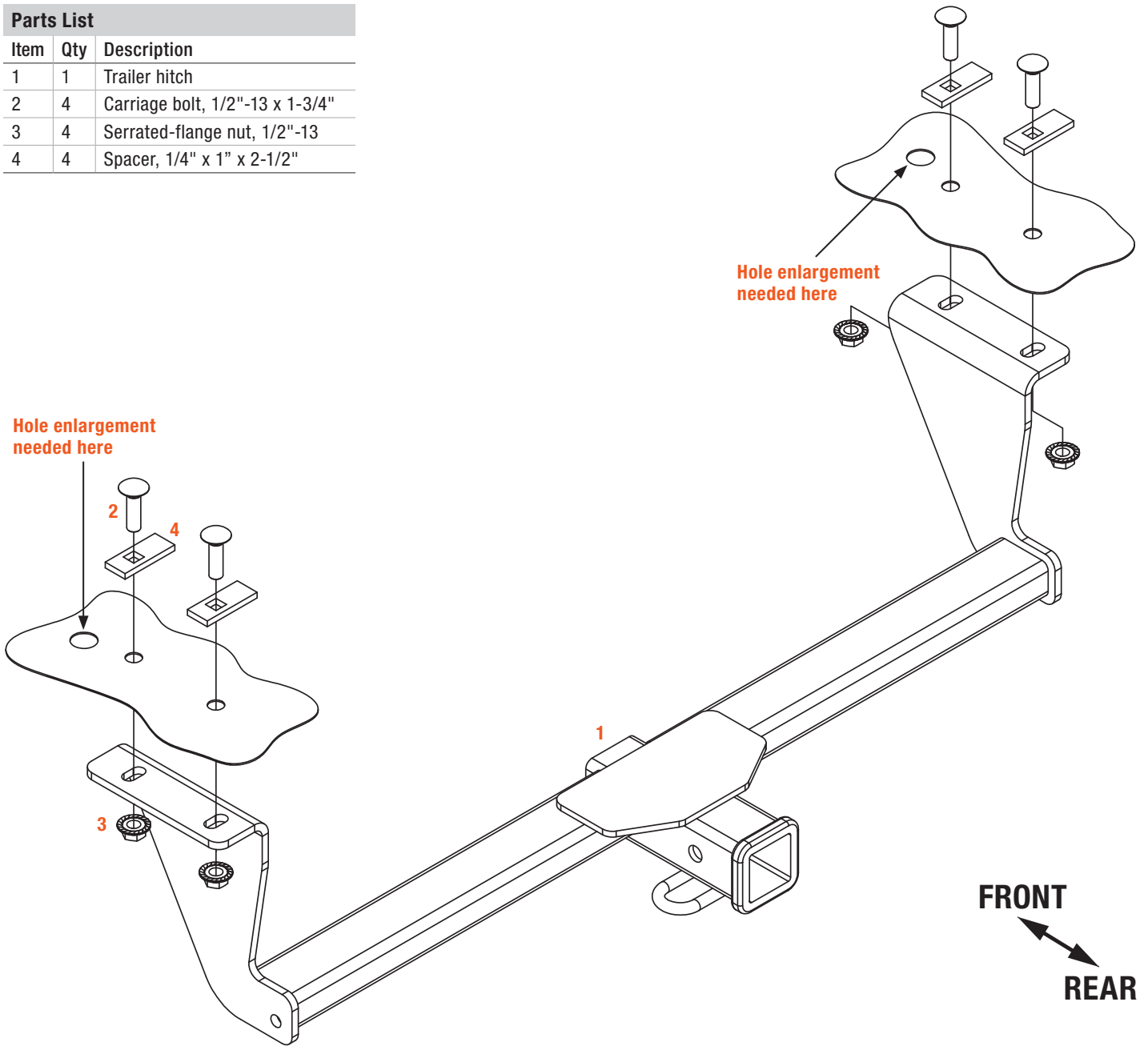

FISHWIRE TECHNIQUE

Insert coiled end of fishwire tool through hitch mounting hole in vehicle frame rail and out the access hole. Pass coiled end of fishwire through spacer and thread bolt into coil. Kink wire to keep spacer separate from bolt as shown. Pull fishwire, spacer and bolt through frame and out mounting hole. Use fishwire to guide hitch during mounting and prevent loss of bolt or spacer inside frame rail.

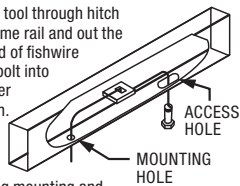

HOLE ENLARGEMENT

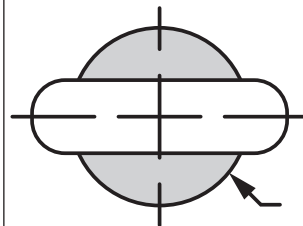

Step 1

Using a T15 bit, remove sixteen (16) screws from the underbody panel. Using a 7mm socket, remove four (4) more hex-head screws, then remove two (2) push pins.

Remove the underbody panel and set it aside for trimming in step 3.



Step 2

Enlarge the access holes and fishwire 1/2" carriage bolts (#2) and spacers (#4) into the mounting holes. Leave the fishwires attached.

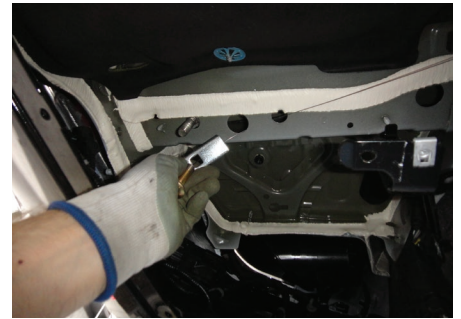

Step 3

Trim the underbody panel following the trim diagram as reference.



Step 4

Raise the hitch (#1) into position and carefully fishwire the carriage bolts (#2) through the holes. Loosely secure the bolts using the 1/2" serrated-flange nuts (#3).



Step 5

Torque 1/2" hardware to 90 ft-lbs.

Re-install the trimmed underbody panel that was removed in step 1.

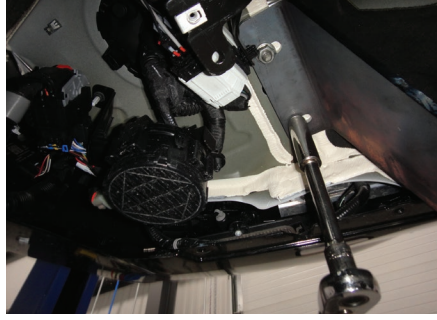

TOWING BASICS & SAFETY INFORMATION

For information on safely towing your trailer, visit curtmfg.com/understanding-towing.