

INSTALLATION MANUAL

13608

Level of Difficulty

Moderate

Installation difficulty levels are based on time and effort involved and may vary depending on the installer level of expertise, condition of the vehicle and proper tools and equipment.

Weight Carrying Capacity

Gross trailer weight (GTW)	2,000 lbs.
Tongue weight (TW)	200 lbs.

Parts List

Item	Qty	Description
1	6	M10 -1.25 x 40mm, CL8.8
2	6	Conical-toothed washer, 3/8"

Tools Required

Ratchet	Socket extension, 6"
Torque wrench	Flathead screwdriver
Socket, 10mm	Rotary tool
Socket, 14mm	Tape
Socket, 17mm	Tape measure

* For a tools reference guide visit curtmfg.com/trailer-hitch-installation

Product Registration and Warranty

CURT stands behind our products with industry-leading warranties. To get copies of the product warranties, register your purchase or provide feedback, visit: warranty.curtgroup.com/surveys

⚠ WARNING

Never exceed the vehicle manufacturer's recommended towing capacity.

Product Photo



NOTICE

Visit www.curtmfg.com for a full-color copy of this instruction manual, as well as helpful videos, guides and much more!

Before you begin installation, read all instructions thoroughly.

Proper tools will improve the quality of installation and reduce the time required.

This installation may require:

- Lowering of the exhaust (for gasoline models only)
- Trimming of the underbody panel (for Kona EV models only)

Periodic inspection of the trailer hitch should be performed to ensure all mounting hardware remains tight and structural components are secure.

To help prevent damage to the product or vehicle, refer to the specified torque specifications when securing hardware during the installation process.

SAFETY INSTRUCTIONS

Safety glasses should be worn at all times while installing this product.

ASSEMBLY

Parts List

Item	Qty	Description
1	6	M10 -1.25 x 40mm, CL8.8
2	6	Conical-toothed washer, 3/8"

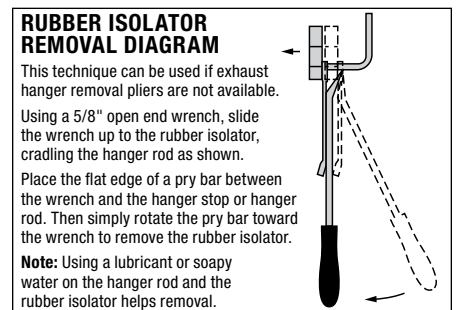
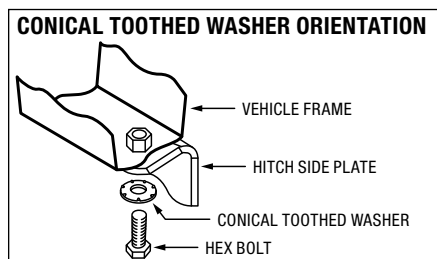
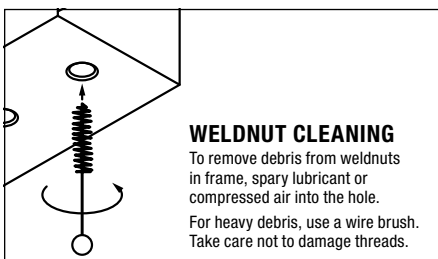
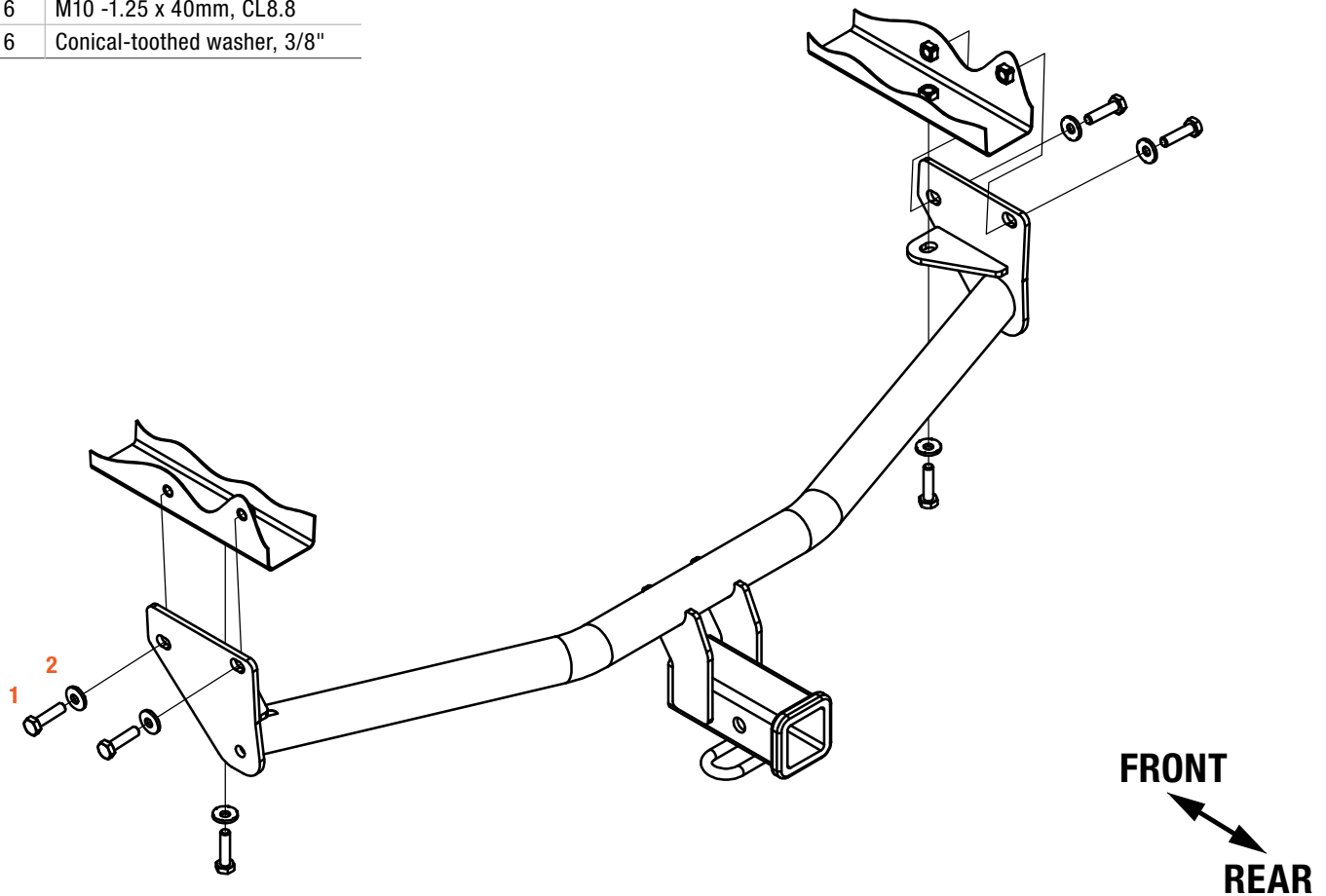

Step 1 (EV models only) For models with an exhaust, skip to step 4.

Detach the frontmost underbody panel from the rearmost underbody bumper panel by unscrewing the two rearmost hex nuts using a 10mm socket and socket extension.

Gently pull the underbody panel straight down and allow the frontmost lower panel to hang down. Set the frontmost underbody panel and two hex nuts aside for reinstallation in step 6.



Step 2 (EV models only)

Use a flathead screwdriver to remove six lower plastic clips from the underbody bumper panel. Use a 14mm socket to unscrew the four plastic hex nuts securing the underbody panel to the bumper. Two hex nuts are located under the frontmost underbody panel and two hex nuts are located on the driver and passenger side of the rearmost underbody bumper panel.

Gently pull the rearmost underbody bumper panel straight down to remove it from the bumper. Set the six plastic clips and four plastic hex nuts aside for reinstallation in step 6.



Step 3 (EV models only)

Mark and trim the rearmost underbody bumper panel using a tape measure, tape and rotary tool. See the trim diagram for approximate dimensions of the cutout.

Set the plastic cover aside for reinstallation in step 6.

Skip ahead to step 5.

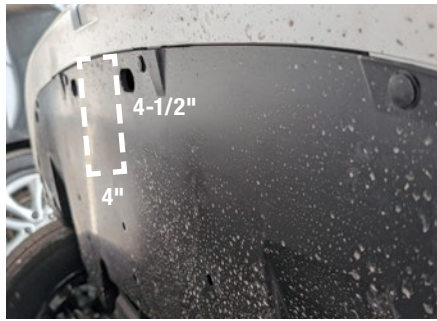

Step 4 (Models with an exhaust only)

Lower the exhaust by removing the two rearmost exhaust hanger rods on both sides from the two rubber isolators.

The exhaust will be reinstalled in step 6.

Note: Place a support stand under the exhaust to prevent damage to the vehicle.



Step 5 (All models)

Raise the hitch over the exhaust on the passenger side first, if applicable. Gently pull the bumper fascia rearward if needed and raise the hitch into position. Install the six M10 bolts (#1) and six conical-toothed washers (#2) into the existing vehicle weld nuts using a 17mm socket.

Torque the M10 hardware to 33.4 ft-lbs. using a torque wrench, 17mm socket and extension, if needed.



Step 6 (All models)

For models with an exhaust: Reinstall the exhaust onto the hangers rods as described in reverse in step 4.

For Kona EV models: Reinstall the rearmost underbody bumper panel, plastic clips, hex nuts and the frontmost underbody panel as described in reverse in steps 1 through 3.



TOWING BASICS & SAFETY INFORMATION

For information on safely towing your trailer, visit curtmfg.com/understanding-towing.