



# 13384 INSTALLATION INSTRUCTIONS



Safety glasses should be worn at all times while installing this product.

YEARS: 2018-PRESENT

MAKE: BUICK

MODEL: ENCLAVE

STYLE: SUV



**WARNING: NEVER EXCEED YOUR VEHICLE MANUFACTURER'S RECOMMENDED TOWING CAPACITY**  
For more information log onto [www.curtmfg.com](http://www.curtmfg.com) & for helpful towing tips log onto [www.hitchinfo.com](http://www.hitchinfo.com)

## WEIGHT CARRYING:

TRAILER WEIGHT: 5,000 LBS.  
TONGUE WEIGHT: 750 LBS.

## WEIGHT DISTRIBUTION:

TRAILER WEIGHT: 7,500 LBS.  
TONGUE WEIGHT: 750 LBS.

PRO INSTALL TIME: 35 MIN.

NOVICE INSTALL TIME: 70 MIN.

IF YOU ARE HESITANT TO UNDERTAKE  
THIS TASK ON YOUR OWN, CONTACT AN AUTHORIZED  
CURT INSTALLER FOR ADDITIONAL ASSISTANCE.

## INSTALLATION TIPS:

1. BEFORE YOU BEGIN INSTALLATION, READ ALL INSTRUCTIONS THOROUGHLY.
2. TO EASE INSTALLATION, 2 PEOPLE MAY BE REQUIRED.
3. USING PROPER TOOLS WILL GREATLY IMPROVE THE QUALITY OF THE INSTALL AND REDUCE THE TIME REQUIRED.
4. NEED HELP OR HAVE SOME QUESTIONS?  
CALL TECHNICAL SUPPORT AT 877.287.8634

## LEVEL OF DIFFICULTY: MODERATE

EASY

MODERATE

CHALLENGING



LOWER EXHAUST



ENLARGE (2) HOLES



NO DRILLING REQUIRED

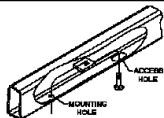

FISHWIRE (2) FASTENERS



REMOVE HEAT SHIELDS OR  
MODIFY AND REINSTALL

## VEHICLE PHOTO:



REPRESENTATIVE PHOTO

## HITCH ILLUSTRATION:

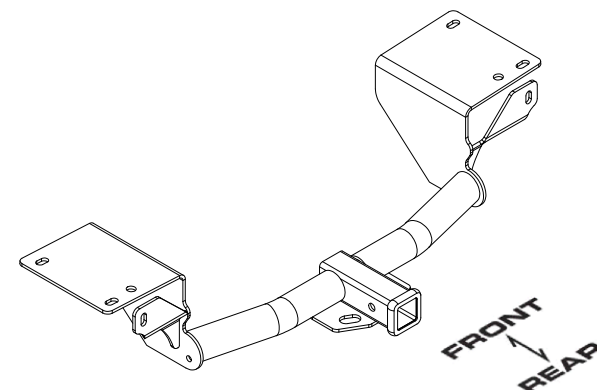

MAKE SURE YOUR HITCH MATCHES



SCAN FOR  
MORE INFO

**PERIODICALLY CHECK THIS RECEIVER HITCH TO ENSURE ALL FASTENERS ARE TIGHT AND ALL STRUCTURAL COMPONENTS ARE SOUND**

CURT Manufacturing LLC. warrants this product to be free of defects in material and/or workmanship at the time of retail purchase by the original purchaser. If the product is found to be defective, CURT Manufacturing LLC. may repair or replace the product at their option, when the product is returned, prepaid, with proof of purchase. Alteration to, misuse of, or improper installation of this product voids the warranty. CURT Manufacturing LLC.'s liability is limited to repair or replacement of products found to be defective, and specifically excludes liability for incidental or consequential loss or damage.

For more information log onto [www.curtmfg.com](http://www.curtmfg.com)

This product complies with safety specifications and requirements for connecting devices and towing systems of the state of New York, V.E.S.C.Regulation V-5 and SAE J684.

4/20/2021

## INSTALLATION WALKTHROUGH:

Parts List			
ITEM	QTY	PART NUMBER	DESCRIPTION
1	2	10-10304	BOLT,CAR,1/2-13 UNC,2-1/4,GRD8,YZ
2	2	20-00062	NUT,SER-FLANGE,1/2-13 UNC,GRD8,YZ
3	2	CM-SP50	.250 x 1.00 x 1.50" ROUND HOLE SPACER
4	4	10-10490	HHCS,M10x1.5,50,CL10.9,YZ
5	2	30-00149	WASHER,S-CON,1/2,YZ
6	2	10-10603	HHCS,1/2-13 UNC,2-1/4,GRD5
7	2	1_2 FISHWIRE	1/2" FISHWIRE
8	2	13384-NPWA	NUT PLATE WELDMENT ASSEMBLY

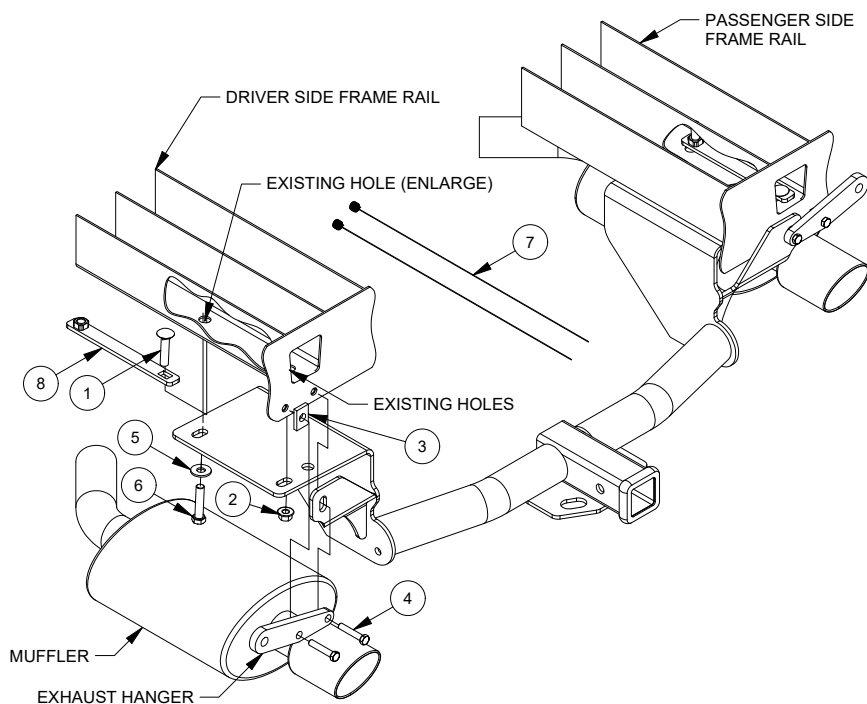

### FISHWIRE TECHNIQUE

INSERT COILED END OF FISHWIRE TOOL THROUGH HITCH MOUNTING HOLE IN VEHICLE FRAME RAIL AND OUT THE ACCESS HOLE. PASS COILED END OF FISHWIRE THROUGH SPACER AND THREAD BOLT INTO COIL. KINK WIRE TO KEEP SPACER SEPARATE FROM BOLT AS SHOWN. PULL FISHWIRE, SPACER, AND BOLT THROUGH FRAME AND OUT MOUNTING HOLE. USE FISHWIRE TO GUIDE HITCH DURING MOUNTING AND PREVENT LOSS OF BOLT / SPACER INSIDE FRAME RAIL.

\*\*NOTE: SOME VEHICLES MAY FISHWIRE THROUGH END OF FRAME\*\*

FRONT  
↕  
REAR

1. Lower exhaust by removing (4) bolts from each rear exhaust hanger brackets (2 per side) using a 15mm socket, return bolts to owner.

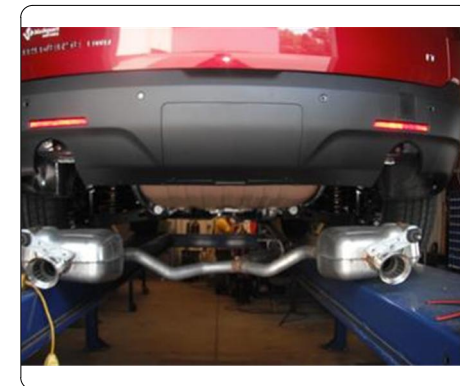
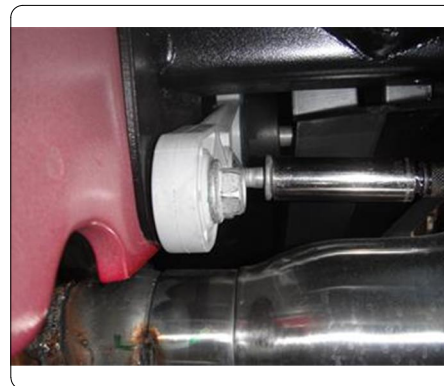

2. Remove the rearward most heat shield fastener in the frame and return to owner. Heat shield will be compressed between the frame and hitch.

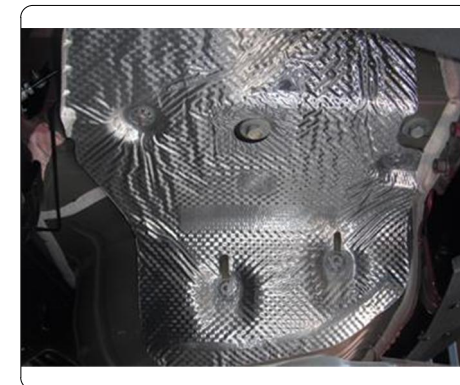
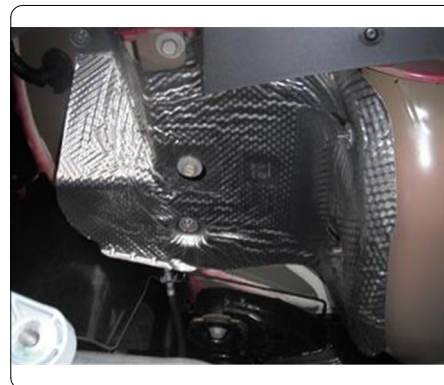

## INSTALLATION WALKTHROUGH:

3. Using a die grinder, enlarge the forward mounting hole to accept the supplied nut plates. Fishwire the supplied  $\frac{1}{2}$ " carriage bolt into the rectangular hole in the nut plate and into the rearwardmost mounting hole. Slide the nut plates into the enlarged hole (one per side) with the nut towards the front of the vehicle. See fishwire diagram on page 2.



4. Carefully raise hitch into position with the rear tabs on the rearward side of the frame flange so as not to push the carriage bolts into the frame. Install the (2)  $\frac{1}{2}$ " hex bolts and conical tooth washers into the nut plate. Install the remaining  $\frac{1}{2}$ " hex flange nuts. Torque  $\frac{1}{2}$ " carriage bolts to 110 lb-ft. Torque  $\frac{1}{2}$ " hex bolts to 75 lb-ft.

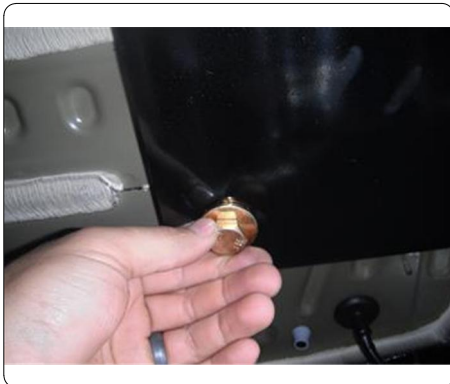

5. Using the supplied M10 bolts, raise the exhaust back into position and install the bolts with the spacer on the outboard mounting location between the frame and the exhaust hanger as shown in the diagram on page 2. Torque all M10 fasteners to 45 lb-ft.

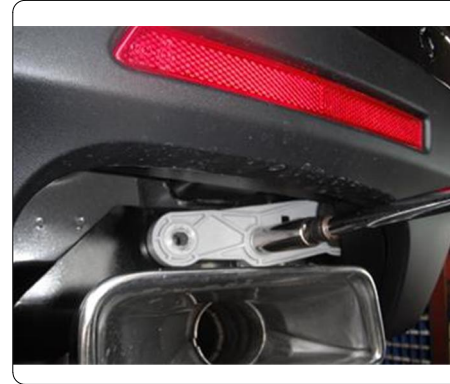



## TOWING SAFETY INFORMATION

### Gross Trailer Weight / GTW

The Gross Trailer Weight is the weight of the trailer & cargo. Measure this by putting the fully loaded trailer on a vehicle scale.

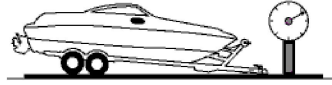

### Tongue Weight / TW

The downward force that is exerted on the hitch ball by the coupler. The tongue weight will vary depending on where the load is positioned in relationship to the trailer axle(s). To measure the tongue weight, use either a commercial scale or a bathroom scale with the coupler at towing height. When using a bathroom scale with heavier tongue weights, use the method shown and multiply the scale reading by 3.

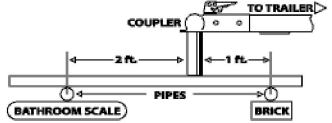

### Weight Carrying / WC

The total weight of both the trailer and the cargo inside. Never exceed the weight capacity of your trailer hitch.

### Weight Distribution / WD

Used to balance the weight of the cargo between the front and rear wheels throughout the trailer, allowing for better steering, braking, and level riding.



### Sway Control

A device used to reduce the lateral movements of the trailer that are caused by the wind. This works in conjunction with a weight distribution hitch. Do not use this on a class 1 or 2 hitch, or with surge brakes.

### How Much Can You Safely Tow?

TONGUE WEIGHT	1000	2000	3000	4000	5000	6000	7000	8000	10,000	12,000
Tongue weight should be about 10 to 15 percent of the gross trailer weight.										
CLASS 1										
CLASS 2										
CLASS 3										
CLASS 4										
CLASS 5										
TRAILER TYPE	11'	12'	13'	14'	15'	16'	17'	18'	19'	20'
Camper	1100	1200	1300	1400	1500	1600				
Vacation	2100	2400	2700	3000	3300	3600	3900	4200	4500	4800
Vacation	2800	3200	3600	4000	4400	4800	5200	5600	6000	6400
5th Wheel										

Refer to owner's manual for towing capabilities and limitations.

### Ball Mount

The ball mount is placed inside the opening of the receiver hitch which is mounted to the vehicle. Make sure a hitch pin and clip is properly securing the ball mount to the receiver hitch before you begin towing.

- A: Rise. B: Drop. C: Hole Size. D: Length.

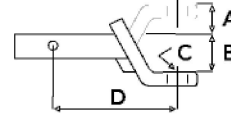

### Trailer Ball

The connection from the hitch to the trailer. There are many factors that determine the correct hitch ball:

- Number one is the hitch ball's gross trailer weight rating.
- The mounting platform must be at least 3/8" thick.
- The hole diameter must not be more than 1/16" larger than the threaded shank.
- Every time you tow, check the nut and lock washer to make sure they are fastened securely.
- A: Ball Dia. B: Shank Length. C: Shank Dia. D: Shank Rise.

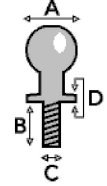

### Coupler

The component that is placed over the trailer ball to connect the vehicle to the trailer. Be sure that the coupler size matches the size of the hitch ball and that the coupler handle is securely fastened. To determine what size hitch ball you need for your application you will need to know the size of coupler that is on the trailer. Be sure your coupler is properly adjusted to the ball you are using.

NOTE: For added security the use of safety devices such as Coupler Safety Pins and Locks is strongly recommended.

### Safety Chains

Safety chains are a requirement and should be crossed under the tongue of the trailer so that the tongue will not drop to the road if it becomes separated from the hitch. Always leave enough slack so you can turn. Never allow the safety chains to drag on the ground and never attach the chains to the bumper.

Trailer Classification: Safety Chain Breaking Force - Minimum

Class 1: 2,000 lbs. (8.9 kN)

Class 2: 3,500 lbs. (15.6 kN)

Class 3: 5,000 lbs. (22.2 kN)

The strength rating of each length of safety chain or its equivalent and its attachments shall be equal to or exceed in minimum breaking force the GVWR (Gross Vehicle Weight Rating) of the trailer.

### Electrical

Trailer lights, Electric Brakes, Break-away systems - Every time you tow, be sure to check that all components are working properly.

Wiring identification by color:

7-WAY						
6-WAY						
5-WAY						
4-WAY						
GREEN	YELLOW	BROWN	WHITE	RED	BLUE	PURPLE
RIGHT TURN & BRAKE	LEFT TURN & BRAKE	TAILLIGHTS	GROUND	AUXILIARY POWER	ELECTRIC BRAKES	BACK-UP LIGHTS

CURT DISCLAIMER: WIRING COLOR SHOWN WORK IN CONJUNCTION WITH CURT MANUFACTURING PRODUCTS.

13384

BUICK ENCLAVE

4/20/2021

GROSS LOAD CAPACITY WHEN USED AS A WEIGHT CARRYING HITCH: 5,000 LBS. TRAILER WEIGHT & 750 LBS. TONGUE WEIGHT.  
GROSS LOAD CAPACITY WHEN USED AS A WEIGHT DISTRIBUTION HITCH: 7,500 LBS. TRAILER WEIGHT & 750 LBS. TONGUE WEIGHT



**WARNING: \*\*\* DO NOT EXCEED VEHICLE MANUFACTURER'S RECOMMENDED TOWING CAPACITY. \*\*\***



FOR MORE INFORMATION LOG ONTO [WWW.CURTMFG.COM](http://WWW.CURTMFG.COM)  
HAVING INSTALLATION QUESTIONS? CALL TECHNICAL SUPPORT AT 1-877-287-8634

Parts List			
ITEM	QTY	PART NUMBER	DESCRIPTION
1	2	10-10304	BOLT,CAR,1/2-13 UNC,2-1/4,GRD8,YZ
2	2	20-00062	NUT,SER-FLANGE,1/2-13 UNC,GRD8,YZ
3	2	10-10603	HHCS,1/2-13 UNC,2-1/4,GRD5
4	2	30-00149	WASHER,S-CON,1/2,YZ
5	2	CM-SP50	.250 x 1.00 x 1.50" ROUND HOLE SPACER
6	4	10-10490	HHCS,M10x1.5,50,CL10.9,YZ
7	2	1_2 FISHWIRE	1/2" FISHWIRE
8	2	13384-NPWA	NUT PLATE WELDMENT ASSEMBLY

TOOLS REQUIRED
RATCHET
TORQUE WRENCH
+6" SOCKET EXTENSION
STRAIGHT SCREW DRIVER
DIE GRINDER
15MM AND 3/4" SOCKETS
SAFETY GLASSES

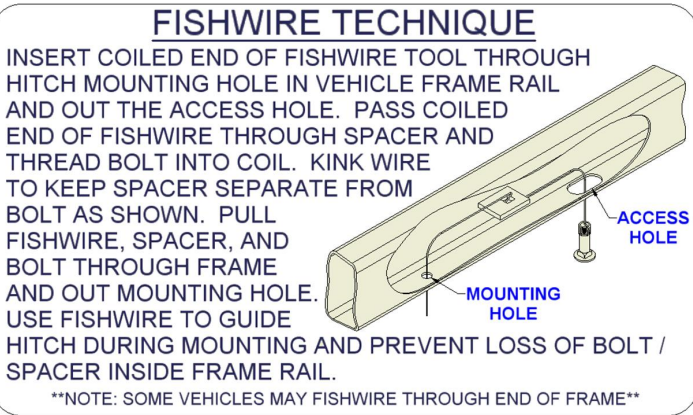
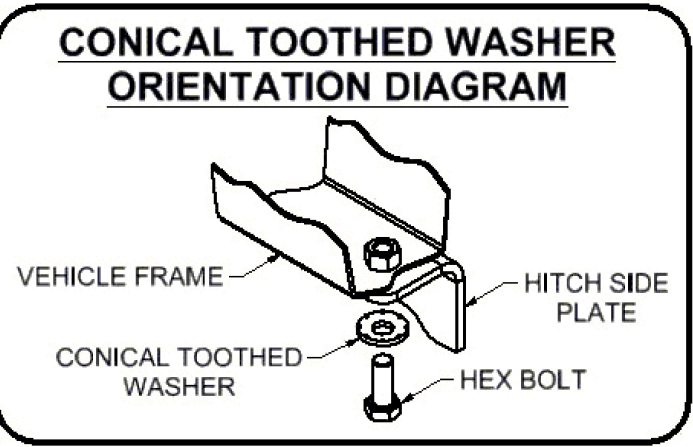

HITCH WEIGHT: 46 LBS.  
INSTALL TIME  
PROFESSIONAL: 35 MINUTES  
NOVICE (DIY): 70 MINUTES  
INSTALL NOTES:  
- LOWER EXHAUST  
- ENLARGE (2) HOLES  
- NO DRILLING REQUIRED  
- FISHWIRING REQUIRED

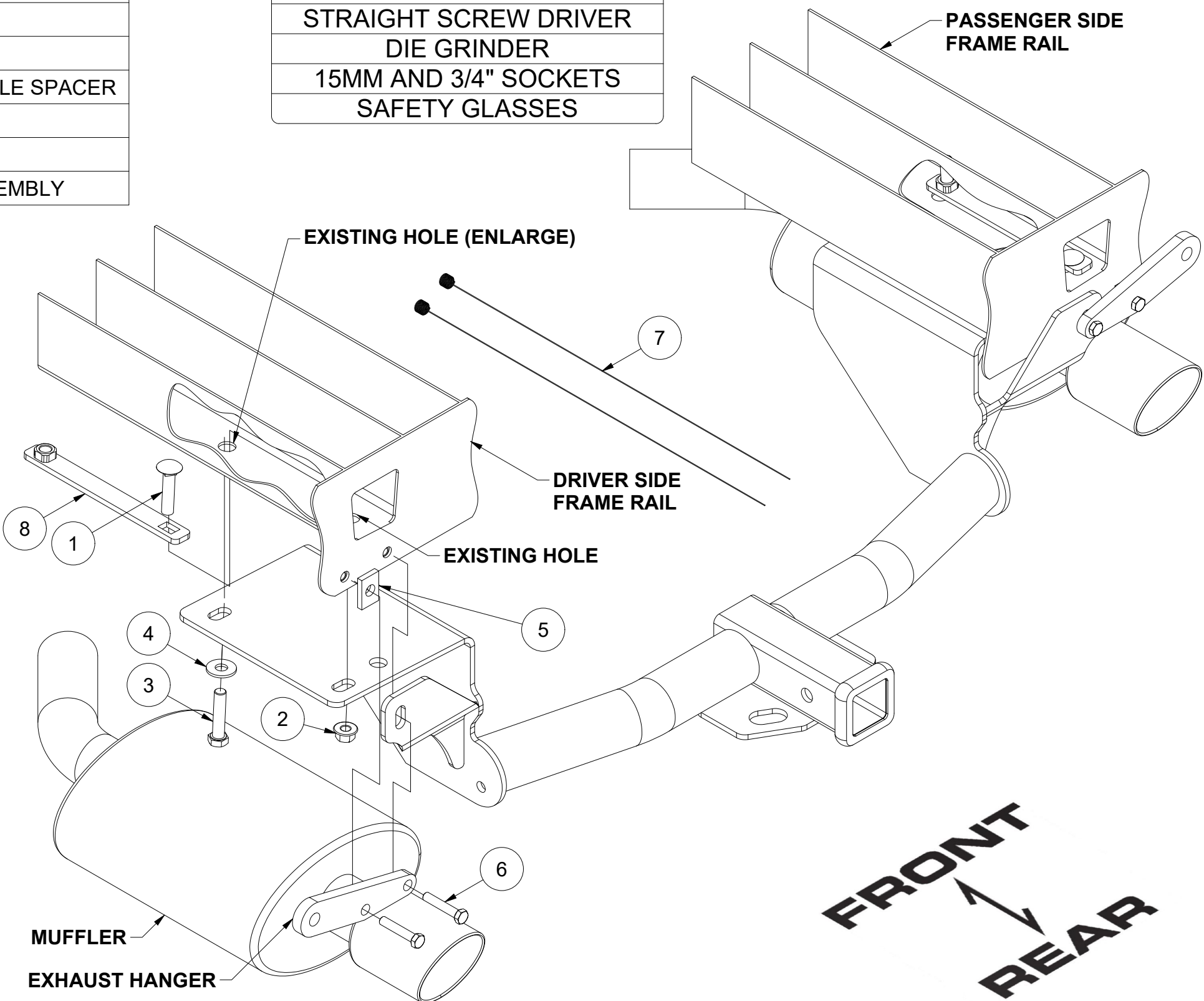

INSTALLATION STEPS

1. Lower exhaust by removing (4) bolts from each rear exhaust hanger brackets (2 per side) using a 15mm socket, return bolts to owner.
2. Remove the rearward most heat shield fastener on the frame and return to owner. Heat sheild will be compressed between the frame and the hitch.
3. Using a die grinder, enlarge the forward mounting hole to accept the supplied nut plates. Fishwire the supplied 1/2" carriage bolt into the rectangular hole in the nut plate and into the rearwardmost mounting hole. Slide the nut plates into the enlarged hole (one per side) with the nut towards the front of the vehicle.
4. Carefully raise hitch into position with the rear tabs on the rearward side of the frame flange so as not to push the carriage bolts into the frame. Install the (2) 1/2" hex bolts and conical tooth washers into the nut plate. Install the remaining 1/2" hex flange nuts. Torque 1/2" carriage bolts to 110 lb-ft and hex head bolts to 75 lb-ft.
5. Using the supplied M10 bolts, raise the exhaust back into position and install the bolts with the spacer on the outboard mounting location between the frame and the exhaust hanger as shown above. Torque all M10 fastaners to 45 lb-ft.



Scan for more information

**PERIODICALLY CHECK THIS RECEIVER HITCH TO ENSURE THAT ALL FASTENERS ARE TIGHT AND THAT ALL STRUCTURAL COMPONENTS ARE SOUND.**

CURT Manufacturing LLC., warrants this product to be free of defects in material and/or workmanship at the time of retail purchase by the original purchaser. If the product is found to be defective, CURT Manufacturing LLC., may repair or replace the product, at their option, when the product is returned, prepaid, with proof of purchase. Alteration to, misuse of, or improper installation of this product voids the warranty. CURT Manufacturing LLC.'s liability is limited to repair or replacement of products found to be defective, and specifically excludes liability for incidental or consequential loss or damage.  
This product complies with safety specifications and requirements for connecting devices and towing systems of the state of New York, V.E.S.C.Regulation V-5 and SAE J684.