

12101

93-97 DODGE INTREPID, 93-97 CHRYSLER CONCORDE, 94-97 CHRYSLER LHS, 94-96 CHRYSLER NEW YORKER, 93-97 EAGLE VISION

10/15/2020

GROSS LOAD CAPACITY WHEN USED AS A WEIGHT CARRYING HITCH: 3500 LBS. TRAILER WEIGHT & 350 LBS. TONGUE WEIGHT.

*****DO NOT EXCEED VEHICLE MANUFACTURER'S RECOMMENDED TOWING CAPACITY.*****

WARNING: ALL NON-TRAILER LOADS APPLIED TO THIS PRODUCT MUST BE SUPPORTED BY AUXILIARY STABILIZING STRAPS.

**** FAILURE TO PROPERLY SUPPORT NON-TRAILER LOADS WILL VOID PRODUCT WARRANTY****

HAVING INSTALLATION QUESTIONS? CALL TECHNICAL SUPPORT AT 877-287-8634

Parts List			
ITEM	QTY	PART NUMBER	DESCRIPTION
1	6	20-00062	NUT, SER-FLANGE, 1/2-13 UNC, GRD8, YZ
2	3	20-00166	NUT, HEX, 3/8-16 UNC, GRD8, YZ
3	1	10-10339	HHCS, 3/8-16 UNC, 1-1/4, GRD8, YZ
4	1	30-00186	WASHER, FLAT, 3/8, YZ
5	6	30-00148	WASHER, S-CON, 3/8, YZ
6	1	10-10465	U-BOLT, 3/8-16 UNC, 1-9/16, N/A, CZ
7	1	20-00178	NUT, HEX, M8x1.25, CL10, YZ
8	1	10-10393	HHCS, M8x1.25, 35, CL10.9, YZ
9	1	10-10409	HHCS, M8x1.25, 20, CL10.9, CZ
10	6	10-10272	BOLT, CAR, 1/2-13 UNC, 1-3/4, GRD8, YZ
11	1	CM-12101-MP	PLATE .250" A-36 H.R. (COMMERCIAL QUALITY)
12	1	CM-12101-TMP	INSTALLATION TEMPLATE (NOT SHOWN)

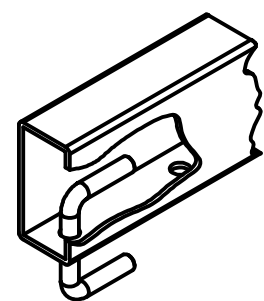

U-BOLT INSTALLATION

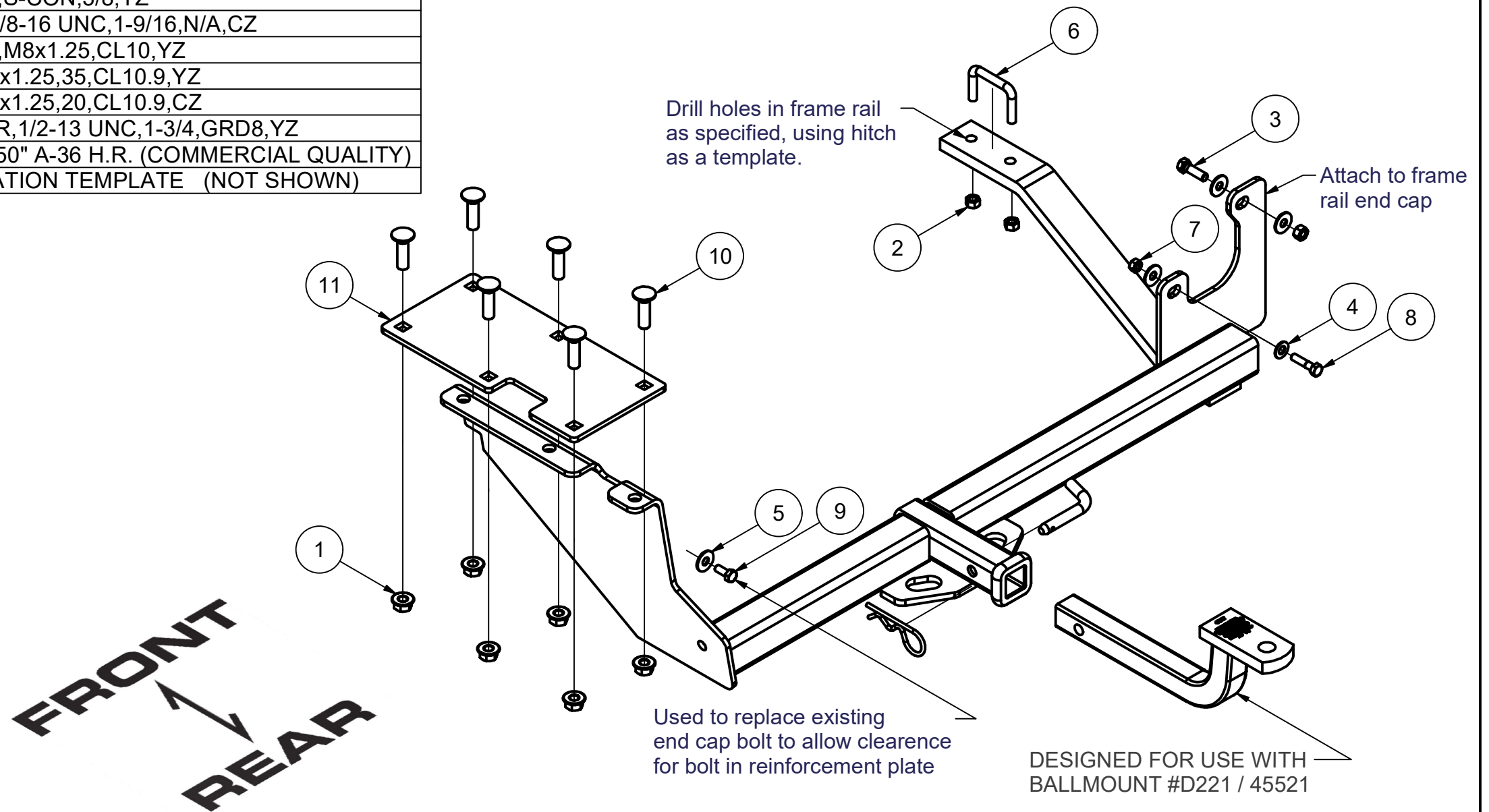

HITCH WEIGHT: 39 LBS.

INSTALL TIME

PROFESSIONAL: 45 MINUTES

NOVICE (DIY): 90 MINUTES

INSTALL NOTES:

*New Yorker & LHS have a frame extension. Hitch is not to be installed in that area.

INSTALLATION STEPS

- 1) Remove two fasteners that attach the passenger's side bumper bracket to the frame rail end cap. Return fasteners to vehicle owner. Remove the existing driver's side inboard frame rail end cap bolts and replace it with fastener shown. Remove spare tire cover and pull the trunk carpeting back to expose the driver's side of the trunk pan.
- 2) Cut along dotted lines of template. Place template inside trunk on driver's side of spare tire well. Template should be positioned so that the arrows line up with the center of ribs in the trunk pan. Tape template in place once the arrows are lined up.
- 3) Center punch three places as specified on the template. Remove template and drill three 1/8" holes through trunk at punched locations.
- 4) Lift the hitch into position & loosely fasten M8 & 3/8" fasteners provided through passenger side end cap. **(Note: If necessary enlarge existing holes in vehicle end cap for 3/8" fastener.)**
- 5) Check the alignment of the 1/8" drilled holes in the trunk pan. Make adjustments as necessary and enlarge holes to 1/2".
- 6) Using the hitch as a template mark the passenger side frame rail for drilling. Remove the hitch and drill two 1/2" holes through the passenger side frame rail. Install the 3/8" U-bolt in the previously drilled holes.
- 7) Reinstall hitch being careful not to knock the U-bolt into the frame rail. Loosely install the 3/8" conical washers, and nuts & M8 fasteners provided.
- 8) Position reinforcement plate inside trunk, aligning the notch with the sealed drain hole and making sure the holes in the plate line up with the holes enlarged in step 5.
- 9) Install 1/2" carriage bolts down thru reinforcement plate, trunk pan, into hitch and fasten with flange nuts.
- 10) Using reinforcement plate as a template, drill three 1/2" holes through the trunk pan. Install remaining 1/2" carriage bolts and fasten with flange nuts. **Notes: (1) It may be necessary to lower exhaust to tighten 1/2" fasteners. (2) Seal all holes drilled in vehicle to prevent entry of exhaust fumes into trunk.**
- 11) Torque 1/2" fasteners to 110 lb.-ft., 3/8" U-Bolt fasteners to 44 lb.-ft., other 3/8" fasteners to 45 lb.-ft., M8 fasteners to 13 lb.-ft. Reinstall carpeting and spare tire cover in trunk.

PERIODICALLY CHECK THIS RECEIVER HITCH TO ENSURE THAT ALL FASTENERS ARE TIGHT AND THAT ALL STRUCTURAL COMPONENTS ARE SOUND.

Curt Manufacturing Inc., warrants this product to be free of defects in material and/or workmanship at the time of retail purchase by the original purchaser. If the product is found to be defective, Curt Manufacturing Inc., may repair or replace the product, at their option, when the product is returned, prepaid, with proof of purchase. Alteration to, misuse of, or improper installation of this product voids the warranty. Curt Manufacturing Inc.'s liability is limited to repair or replacement of products found to be defective, and specifically excludes liability for incidental or consequential loss or damage.

Cut along dotted lines

**DO NOT REDUCE
TEMPLATE MUST REMAIN FULL
SIZE FOR USE. VERIFY HOLE
DIMENSION BEFORE USE.**

Align arrows with center
of ribs in trunk pan

Rib in trunk pan

Center punch and
drill 1/8" hole, 3 places

Sealed Drain

5.50

5.50

**Driver's Side
Rear of Vehicle**

