

INSTALLATION MANUAL

11688

Level of Difficulty

Moderate

Installation difficulty levels are based on time and effort involved and may vary depending on the installer level of expertise, condition of the vehicle and proper tools and equipment.

Weight Carrying Capacity

Gross trailer weight (GTW)	2,000 lbs.
Tongue weight (TW)	200 lbs.

Parts List

1	Trailer hitch
2	Carriage bolt, 1/2"-13 x 1/2", gr8
2	Flange nut, 1/2"-13"
2	Square hole spacer, .250" x 1.0" x 2.50"

Tools Required

Ratchet	Die grinder
Socket, 18mm	Drill
Socket, 3/4"	Drill bit, 5/8"
Torque wrench	Paint marker
Socket extension, 6"	Fishwire, 1/2" (includes 2 qty)

* For a tools reference guide visit curtmfg.com/trailer-hitch-installation

⚠ WARNING

Never exceed the vehicle manufacturer's recommended towing capacity.

Product Photo



NOTICE

Visit www.curtmfg.com for a full-color copy of this instruction manual, as well as helpful videos, guides and much more!

Before you begin installation, read all instructions thoroughly.

Proper tools will improve the quality of installation and reduce the time required.

This installation requires:

- Drilling
- Hole enlargement
- Part removal

Periodic inspection of the trailer hitch should be performed to ensure all mounting hardware remains tight and structural components are secure.

To help prevent damage to the product or vehicle, refer to the specified torque specifications when securing hardware during the installation process.

SAFETY INSTRUCTIONS

Safety glasses should be worn at all times while installing this product.

Product Registration and Warranty

CURT stands behind our products with industry-leading warranties. To get copies of the product warranties, register your purchase or provide feedback, visit: warranty.curtgroup.com/surveys

ASSEMBLY

Parts List

Item	Qty	Description
1	1	Trailer hitch
2	2	Carriage bolt, 1/2"-13 x 1/2", gr8
3	2	Flange nut, 1/2"-13"
4	2	Square hole spacer, .250" x 1.0" x 2.50"

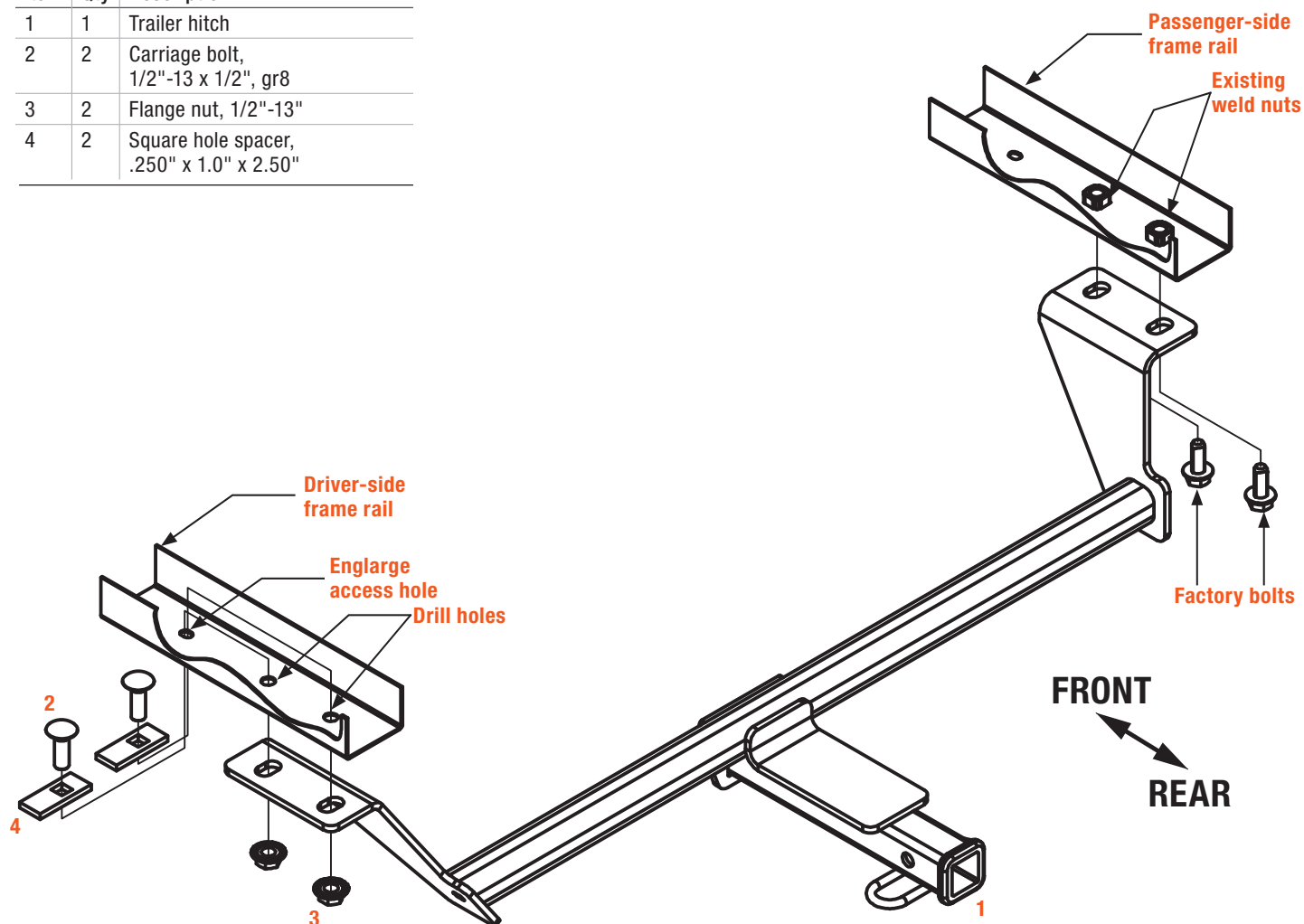

FISHWIRE TECHNIQUE

Insert coiled end of fishwire tool through hitch mounting hole in vehicle frame rail and out the access hole. Pass coiled end of fishwire through spacer and thread bolt into coil. Kink wire to keep spacer separate from bolt as shown. Pull fishwire, spacer and bolt through frame and out mounting hole. Use fishwire to guide hitch during mounting and prevent loss of bolt or spacer inside frame rail.

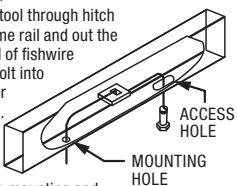

HOLE ENLARGEMENT

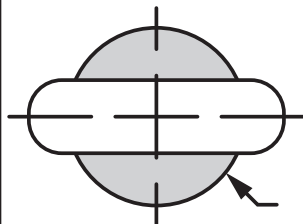

Step 1

Remove the four (4) M12 bolts securing the factory tie down bracket on the passenger side frame rail using an 18mm socket.

Return the tie down bracket and two (2) factory bolts to the customer.



Step 2

Using a die grinder, enlarge the driver's side frame rail access hole as needed to pass through a square hole spacer (#4) and 1/2" carriage bolt (#2).



Step 3

Raise the hitch into position, aligning the passenger frame rail weld nuts with the hitch mounting holes. Optionally, loosely secure the passenger side to the frame rail using two (2) factory bolts to aid in centering the hitch.

Using a paint marker, mark the driver's side hitch mounting hole locations on the frame rail. Hole locations will measure approximately 2-1/8" and 5-1/8" from the rear panel of the frame rail.

Lower the hitch and set aside. Drill the two (2) marked mounting locations on the driver frame rail using a 5/8" drill bit.

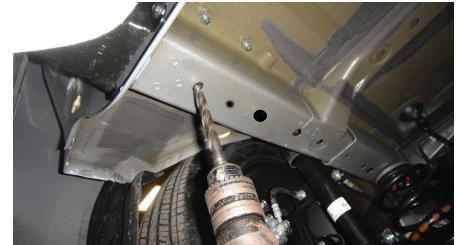

Step 4

Fishwire the 1/2" carriage bolts (#2) and square hole spacers (#4) through the access hole and into the drilled mounting holes.



Step 5

Raise the hitch into position and secure the driver's side using the provided 1/2" flange nuts (#3).

Secure the passenger side using two (2) factory M12 bolts removed from the tie down bracket.



Step 6

Torque all 1/2" hardware to 90 ft -lbs

Torque all M12" hardware to 68 ft-lbs



Final Installed Image



TOWING BASICS & SAFETY INFORMATION

For information on safely towing your trailer, visit [curtmfg.com/understanding-towing](https://www.curtmfg.com/understanding-towing).