

INSTALLATION MANUAL

11683

Level of Difficulty

Moderate

Installation difficulty levels are based on time and effort involved and may vary depending on the installer level of expertise, condition of the vehicle and proper tools and equipment.

Weight Carrying Capacity

Gross trailer weight (GTW)	2,000 lbs.
Tongue weight (TW)	200 lbs.

Parts List

Item	Qty	Description
1	2	Carriage bolt, 1/2"-13 x 1-1/2
2	4	Flange bolt, M8-1.25 x 35mm
3	2	Serrated-flange nut, 1/2"-13
4	2	Square-hole spacer, .250" x 1.00" x 2.50"
5	2	1/2" Fishwire

Tools Required

Ratchet	Die grinder
Torque wrench	Rotary tool
Socket, 10mm	Tape measure
Socket, 12mm	Flathead screwdriver
Socket, 13mm	Fishwire, 1/2"
Socket, 3/4"	(includes 2 qty)
Socket extension, 6"	--

* For a tools reference guide visit curtmfg.com/trailer-hitch-installation

⚠ WARNING

Never exceed the vehicle manufacturer's recommended towing capacity.

Product Photo



NOTICE

Visit www.curtmfg.com for a full-color copy of this instruction manual, as well as helpful videos, guides and much more!

Before you begin installation, read all instructions thoroughly.

Proper tools will improve the quality of installation and reduce the time required.

This installation requires:

- Lowering of the exhaust
- Trimming of the underbody panel
- Hole enlargement

Periodic inspection of the trailer hitch should be performed to ensure all mounting hardware remains tight and structural components are secure.

To help prevent damage to the product or vehicle, refer to the specified torque specifications when securing hardware during the installation process.

SAFETY INSTRUCTIONS

Safety glasses should be worn at all times while installing this product.

Product Registration and Warranty

CURT stands behind our products with industry-leading warranties. To get copies of the product warranties, register your purchase or provide feedback, visit: warranty.curtgroup.com/surveys

ASSEMBLY

Parts List

Item	Qty	Description
1	2	Carriage bolt, 1/2"-13 x 1-1/2
2	4	Flange bolt, M8-1.25 x 35mm
3	2	Serrated-flange nut, 1/2"-13
4	2	Square-hole spacer, .250" x 1.00" x 2.50"
5	2	1/2" Fishwire

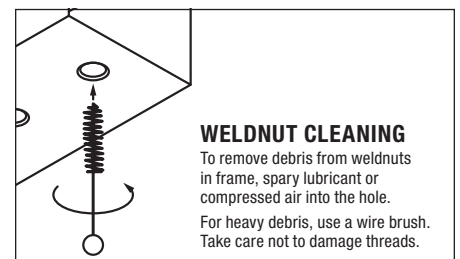
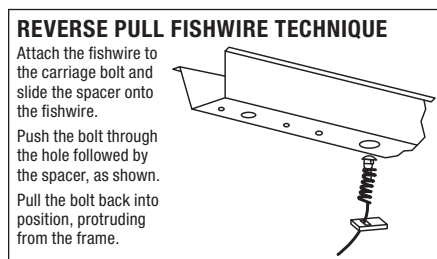
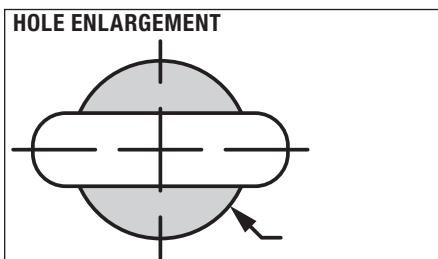
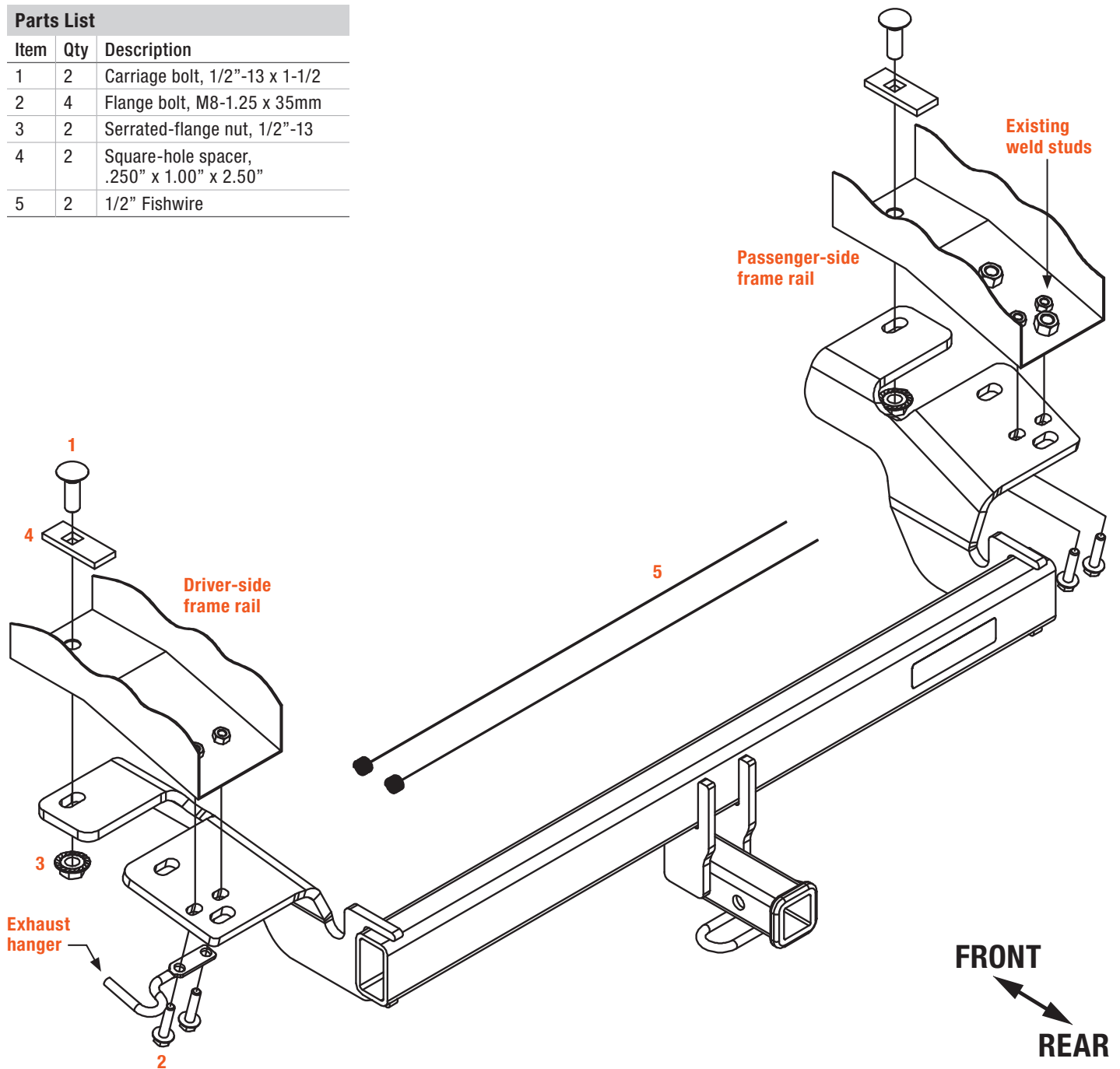

Step 1

Remove eight (8) trim clips from the underbody panel.

Using a 12mm socket, remove two (2) plastic retainers from the underbody panel.

Using a 10mm socket, remove three (3) more plastic retainers and one (1) bolt.

Remove the underbody panel and set it aside for trimming and reinstallation in step 8.

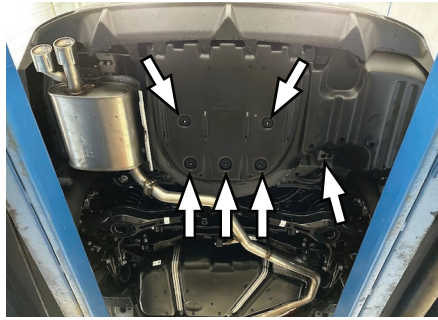
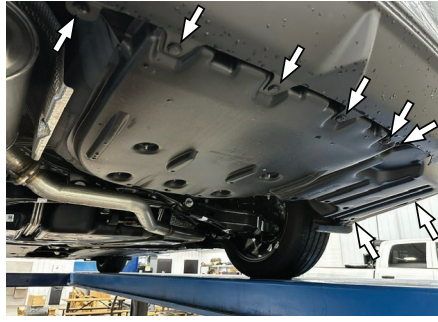

Step 2

Lower the exhaust by removing the rubber isolators (2 for FWD, 1 for AWD vehicles) and use a 12mm socket to remove the two (2) bolts securing the rearmost muffler bracket and return them to the customer.

Using a 10mm socket, remove the two (2) nuts securing the heat shield to the vehicle body. Set aside the heat shield for trimming and reinstallation.

Note: Support the exhaust during removal to prevent damage.

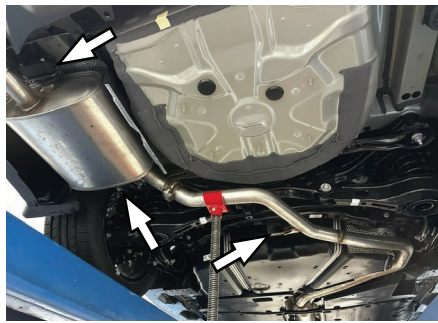

Step 3

Using a 10mm socket, remove and relocate the backup alarm.

Note: Unclip the wiring harness from the bracket before removing it.



Step 4

Using a flathead screwdriver, remove and return to the customer one (1) access hole plug per side and (2) thread plugs on the passenger side.

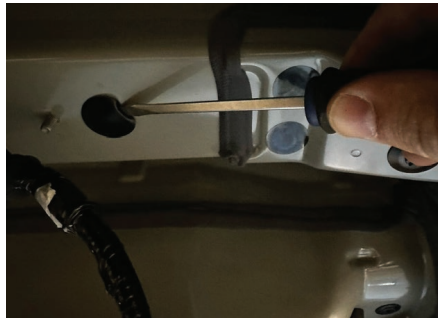

Step 5

Using a die grinder, enlarge the access holes in both frame rails.

Reverse fishwire one (1) 1/2" carriage bolt (#1) and square-hole spacer (#4) into each enlarged access hole.



Step 6

Trim the heat shield as shown in the diagram and reinstall it.

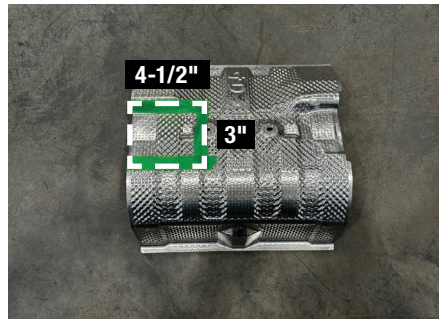

Step 7

Raise the hitch into position and secure it using the serrated-flange nuts (#3) on both frame rails. Reinstall the removed exhaust hanger using the supplied M8 flange bolts (#2). Re-install the exhaust isolator(s).

Torque M8 fasteners to 23 lb-ft.

Torque 1/2" fasteners to 110 lb-ft.



Step 8

Trim underbody panel as shown in the diagram.

Reinstall the underbody panel using the fasteners set aside in step 1.



Final Installed Image



TOWING BASICS & SAFETY INFORMATION

For information on safely towing your trailer, visit curtmfg.com/understanding-towing.