

11614

1977-1985 MERCEDES BENZ SEDAN, 123 CHASSIS, 230, 240, 280, 300  
(INCLUDING C, CE, CD, D, AND E VERSIONS)

10/21/2020

GROSS LOAD CAPACITY WHEN USED AS A WEIGHT CARRYING HITCH: 1,500 LBS. TRAILER WEIGHT & 150 LBS. TONGUE WEIGHT.

\*\*\*DO NOT EXCEED VEHICLE MANUFACTURER'S RECOMMENDED TOWING CAPACITY.\*\*\*

WARNING: ALL NON-TRAILER LOADS APPLIED TO THIS PRODUCT MUST BE SUPPORTED BY AUXILIARY STABILIZING STRAPS.

\*\* FAILURE TO PROPERLY SUPPORT NON-TRAILER LOADS WILL VOID PRODUCT WARRANTY\*\*

HAVING INSTALLATION QUESTIONS? CALL TECHNICAL SUPPORT AT 877-287-8634

Parts List			
ITEM	QTY	PART NUMBER	DESCRIPTION
1	5	10-10339	HHCS,3/8-16 UNC,1-1/4,GRD8,YZ
2	3	30-00205	WASHER,FDR,3/8,CZ
3	5	20-00166	NUT,HEX,3/8-16 UNC,GRD8,YZ
4	5	30-00130	WASHER,LOCK,3/8,YZ
5	2	30-00186	WASHER,FLAT,3/8,YZ

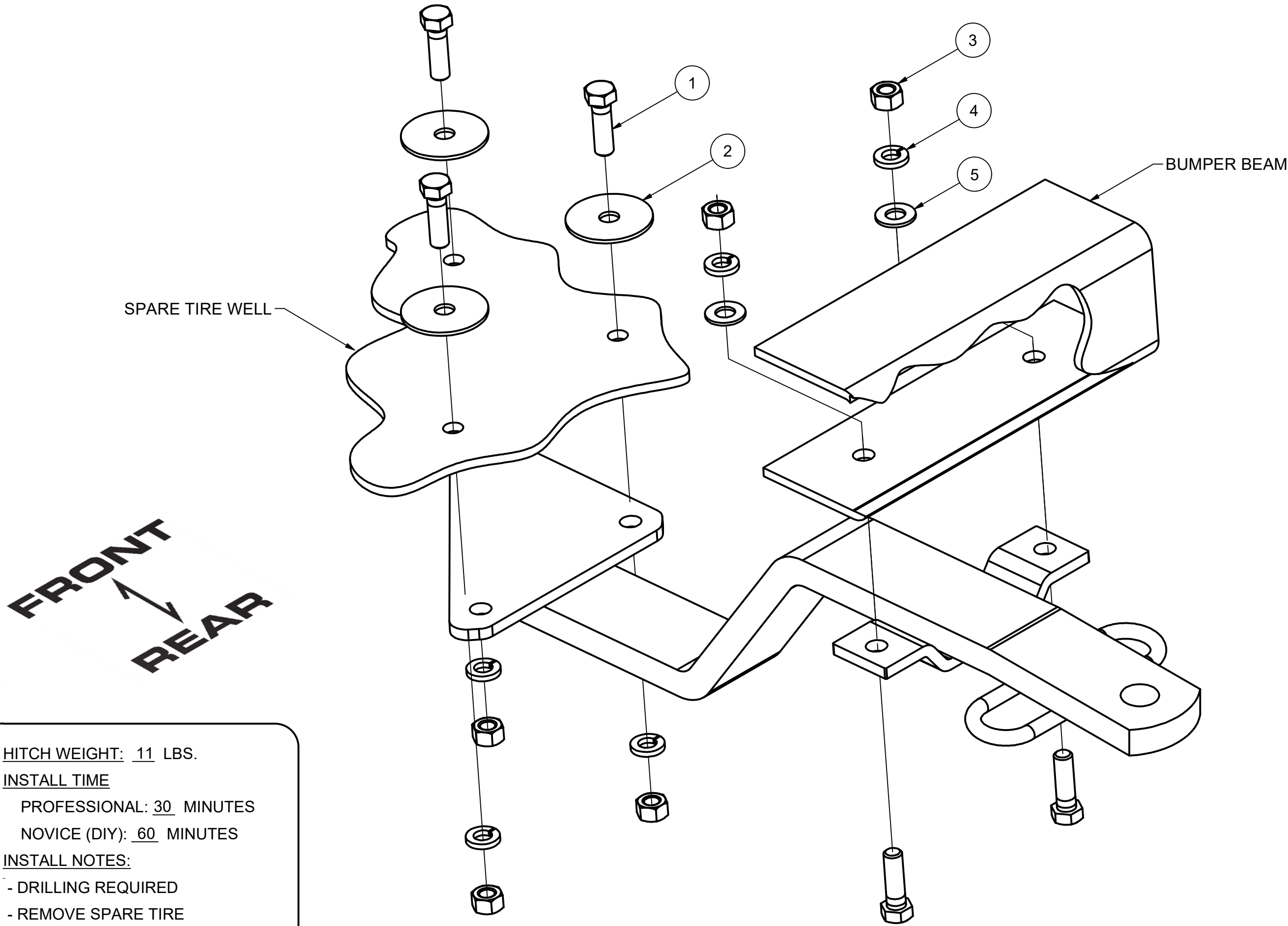

HITCH WEIGHT: 11 LBS.  
INSTALL TIME  
PROFESSIONAL: 30 MINUTES  
NOVICE (DIY): 60 MINUTES  
INSTALL NOTES:  
- DRILLING REQUIRED  
- REMOVE SPARE TIRE

INSTALLATION STEPS

1. Remove the spare tire. Position the hitch against the underside of the spare tire well and rear bumper as shown. Support the hitch in place making sure it is square and centered on car. Adjust hitch front/rear for ball to bumper clearance.
2. Using the hitch as your template, mark and drill (3) 3/8" holes in the trunk floor and (2) holes in the bottom of the rear bumper beam.
3. Secure the hitch using hardware as shown. Be certain to use fender washers inside the trunk.
4. Torque all 3/8" hardware to 45 ft-lbs.

PERIODICALLY CHECK THIS RECEIVER HITCH TO ENSURE THAT ALL FASTENERS ARE TIGHT AND THAT ALL STRUCTURAL COMPONENTS ARE SOUND.

Curt Manufacturing Inc., warrants this product to be free of defects in material and/or workmanship at the time of retail purchase by the original purchaser. If the product is found to be defective, Curt Manufacturing Inc., may repair or replace the product, at their option, when the product is returned, prepaid, with proof of purchase. Alteration to, misuse of, or improper installation of this product voids the warranty. Curt Manufacturing Inc.'s liability is limited to repair or replacement of products found to be defective, and specifically excludes liability for incidental or consequential loss or damage.