

11508**78-83 AUDI 5000****3/25/2013**

GROSS LOAD CAPACITY WHEN USED AS A WEIGHT CARRYING HITCH: 1,500 LBS. TRAILER WEIGHT & 150 LBS. TONGUE WEIGHT.

*****DO NOT EXCEED VEHICLE MANUFACTURER'S RECOMMENDED TOWING CAPACITY.*****

WARNING: ALL NON-TRAILER LOADS APPLIED TO THIS PRODUCT MUST BE SUPPORTED BY 18050 STABILIZING STRAPS.

**** FAILURE TO PROPERLY SUPPORT NON-TRAILER LOADS WILL VOID PRODUCT WARRANTY****

HAVING INSTALLATION QUESTIONS? CALL TECHNICAL SUPPORT AT 1-877-287-8634

Parts List			
ITEM	QTY	PART NUMBER	DESCRIPTION
1	6	3/8"	LOCK WASHER
2	6	3/8 - 16	HEX NUT
3	2	3/8-16 X 1 1/2	HEX BOLT
4	2	3/8"	WASHER
5	4	3/8 - 16 x 1 1/4	HEX BOLT
6	4	3/8"	FENDER WASHER

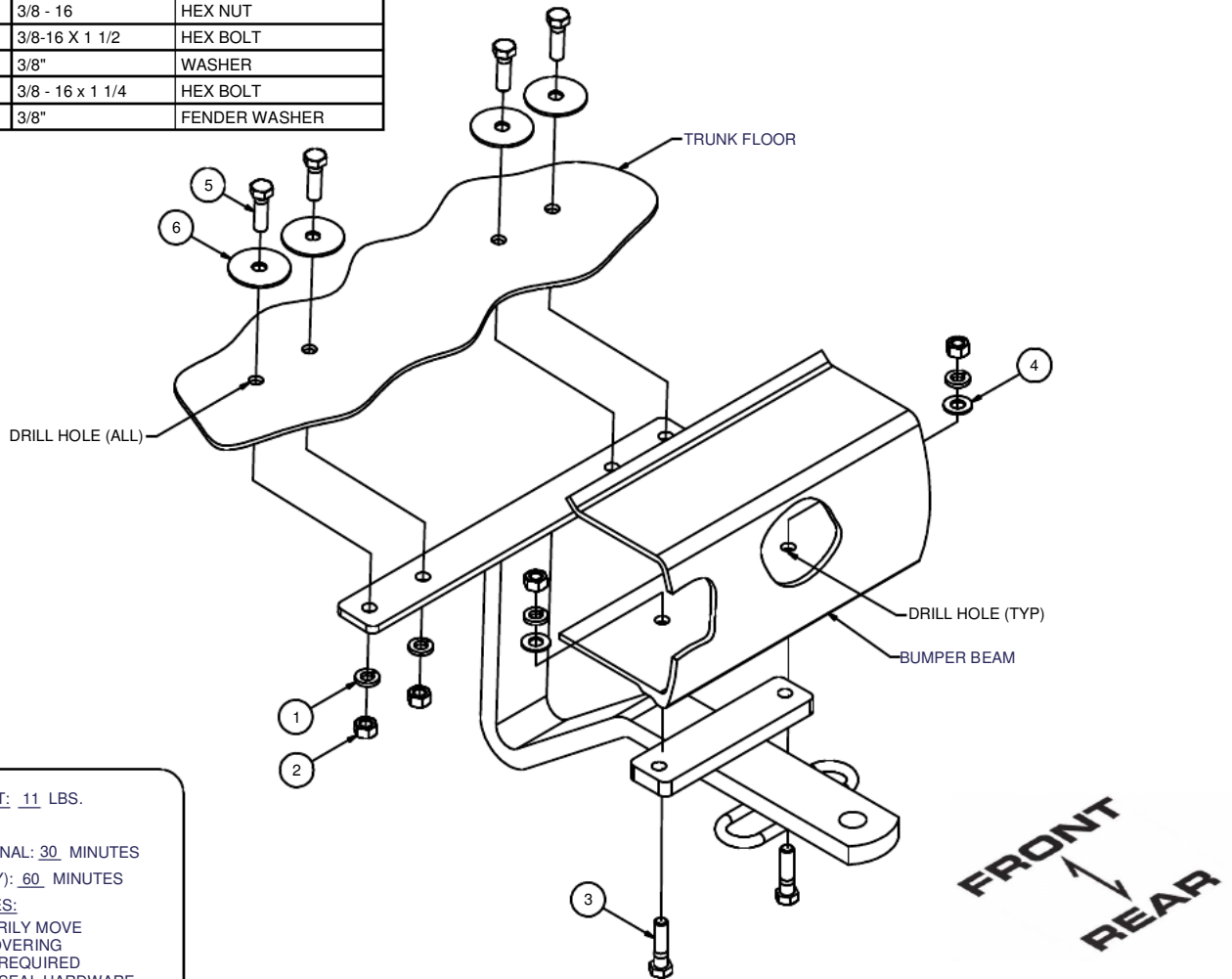

HITCH WEIGHT: 11 LBS.

INSTALL TIME

PROFESSIONAL: 30 MINUTES

NOVICE (DIY): 60 MINUTES

INSTALL NOTES:

- TEMPORARILY MOVE FLOOR COVERING
- DRILLING REQUIRED
- SILICONE SEAL HARDWARE

INSTALLATION STEPS

1. Lift the floor covering at the rear of the vehicle's cargo compartment / trunk.
2. Position the hitch against the underside of the floor and the bumper beam, centered and square with the vehicle. Use the hitch as a template to mark four holes on the trunk floor and two places on the bumper beam for the fasteners. Centerpunch and drill these holes for 3/8" fasteners.
3. Bolt the hitch to the floor and the bumper beam as shown. Use fasteners with fender washers inside the trunk, opposite the hitch. Bolt the hitch to the bumper beam as shown.
4. Use silicone sealant to seal hardware installed through truck floor.
5. Reposition the floor covering.
6. Torque all 3/8" fasteners to 45 lb-ft.

PERIODICALLY CHECK THIS RECEIVER HITCH TO ENSURE THAT ALL FASTENERS ARE TIGHT AND THAT ALL STRUCTURAL COMPONENTS ARE SOUND.

Curt Manufacturing Inc., warrants this product to be free of defects in material and/or workmanship at the time of retail purchase by the original purchaser. If the product is found to be defective, Curt Manufacturing Inc., may repair or replace the product, at their option, when the product is returned, prepaid, with proof of purchase. Alteration to, misuse of, or improper installation of this product voids the warranty. Curt Manufacturing Inc.'s liability is limited to repair or replacement of products found to be defective, and specifically excludes liability for incidental or consequential loss or damage.