

11339

2005 JAGUAR X-TYPE SEDAN

10/01/2020

GROSS LOAD CAPACITY WHEN USED AS A WEIGHT CARRYING HITCH: 2,000 LBS. TRAILER WEIGHT & 200 LBS. TONGUE WEIGHT.
*****DO NOT EXCEED VEHICLE MANUFACTURER'S RECOMMENDED TOWING CAPACITY.*****

Parts List			
ITEM	QTY	PART NUMBER	DESCRIPTION
1	2	10-10234	HHCS,3/8-16 UNC,1-1/2,GRD8,YZ
2	4	30-00205	WASHER,FDR,3/8,CZ
3	4	10-10481	HHCS,3/8-16 UNC,1,GRD8,YZ
4	4	10-10282	BOLT,CAR,7/16-14 UNC,1-1/2,GRD8,YZ
5	6	3/8-16	NUT,SER-FLANGE,3/8-16 UNC,GRD8,YZ
6	2	30-00186	WASHER,FLAT,3/8,YZ
7	4	20-00103	NUT,SER-FLANGE,7/16-14 UNC,GRD8,YZ
8	2	CM-11339-BP	.250 BACKING PLATE

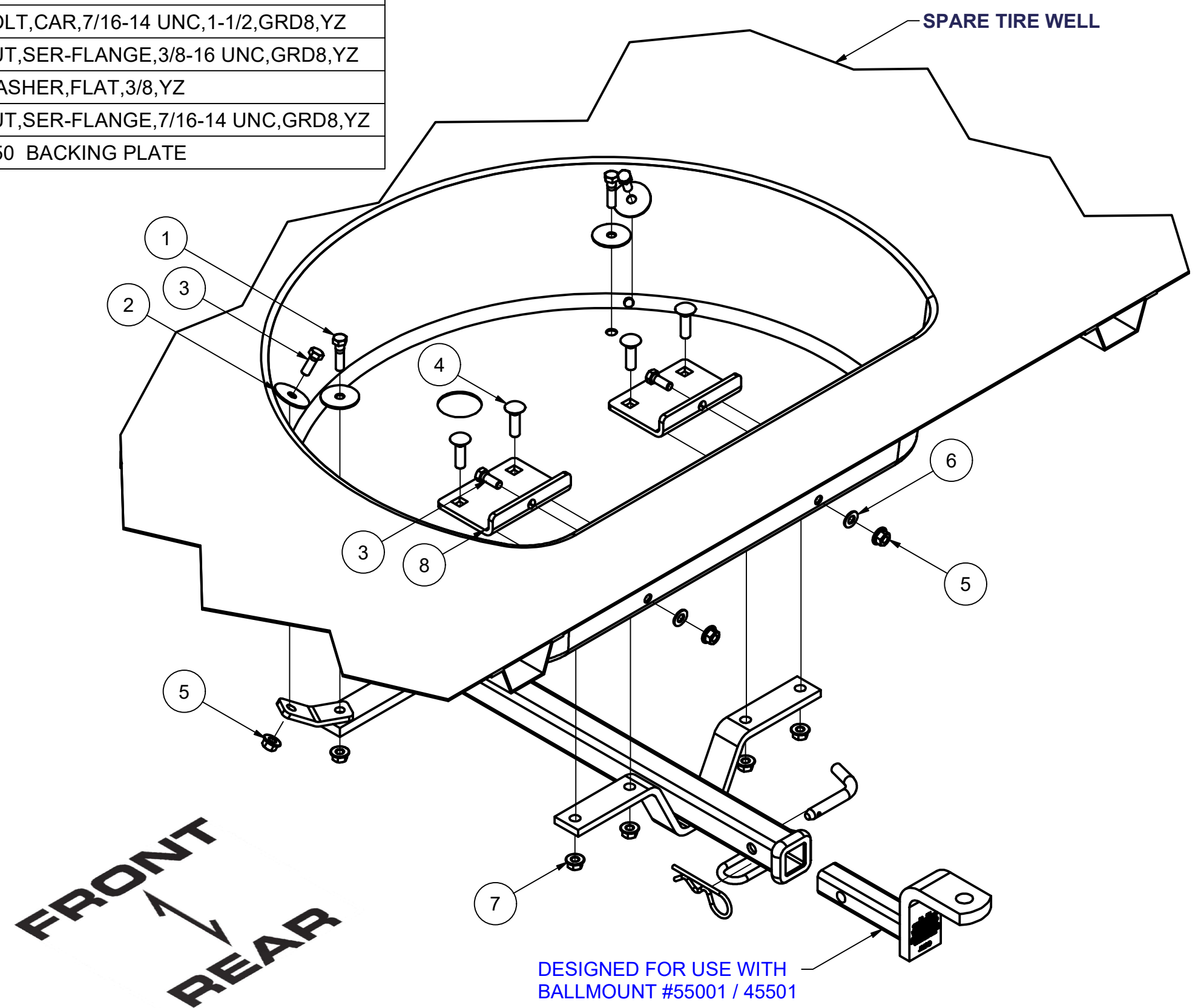
HITCH WEIGHT: 21 LBS.INSTALL TIME: 60 MINUTES

INSTALL NOTES:

- DRILLING REQUIRED
- REMOVE SPARE TIRE

INSTALLATION STEPS

- 1) Remove spare tire/jack from trunk and clear tire well to metal pan.
 - 2) Place backing plates in spare tire well, and space them apart by measuring the hole spacing on the front strap of the hitch (backing plates must also be against side of trunk pan for horizontal mounting bolts). Using backing plates as templates, mark out 2 holes on trunk pan.
 - 3) Drill out 2 holes in trunk pan, install carriage bolts through backing plates. Raise hitch into position and install flange nuts. Drill holes through trunk pan using the hitch as a template, and install carriage bolts with flange nuts.
 - 4) Drill remaining holes in trunk pan using either the hitch or backing plates as templates where possible. Remove hitch and backing plates from vehicle and using a silicone caulk, run a bead around every drilled hole inside the spare tire well.
- (NOTE: Process is required for all holes to align in trunk pan, hitch, and backing plates.)
- 5) Re-install hitch and backing plates onto vehicle with all the supplied fasteners as shown.
 - 6) Torque all 3/8" fasteners to 45 lb-ft and all 7/16" fasteners to 70 lb-ft.
 - 7) Re-install spare tire and jack.

PERIODICALLY CHECK THIS RECEIVER HITCH TO ENSURE THAT ALL FASTENERS ARE TIGHT AND THAT ALL STRUCTURAL COMPONENTS ARE SOUND.

Curt Manufacturing Inc., warrants this product to be free of defects in material and/or workmanship at the time of retail purchase by the original purchaser. If the product is found to be defective, Curt Manufacturing Inc., may repair or replace the product, at their option, when the product is returned, prepaid, with proof of purchase. Alteration to, misuse of, or improper installation of this product voids the warranty. Curt Manufacturing Inc.'s liability is limited to repair or replacement of products found to be defective, and specifically excludes liability for incidental or consequential loss or damage.