

11246

00-05 MITSUBISHI ECLIPSE

10/14/2020

GROSS LOAD CAPACITY WHEN USED AS A WEIGHT CARRYING HITCH: 2,000 LBS. TRAILER WEIGHT & 200 LBS. TONGUE WEIGHT.

\*\*\*DO NOT EXCEED VEHICLE MANUFACTURER'S RECOMMENDED TOWING CAPACITY.\*\*\*

WARNING: ALL NON-TRAILER LOADS APPLIED TO THIS PRODUCT MUST BE SUPPORTED BY AUXILIARY STABILIZING STRAPS.

\*\* FAILURE TO PROPERLY SUPPORT NON-TRAILER LOADS WILL VOID PRODUCT WARRANTY\*\*

HAVING INSTALLATION QUESTIONS? CALL TECHNICAL SUPPORT AT 877-287-8634

Parts List			
ITEM	QTY	PART NUMBER	DESCRIPTION
1	6	10-10481	HHCS,3/8-16 UNC,1,GRD8,YZ
2	6	30-00205	WASHER,FDR,3/8,CZ
3	8	30-00130	WASHER,LOCK,3/8,YZ
4	8	20-00166	NUT,HEX,3/8-16 UNC,GRD8,YZ
5	2	10-10234	HHCS,3/8-16 UNC,1-1/2,GRD8,YZ
6	2	30-00186	WASHER,FLAT,3/8,YZ
7	1	CM-11246-BP	1.500 x .250" SPACER

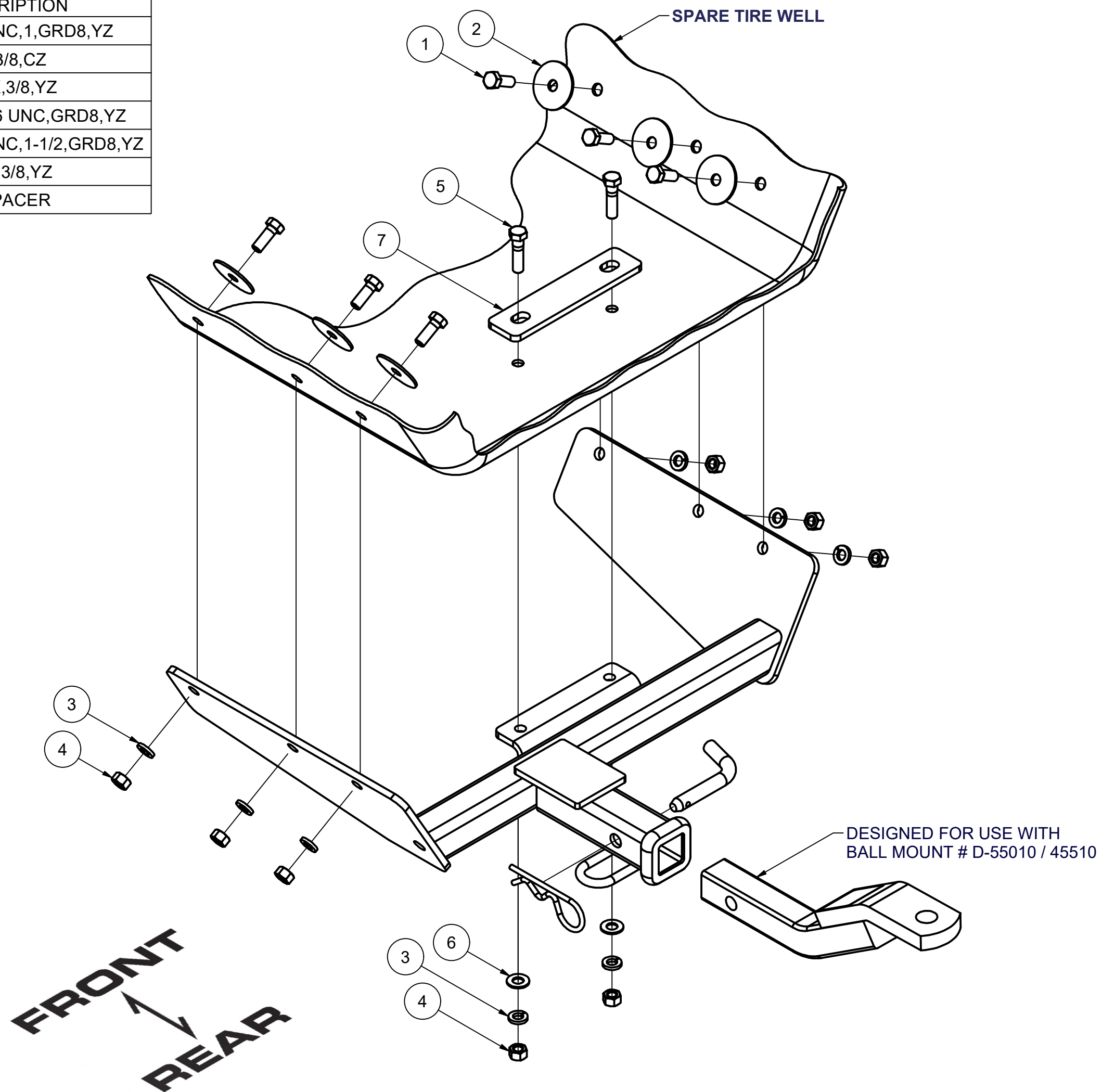

HITCH WEIGHT: 23 LBS.  
 INSTALL TIME  
 PROFESSIONAL: 45 MINUTES  
 NOVICE (DIY): 90 MINUTES  
 INSTALL NOTES:  
 -DRILLING REQUIRED

**INSTALLATION STEPS**

1. This hitch mounts to the tapered sides of the car's spare tire well. One additional hitch bracket mounts to the bottom of the tire well with a 1 1/2" x 6 1/2" backing plate inside the tire well.
2. Clear the car's spare tire well of contents for drilling. Position the hitch on the tire well as shown. The hitch should fit as far to the rear of the well as possible, still allowing room for the hitch bracket to fit to the flat part of the well bottom. Mark the tire well for eight (8) holes.
3. Centerpunch and drill the tire well eight places for 3/8" diameter screws. Mount the hitch to the tire well using fasteners and backing plate as shown. Screws, backing plate and large fender washers should fit INSIDE the tire well.
4. Torque all 3/8" fasteners to 45 lb-ft.

**PERIODICALLY CHECK THIS RECEIVER HITCH TO ENSURE THAT ALL FASTENERS ARE TIGHT AND THAT ALL STRUCTURAL COMPONENTS ARE SOUND.**

Curt Manufacturing Inc., warrants this product to be free of defects in material and/or workmanship at the time of retail purchase by the original purchaser. If the product is found to be defective, Curt Manufacturing Inc., may repair or replace the product, at their option, when the product is returned, prepaid, with proof of purchase. Alteration to, misuse of, or improper installation of this product voids the warranty. Curt Manufacturing Inc.'s liability is limited to repair or replacement of products found to be defective, and specifically excludes liability for incidental or consequential loss or damage.