

11237

## 95-98 MAZDA PROTEGE SEDAN

12/5/2012

GROSS LOAD CAPACITY WHEN USED AS A WEIGHT CARRYING HITCH: 2,000 LBS. TRAILER WEIGHT &amp; 200 LBS. TONGUE WEIGHT.

\*\*\*DO NOT EXCEED VEHICLE MANUFACTURER'S RECOMMENDED TOWING CAPACITY.\*\*\*

WARNING: ALL NON-TRAILER LOADS APPLIED TO THIS PRODUCT MUST BE SUPPORTED BY AUXILIARY STABILIZING STRAPS.

\*\* FAILURE TO PROPERLY SUPPORT NON-TRAILER LOADS WILL VOID PRODUCT WARRANTY\*\*

HAVING INSTALLATION QUESTIONS? CALL TECHNICAL SUPPORT AT 1-877-287-8634

## FISHWIRE TECHNIQUE

INSERT COILED END OF FISHWIRE TOOL THROUGH HITCH MOUNTING HOLE IN VEHICLE FRAME RAIL AND OUT THE ACCESS HOLE. PASS COILED END OF FISHWIRE THROUGH SPACER AND THREAD BOLT INTO COIL. KINK WIRE TO KEEP SPACER SEPERATE FROM BOLT AS SHOWN. PULL FISHWIRE, SPACER, AND BOLT THROUGH FRAME AND OUT MOUNTING HOLE. USE FISHWIRE TO GUIDE HITCH DURING MOUNTING AND PREVENT LOSS OF BOLT / SPACER INSIDE FRAME RAIL.

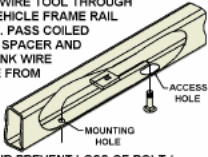

\*\*NOTE: SOME VEHICLES MAY FISHWIRE THROUGH END OF FRAME\*\*

| Parts List |     |                  |                           |
|------------|-----|------------------|---------------------------|
| ITEM       | QTY | PART NUMBER      | DESCRIPTION               |
| 1          | 4   | 7/16-14 x 1 1/2  | CARRIAGE BOLT             |
| 2          | 4   | 7/16 LOCK WASHER | HELICAL LOCK WASHER       |
| 3          | 4   | 7/16-14          | HEX NUT                   |
| 4          | 1   | 3/8 - 16 x 1 3/4 | HEX BOLT                  |
| 5          | 3   | 3/8 - 16 x 1 1/4 | HEX BOLT                  |
| 6          | 4   | 3/8"             | LOCK WASHER               |
| 7          | 4   | 3/8 - 16         | HEX NUT                   |
| 8          | 1   | CM-11237-TB      | .250" TAIL BRACKET        |
| 9          | 1   | CM-438-FW        | 7/16 " FISHWIRE TOOL      |
| 10         | 4   | CM-SP108         | 2.00 X 0.88 X .125 SPACER |

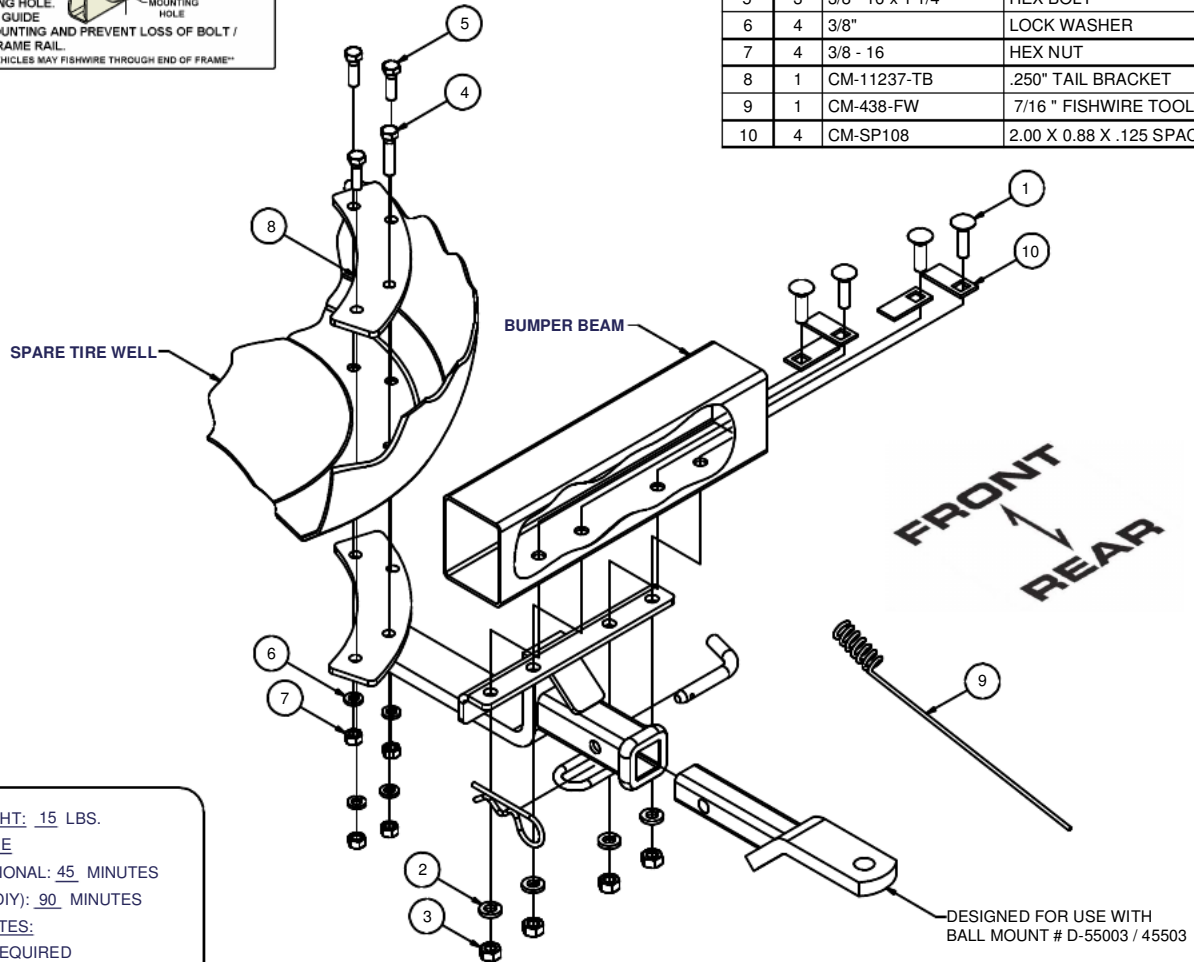

HITCH WEIGHT: 15 LBS.

## INSTALL TIME

PROFESSIONAL: 45 MINUTES

NOVICE (DIY): 90 MINUTES

## INSTALL NOTES:

DRILLING REQUIRED

## INSTALLATION STEPS

1. This hitch mounts to the bottom of the bumper, and to the bottom of the spare tire well.
2. Temporarily remove the spare tire and clear the tire well. Remove two phillips fascia screws on the bumper.
3. Lift the hitch into position on the car and check for center. Using the hitch as a template, drill the bumper and spare tire well for fasteners as shown.
4. Using the fishwire method, Install fasteners as shown. Access is from the bumper ends. Also, install fasteners as shown in spare tire well.
5. Torque all 3/8" fasteners to 45 lb-ft, and all 7/16" fasteners to 70 lb-ft.

**PERIODICALLY CHECK THIS RECEIVER HITCH TO ENSURE THAT ALL FASTENERS ARE TIGHT AND THAT ALL STRUCTURAL COMPONENTS ARE SOUND.**

Curt Manufacturing Inc., warrants this product to be free of defects in material and/or workmanship at the time of retail purchase by the original purchaser. If the product is found to be defective, Curt Manufacturing Inc., may repair or replace the product, at their option, when the product is returned, prepaid, with proof of purchase. Alteration to, misuse of, or improper installation of this product voids the warranty. Curt Manufacturing Inc.'s liability is limited to repair or replacement of products found to be defective, and specifically excludes liability for incidental or consequential loss or damage.