

11201

90-93 HONDA ACCORD 2 & 4 DR

10/16/2020

GROSS LOAD CAPACITY WHEN USED AS A WEIGHT CARRYING HITCH: 2,000 LBS. TRAILER WEIGHT & 200 LBS. TONGUE WEIGHT.

*****DO NOT EXCEED VEHICLE MANUFACTURER'S RECOMMENDED TOWING CAPACITY.*****

WARNING: ALL NON-TRAILER LOADS APPLIED TO THIS PRODUCT MUST BE SUPPORTED BY 18050 STABILIZING STRAPS.

**** FAILURE TO PROPERLY SUPPORT NON-TRAILER LOADS WILL VOID PRODUCT WARRANTY****

HAVING INSTALLATION QUESTIONS? CALL TECHNICAL SUPPORT AT 877-287-8634

Parts List			
ITEM	QTY	PART NUMBER	DESCRIPTION
1	2	10-10282	BOLT,CAR,7/16-14 UNC,1-1/2,GRD8,YZ
2	6	30-00166	WASHER,FLAT,7/16,YZ
3	6	30-00184	WASHER,LOCK,7/16,YZ
4	2	20-00147	NUT,HEX,7/16-14 UNC,GRD8,YZ
5	4	10-10271	HHCS,M10x1.25,30,CL10.9,YZ
6	2	CM-SP40	.188 x 1.00 x 3.00" SQUARE HOLE SPACER
7	1	7_16 FISHWIRE	7/16" FISHWIRE

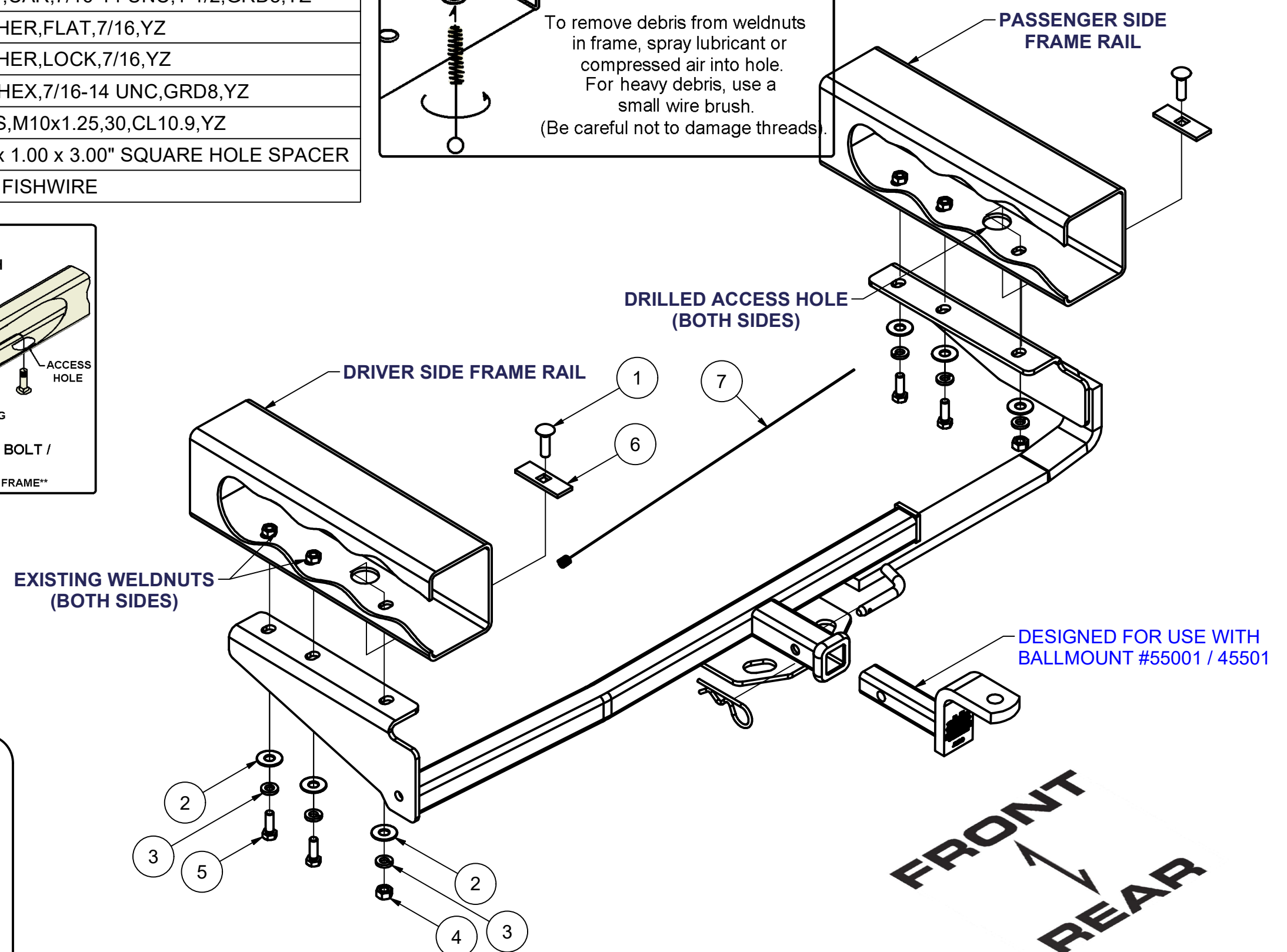
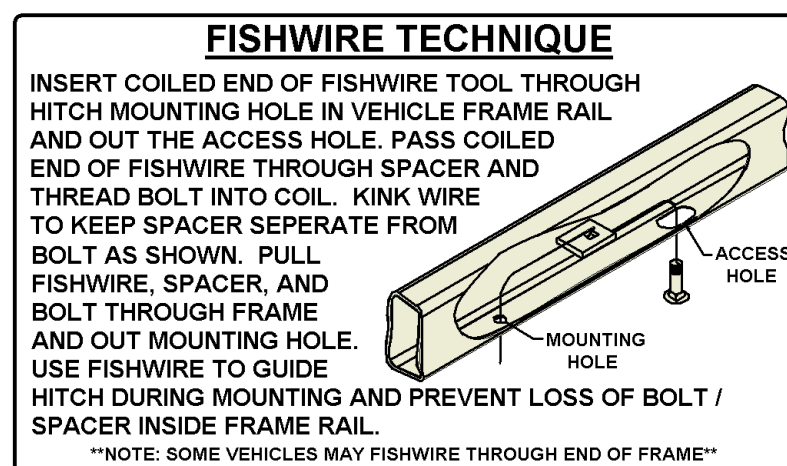
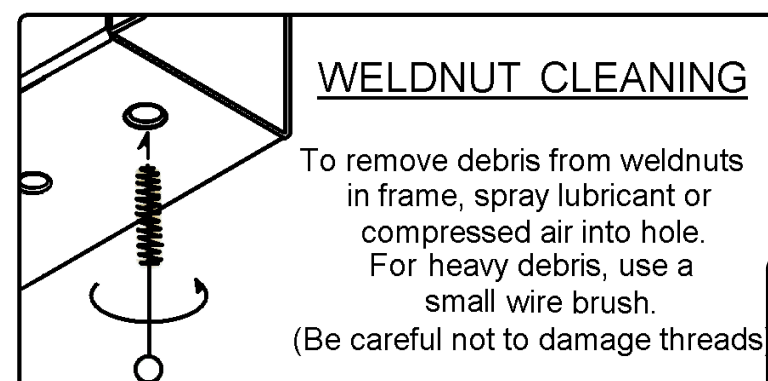

HITCH WEIGHT: 33 LBS.

INSTALL TIME

PROFESSIONAL: 45 MINUTES

NOVICE (DIY): 90 MINUTES

INSTALL NOTES:

- DRILLING REQUIRED

INSTALLATION STEPS

1. Locate the driver and passenger side frame rails under the rear of the vehicle. Remove the tie down brackets from both frame rails, (2 10mm screws each) and plastic shield at the rear corner of the rails. Use a phillips screw driver and pry plastic expansion plug out. Also, remove the bolt fastening the muffler heat shield at the bottom of the passenger side frame rail. Return all parts to the vehicle's owner for reinstallation should the hitch ever be removed. Hammer the heat shield flat against the frame rail. Heat shield will be between the hitch and the frame.
2. Lift the hitch into position on the frame rails. Fasten the hitch to the frame rails at front (2) holes. With the hitch bolted in position, use the hitch as a template to drill holes in frame rails for 7/16" diameter bolts. Remove the hitch from the vehicle.
3. Using a 1 1/4" hole saw, make (1) access hole in the bottom surface of each frame rail as shown above, so it will be covered with the hitch when it is installed. These holes provide access to fishwire 7/16" carriage bolts and CM-SP40 backing plates into the frame rails.
4. Reinstall the hitch on the vehicle, being careful not to push the carriage bolts out. Install fasteners as shown above.
5. Torque all 7/16" fasteners to 70 lb-ft, and all 10mm fasteners to 48 lb-ft.

PERIODICALLY CHECK THIS RECEIVER HITCH TO ENSURE THAT ALL FASTENERS ARE TIGHT AND THAT ALL STRUCTURAL COMPONENTS ARE SOUND.

Curt Manufacturing Inc., warrants this product to be free of defects in material and/or workmanship at the time of retail purchase by the original purchaser. If the product is found to be defective, Curt Manufacturing Inc., may repair or replace the product, at their option, when the product is returned, prepaid, with proof of purchase. Alteration to, misuse of, or improper installation of this product voids the warranty. Curt Manufacturing Inc.'s liability is limited to repair or replacement of products found to be defective, and specifically excludes liability for incidental or consequential loss or damage.