

11185

96-00 CHRYSLER SEBRING CONVERTIBLE

10/12/2012

GROSS LOAD CAPACITY WHEN USED AS A WEIGHT CARRYING HITCH: 2,000 LBS. TRAILER WEIGHT & 200 LBS. TONGUE WEIGHT.

DO NOT EXCEED VEHICLE MANUFACTURER'S RECOMMENDED TOWING CAPACITY.

WARNING: ALL NON-TRAILER LOADS APPLIED TO THIS PRODUCT MUST BE SUPPORTED BY AUXILIARY STABILIZING STRAPS.

** FAILURE TO PROPERLY SUPPORT NON-TRAILER LOADS WILL VOID PRODUCT WARRANTY**

HAVING INSTALLATION QUESTIONS? CALL TECHNICAL SUPPORT AT 1-800-798-0813

Parts List			
ITEM	QTY	PART NUMBER	DESCRIPTION
1	4	7/16-14 x 1 1/4	CARRIAGE BOLT
2	4	CM-SP11	.250 x 1.00 x 2.50" SQUARE HOLE SPACER
3	1	M10 - 1.5 x 35mm	HEX TAP BOLT
4	1	3/8"	CONICAL TOOTHED WASHER
5	4	7/16-14	HEX FLANGE NUT
6	2	CM-438-FW	7/16" FISHWIRE TOOL

TOOLS REQUIRED
 17mm AND 11/16" SOCKETS
 12" EXTENSION
 RATCHET
 TORQUE WRENCH

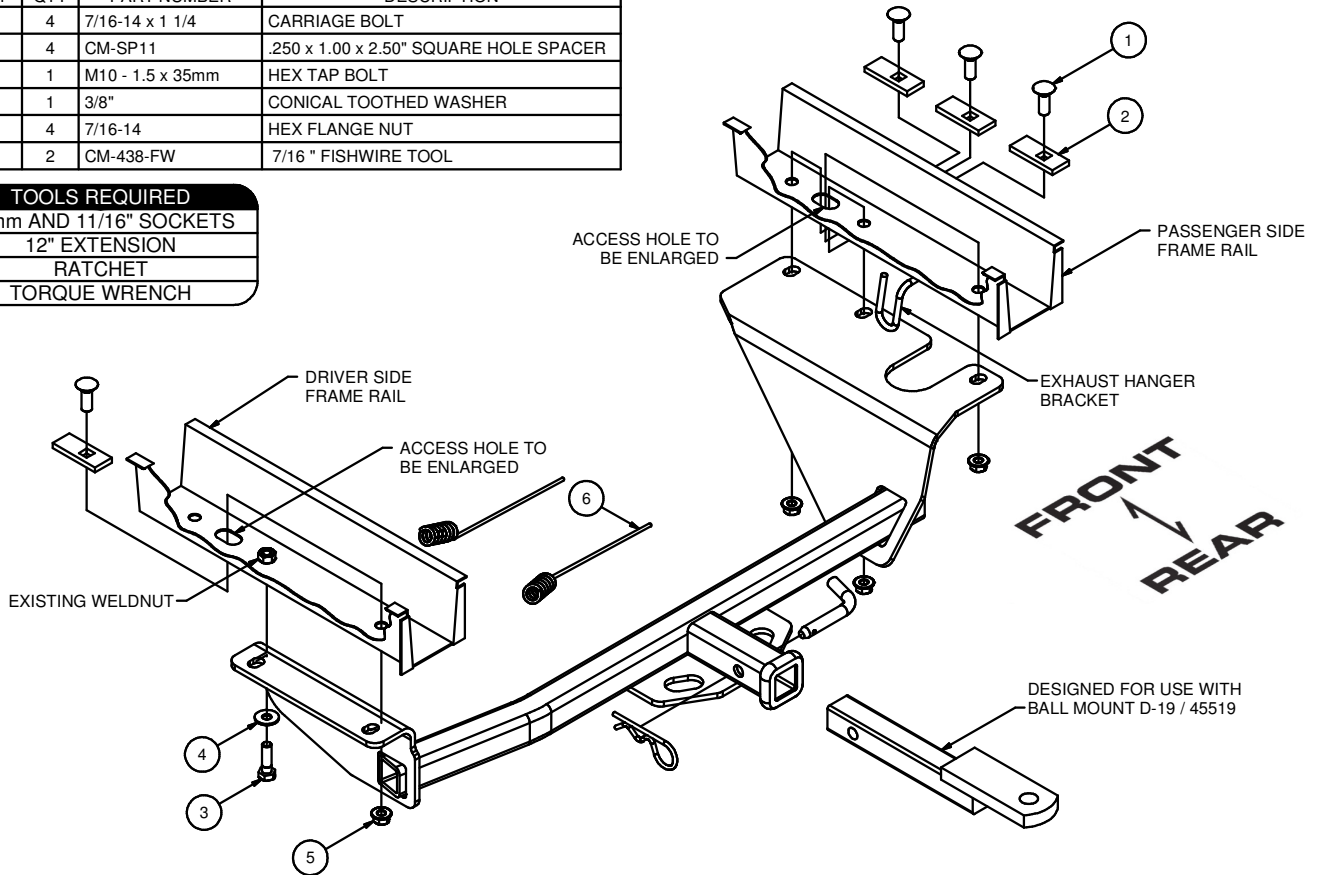

HITCH WEIGHT: 25 LBS.

INSTALL TIME

PROFESSIONAL: 30 MINUTES

NOVICE (DIY): 60 MINUTES

INSTALL NOTES:

-FISHWIRE HARDWARE

-ENLARGE EXISTING HOLES

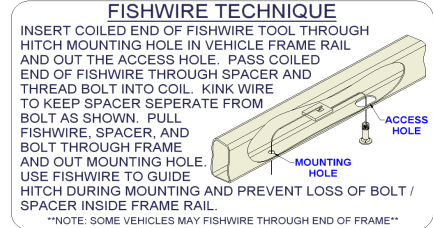
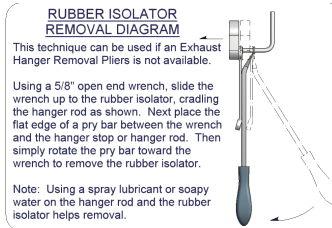

INSTALLATION STEPS

- 1) Lower the exhaust system by disconnecting the rubber exhaust hangers from the exhaust hanger bracket.
- 2) Enlarge the access hole in frame and fishwire block and bolt assemblies into the frame rail as shown.
- 3) Raise the hitch into position and install the 10mm bolt provided into existing weld nut.
- 4) Torque all 7/16" fasteners to 70 ft-lbs. Torque all 10mm fasteners to 45 ft-lbs.

PERIODICALLY CHECK THIS RECEIVER HITCH TO ENSURE THAT ALL FASTENERS ARE TIGHT AND THAT ALL STRUCTURAL COMPONENTS ARE SOUND.

Curt Manufacturing Inc., warrants this product to be free of defects in material and/or workmanship at the time of retail purchase by the original purchaser. If the product is found to be defective, Curt Manufacturing Inc., may repair or replace the product, at their option, when the product is returned, prepaid, with proof of purchase. Alteration to, misuse of, or improper installation of this product voids the warranty. Curt Manufacturing Inc.'s liability is limited to repair or replacement of products found to be defective, and specifically excludes liability for incidental or consequential loss or damage.