

INSTALLATION MANUAL

206720

Level of Difficulty

Easy

Installation difficulty levels are based on time and effort involved and may vary depending on the installer level of expertise, condition of the vehicle and proper tools and equipment.

Parts List

Qty	Description
1	Driver / left mounting bracket
1	Passenger / right mounting bracket
2	Tow hook mounting bracket
2	Spacer, Mounting bracket
2	Hex bolt, 7/8"-9 x 3"
2	Hex bolt, 7/8"-9 x 3-1/2"
2	Hex bolt, 5/8"-11 x 1-3/4"
2	Shoulder bolt, 5/8" x 7/8" x 1/2"-13
2	Lock washer, 7/8"
2	Flat washer, 5/8"
4	Belleville washer, .63" x 1.25" x .04" x .042"
2	Nylock nut, 5/8"-11
2	Nylock nut, 1/2"-13

Tools Required

Ratchet	Socket, 15/16"
Torque wrench	Socket, 1-5/16"
Wrench, 15/16"	Socket, 3/4"
Allen wrench, 5/16"	--

Torque Specifications

1/2" bolt	65 ft-lbs.
5/8" bolt	128 ft-lbs.
3/4" bolt	228 ft-lbs.
7/8" bolt	322 ft-lbs.

Use above torque setting unless otherwise noted

Product Photo

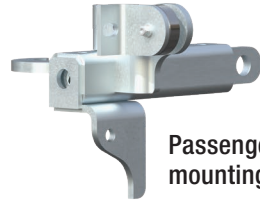

Passenger / right mounting bracket

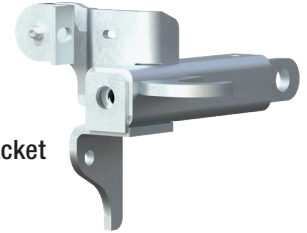

Driver / left mounting bracket

NOTICE

Visit www.retracmirrors.com for a full-color copy of this instruction manual, as well as helpful videos, guides and much more!

Before you begin installation, read all instructions thoroughly.

Proper tools will improve the quality of installation and reduce the time required.

Periodic inspection of your product should be performed to ensure all hardware and / or components remain secure.

To help prevent damage to the product or vehicle, refer to the specified torque specifications when securing hardware during the installation process.

CAUTION

Strong magnets may produce pinch hazards. They can also cause interference with pacemakers and other sensitive electronics.

Maintenance

After the first 1000 miles, check the 7/8"-9 mounting bolts to ensure they are tight. Re-torque if necessary.

Mild automotive detergent may be used to clean the product. Do not use dish detergent, abrasive cleaners, abrasive pads, wire brushes or other similar products that may damage the finish.

Step 1

Remove the factory tow hook pins if installed. Insert the tow hook mounting bracket into the tow hook opening and secure with factory tow hook pin.

Note: For Peterbilt 587, install the mounting bracket spacers onto the end of the mounting bracket bars before inserting into the tow hook receivers

Step 2

Slide a mounting bracket over each tow hook mounting bracket and secure with a 7/8"-9 x 3" bolt (3-1/2" bolt for Peterbilt 587) with 7/8" lock washer.

Keep the bracket square on the truck and tighten with the 1-5/16" socket.

Note: Passenger side shown.

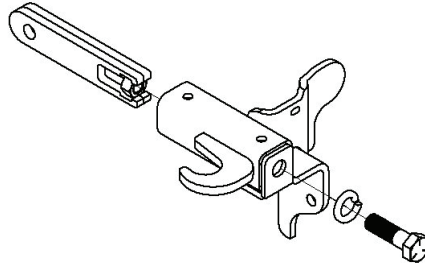

Step 3

Using the 5/16" allen wrench and 3/4" socket, install the guard onto the mounting brackets with the 5/8" x 7/8" shoulder bolts, .63 x 1.25 x .040 x .082 belleville washers (large diameter to the guard bracket face) and 1/2"-3 nylock nuts using the bottom holes.

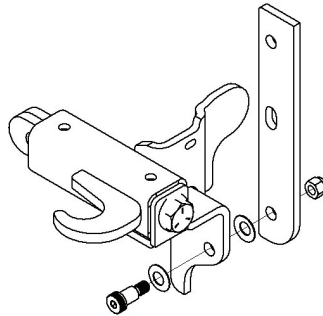

Step 4

Using a 15/16" socket and wrench, attach the magnet bracket assemblies to the mounting bracket of the grille guard with the 5/8"-11 x 1-3/4" bolts, 5/8" flat washer and 5/8"-11 nylock nuts. The safety pin bracket must be on the driver side.

Note: Magnets and brackets are pre-assembled, some adjustment may be necessary after the grille guard is installed on the truck.

