

INSTALLATION INSTRUCTIONS AND PARTS LIST

MODEL 583036, 584036 O-MEGA II 6" OVAL STEPS

1. READ INSTRUCTIONS COMPLETELY AND CHECK TO MAKE SURE THAT ALL REQUIRED PARTS (LISTED ON THE SERVICE PARTS LIST) ARE ON HAND BEFORE STARTING THE INSTALLATION.
2. FOLLOW THE INSTRUCTIONS INCLUDED WITH THE SPECIFIC BRACKET PACKAGE THAT YOU ARE USING, TO MOUNT THE BRACKETS TO YOUR VEHICLE.
3. BEFORE ATTACHING THE O-MEGA STEPS TO THE BRACKETS, PLACE THE STEP PADS (ITEM #2) ON TOP OF THE STEP PLATES ACCORDINGLY FOR YOUR VEHICLE. USING THE HOLES IN THE STEP PAD AS A GUIDE DRILL (5) 1/8" PILOT HOLES. ATTACH WITH (5) 8-18X1/2" TEK SCREWS (ITEM #6) PROVIDED. REPEAT FOR ALL STEP PADS.
4. INSTALL THE REQUIRED NUMBER OF SQUARE HEAD SCREWS (ITEM#4) INTO THE DESIGNATED SLOTS IN THE BOTTOM OF THE STEP PLATES.
5. INSTALL THE END CAPS (ITEM #3) AS SHOWN IN (FIG.1), TIGHTENING THE SERRATED NUTS (ITEM#5) TO 5 LB FT.
6. POSITION THE O-MEGA STEP ON THE MOUNTING BRACKETS SO THAT THE SQUARE HEAD SCREWS (ITEM #4) ARE LOCATED IN THE SLOTS OF THE MOUNTING BRACKETS AND THE STEP IS CENTERED, FRONT TO REAR, ON THE VEHICLE. INSTALL 5/16" SERRATED FLANGE NUTS (ITEM #5) ON THE SQUARE HEAD SCREWS (ITEM #4) AND TIGHTEN TO 19 LB FT.

SERVICE PARTS LIST

ITEM	PART NO.	QTY	DESCRIPTION
1	553068	2	EXTRUSION-AL,33.00"OMEGA, SILVER
1	553056	2	EXTRUSION-AL,33.00"OMEGA, BLACK
2	552970	2	ALUM, STP-PAD, BLK, OMEGA-STEP
3	107956	4	CAP-END,PLSTC,2.95 X 6.70
4	106880	16	SCREW-SQ HD,5/16-18 X 1,MAGNIGUARD
5	102680	16	NUT-SERR FLG,HX,SST,WX,5/16-18
6	107958	10	SCREW-PPH,TEK,#8-18 X 1/2",SST,BZP



SERVICE PARTS LIST

BRACKET NO. - 583036/584036

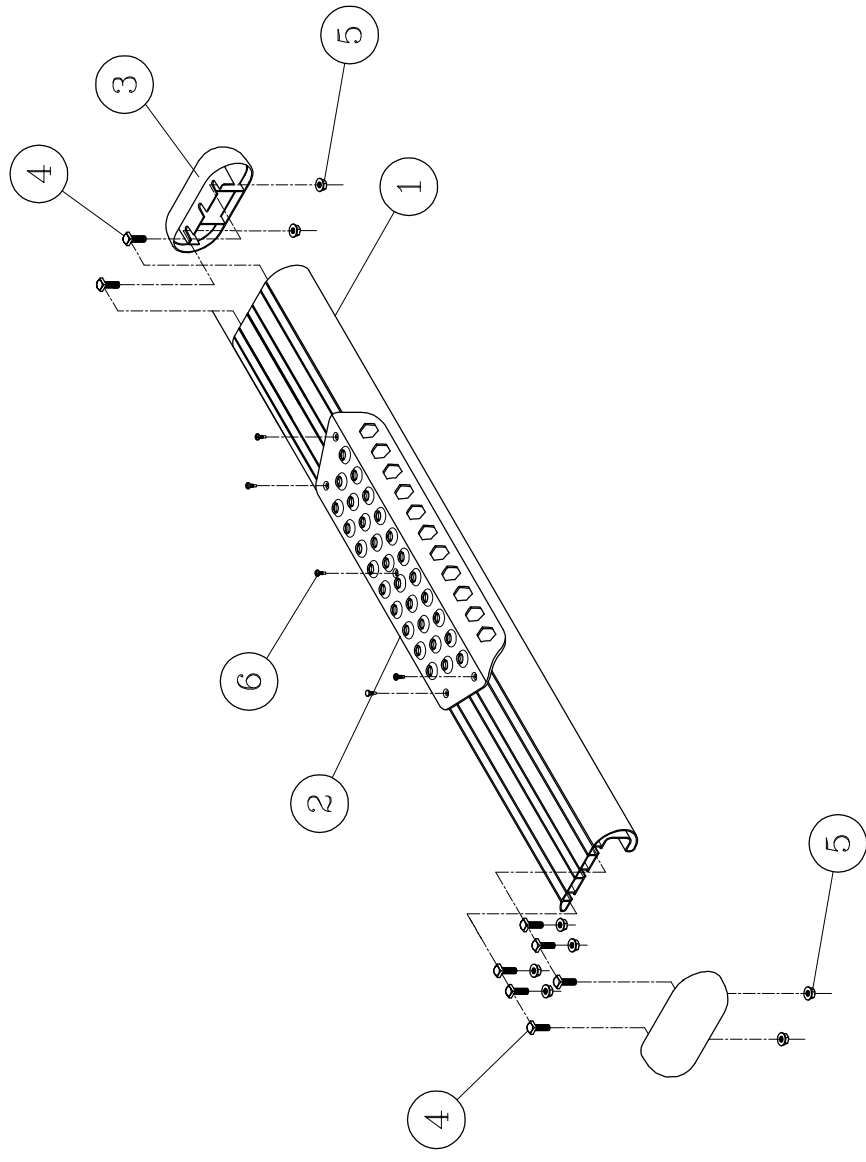

fig.1



INSTALLATION INSTRUCTIONS AND PARTS LIST

FOR MOUNTING 401520/571520 GRIP STEPS/MEGA-OMEGA STEPS,
SHORT/SHORT, 2015-NEWER FORD TRANSIT VANS.

READ INSTRUCTIONS COMPLETELY AND CHECK TO MAKE SURE THAT ALL REQUIRED PARTS
(LISTED ON SERVICE PARTS LIST) ARE ON HAND BEFORE STARTING THE INSTALLATION.

PASSENGER SIDE INSTALLATION

1. MEASURE FROM THE REAR OF THE FRONT FENDER OPENING, AND MARK THE PINCH WELD FOR DRILLING THE FRONT HOLE OF EACH BRACKET AS SHOWN IN FIG. 3. AND THE REAR HOLE OF EACH BRACKET, REAR HOLE DISTANCE IS 3" FROM THE FRONT HOLE.
2. DRILL 11/32" HOLE IN EACH OF THE LOCATIONS MARKED OUT ON THE PINCHWELD.

NOTE: SLIDE A FLAT PIECE OF METAL SUCH AS A PUTTY KNIFE BETWEEN THE PINCHWELD, AND THE PLASTIC ROCKER MOLDING, TO AVOID DAMAGING MOLDING DURING DRILLING.

3. INSTALL BOLT PLATE RETAINERS (ITEM #2) AND 5/16-18 X 1" CARRIAGE BOLTS (ITEM #3) BETWEEN THE ROCKER MOLDING, AND THE PINCHWELD, WITH CARRIAGE BOLTS GOING THROUGH THE HOLES DRILLED IN THE PINCHWELD.

NOTE: IT MAY BE NECESSARY TO RELEASE THE LOWER CLIPS OF THE ROCKER MOLDING, TO ALLOW IT TO BE PULLED BACK ENOUGH TO GET CARRIAGE BOLTS AND RETAINER PLATES INSTALLED.

4. PLACE BRACKETS (ITEM #1) UP TO ROCKER, AND FASTEN TO THE 5/16-18 X 1" CARRIAGE BOLTS (ITEM #3) THAT YOU'VE ALREADY PUT THROUGH THE PINCHWELD, USING THE 5/16-18 SERRATED FLANGE NUTS (ITEM #4). LEAVE THESE FASTENERS FINGER TIGHT AT THIS TIME.
5. IN THE TOP HOLES OF EACH BRACKET DRILL A 17/64" HOLE THROUGH THE SHEET METAL OF THE ROCKER PANEL, AS SHOWN IN FIG. 1.
6. INSTALL THE 5/16-18 X 1" THREAD CUTTING BOLT (ITEM #5), AND THE 5/16" LOCK WASHER (ITEM #6) INTO EACH OF THE 17/64" HOLES THAT WERE DRILLED. TIGHTEN TO 10 LB. FT.

NOTE: DUE NOT TIGHTEN THE 5/16-18 X 1" THREAD CUTTING BOLTS (ITEM #5) TO MORE THAN 10 LB. FT. OF TORQUE. OVER TORQUEING THESE WILL RESULT IN STRIPPING OUT THE ROCKER PANEL.

7. TIGHTEN ALL REMAINING 5/16-18 FASTENERS 19 LB. FT.

DRIVERS SIDE INSTALLATION

1. REPEAT STEPS 1 THROUGH 7.

NOTE: DUE TO THE THICKNESS OF THE MATERIAL IN THE ROCKER PANEL FOR THE TOP 2 HOLES ON THE SECOND BRACKET BACK ON THIS SIDE, YOU WILL NEED TO DRILL THOSE 2 HOLES WITH 19/64" BIT.

2. ATTACHING THE STEP ASSEMBLY:
PLEASE REVIEW THE INSTALLATION INSTRUCTIONS THAT ARE INCLUDED IN YOUR STEP ASSEMBLY FOR SPECIFIC DETAILS.



1200 E. Birch St.

Brandon, SD 57005

REV A 09APR15
552587 SHEET 1 OF 6 07OCT14

INSTALLATION INSTRUCTIONS AND PARTS LIST

SERVICE PARTS LIST

ITEM	PART NO.	QTY	DESCRIPTION
1	552580	3	MTG-BRKT, FRNT, LH/RH, GRIP STEP
1	552608	3	MTG-BRKT, FRNT, LH/RH, MEGA STEP
2	552611	8	BOLT-RETAINER PLATE, FRONT, ZP, 401525
3	108683	8	BLT-CRG, 5/16-18 X 1, SST
4	102680	8	SRRTD FLNG-NUT, 5/16-18, SST
5	109177	8	THRD CTTNG-SCRW, 5/16-18 X 1, ZP
6	100030	8	WASHER-LK, 5/16, ZP
7	552616	1	MTG-BRKT, LH, AC, GRIP STEP
7	552617	1	MTG-BRKT, LH, AC, MEGA STEP



(A LIVERNE Company)

1200 E. Birch St.

Brandon, SD 57005

REV A 09APR15
552587 SHEET 2 OF 6 07OCT14

SERVICE PARTS LIST

BRACKET NO. - 401520
571520

FIG. 1

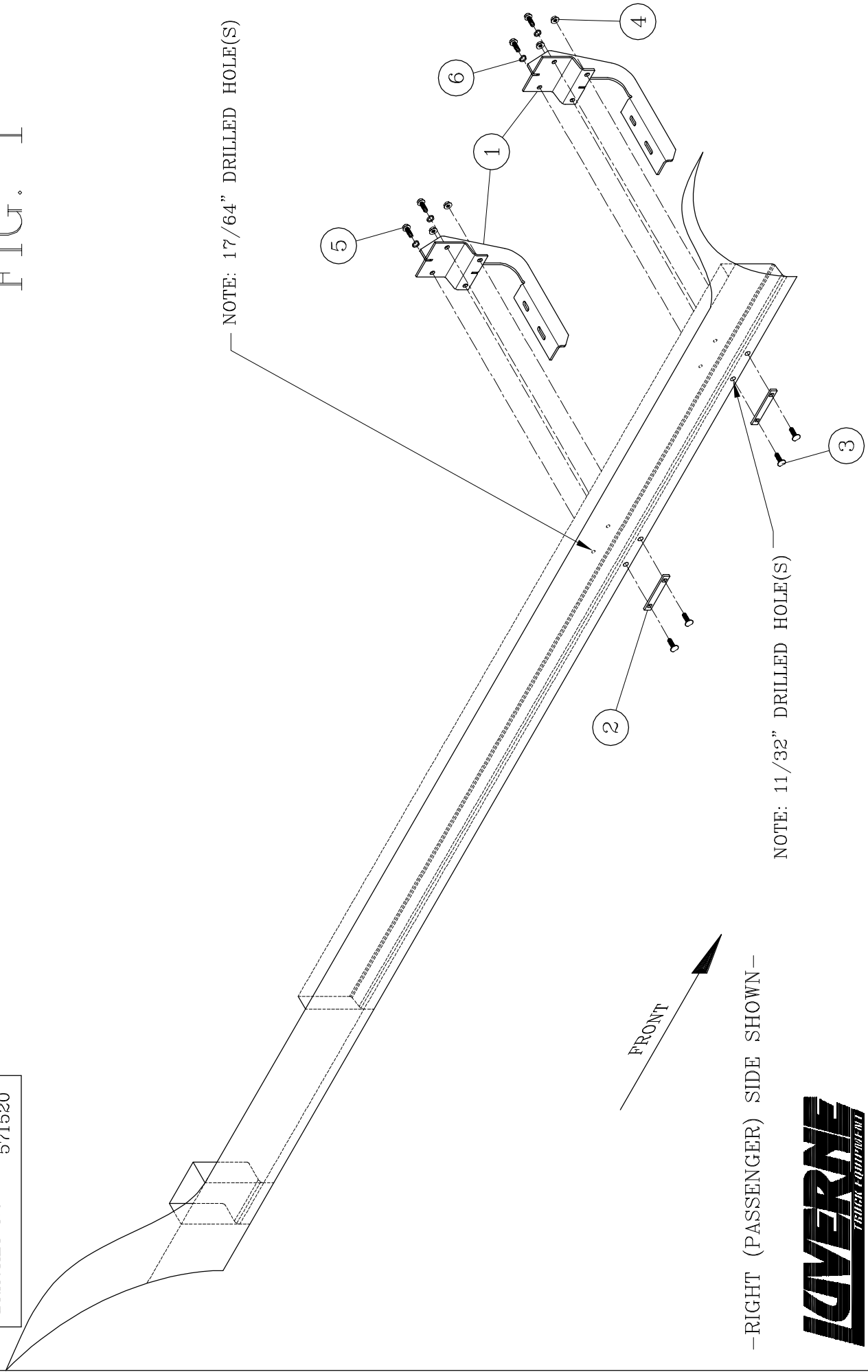

1200 E. 87th St.
Brassfield, SD 57005

SERVICE PARTS LIST

BRACKET NO. - 401520
571520

FIG. 2

NOTE: 17/64" DRILLED HOLE(S)

NOTE: 19/64" DRILLED HOLE(S)

NOTE: 11/32" DRILLED HOLE(S)

- LEFT (DRIVER) SIDE SHOWN -

FRONT



1200 E. Birch St.
Brassfield, SD 57005

REV A 09APR15
552587 SHEET 4 OF 6 07OCT14

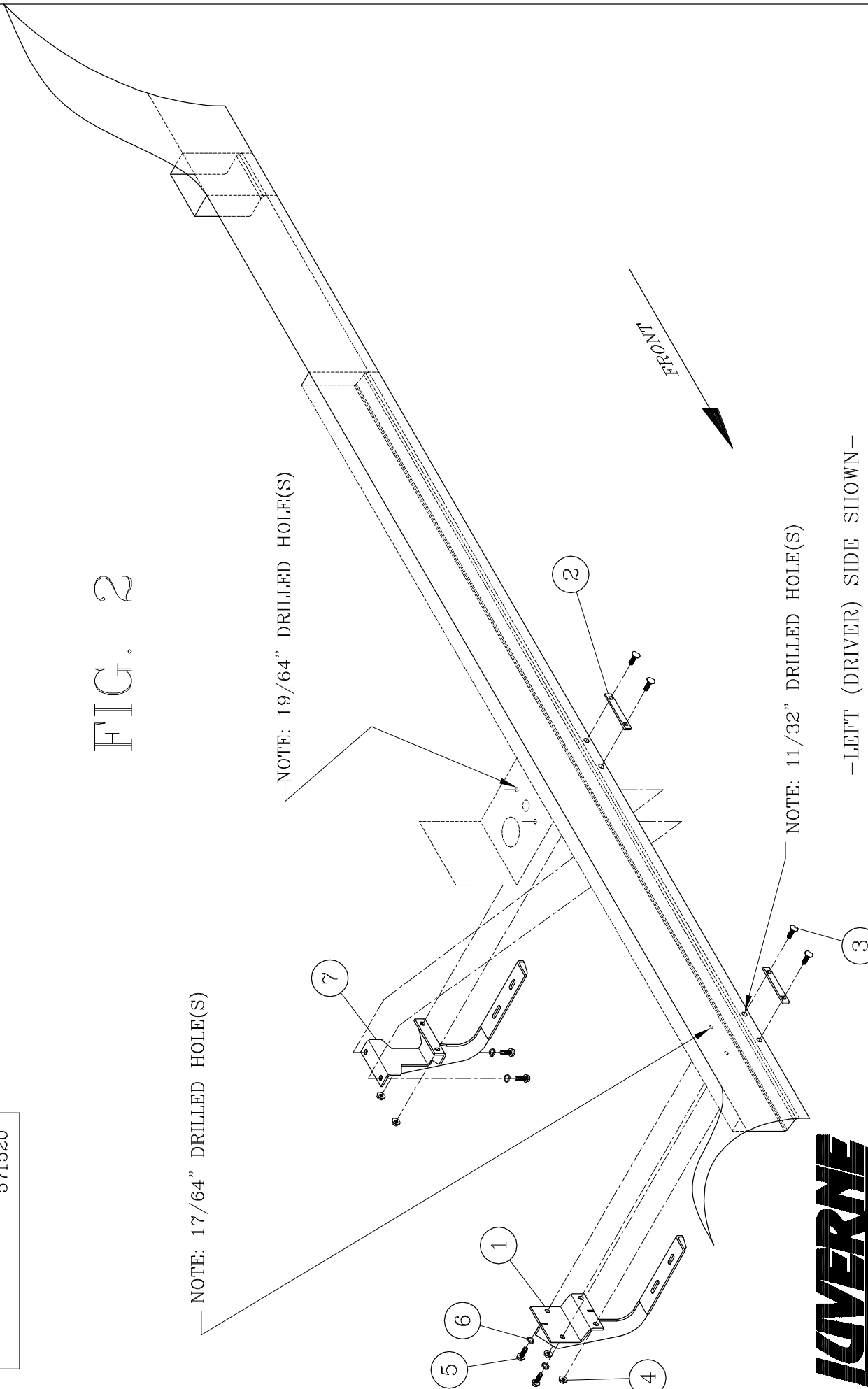

SERVICE PARTS LIST

BRACKET NO. - 401520
571520

FIG. 3
RIGHT (PASSENGER SIDE)

NOTE:
THESE DIMENSIONS MAY NEED TO BE ADJUSTED FORWARD, OR BACKWARD
TO AVOID DRILLING THROUGH SPOT WELDS IN THE PINCH SEAM.

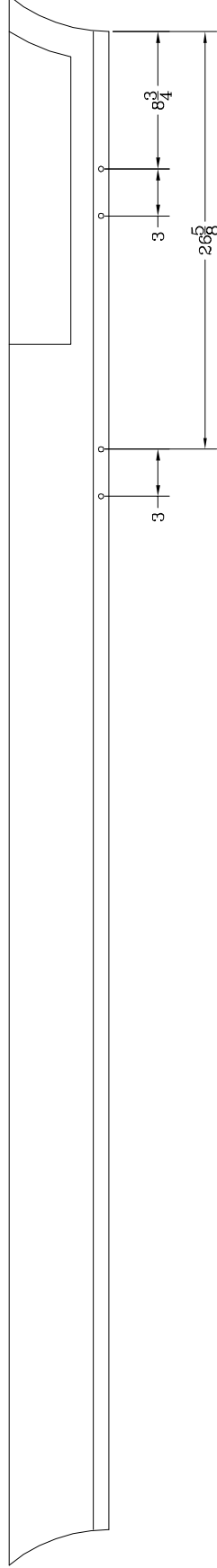

FRONT



1288 E. Birch St.
A Loverne Company
Bismarck, SD 57005

SERVICE PARTS LIST

BRACKET NO. - 401520
571520

FIG. 4
LEFT (DRIVERS SIDE)

NOTE:
THESE DIMENSIONS MAY NEED TO BE ADJUSTED FORWARD, OR BACKWARD
TO AVOID DRILLING THROUGH SPOT WELDS IN THE PINCH SEAM.

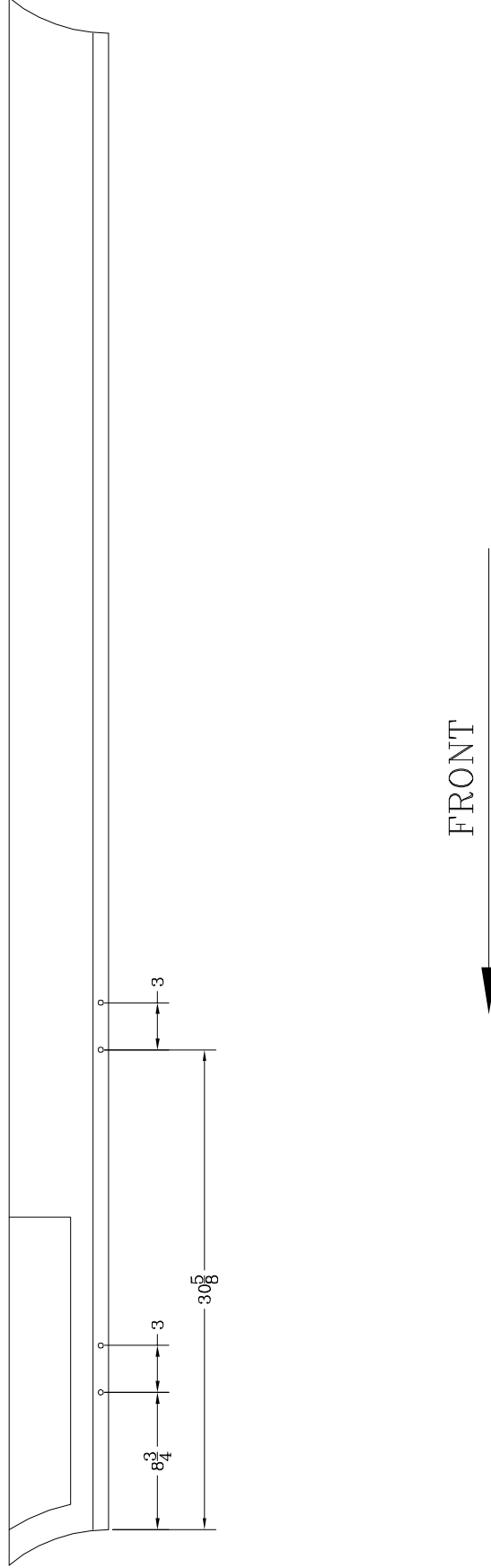

(A LOVERNE Company)
1288 E. Birch St. Fremont, SD 57005