

INSTALLATION INSTRUCTIONS AND PARTS LIST
APPLICATION: MODEL **571529** W2W MEGA STEP/SES BRACKETS ON:
FORD F150 PICKUPS
ROCKER PANEL MOUNT APPLICATION

NOTICE: PLEASE NOTE THE CHANGE IN STEP 6 REGARDING THE TORQUE VALUES FOR THE FACTORY LEAF SPRING BOLT.

1. READ INSTRUCTIONS COMPLETELY AND CHECK TO MAKE SURE THAT ALL REQUIRED PARTS (LISTED ON SERVICE PARTS LIST) ARE ON HAND BEFORE STARTING THE INSTALLATION.

NOTE: IF INSTALLING ON A REGULAR CAB OR SUPER CAB PICKUP THERE WILL BE TWO UNUSED BRACKETS.

2. ON THE LEFT SIDE OF THE VEHICLE INSTALL TWO 1.5" ISOLATOR WASHERS (ITEM #3) THE STEP MOUNTING BRACKET (ITEM #2) AND TWO M8-1.25 FLANGE NUTS (ITEM #4) ON THE FACTORY PROVIDED STUDS ON THE INSIDE OF THE ROCKER PANEL AS SHOWN IN FIGURE 1.
3. REPEAT STEP 2 FOR THE REMAINING BRACKETS.
4. CHECK THAT ALL BRACKETS ARE LEVEL AND TIGHTEN ALL FLANGE NUTS.
5. REMOVE THE CABLE GUIDE BRACKET FROM THE LEAF SPRING SHACKLE. **NOTE: THIS IS ONLY NECESSARY ON THE LEFT (DRIVERS) SIDE OF THE VEHICLE. NOTE: THE CABLE GUIDE BRACKET WILL NO LONGER BE NEEDED AND MAY BE REMOVED IF DESIRED.**
6. REMOVE THE NUT ON THE SPRING SHACKLE BOLT AND INSTALL THE REAR INBOARD BRACKET (ITEM #8). AS SHOWN IN FIGURE 2. MAKE SURE THE INBOARD BRACKET IS VERTICAL. **NOTE: FOLLOW FACTORY-RECOMMENDED TORQUE VALUES TO RE-INSTALL THE LEAF SPRING SHACKLE BOLT AS REQUIRED TO ATTACH THE REAR MOUNTING BRACKET TO THE VEHICLE. THIS ATTACHMENT POINT SHOULD BE PERIODICALLY INSPECTED (AND RE-TORQUED IF NECESSARY) IN ACCORDANCE WITH THE FACTORY RECOMMENDED VALUES.**
7. USING TWO 5/16-18 X 1" BOLTS (ITEM #6) TWO 5/16 FLAT WASHERS (ITEM #7) AND TWO 5/16-18 FLANGE NUTS (ITEM #5) INSTALL THE OUTBOARD BRACKET (ITEM #10) AS SHOWN IN FIGURE 2. **NOTE: LEAVE THIS BRACKET LOOSE AT THIS TIME.**
8. ATTACH THE STEP BOARD TO THE MOUNTING BRACKETS AS DESCRIBED IN THE INSTRUCTION SHEET INCLUDED WITH YOUR STEP BOARD ASSEMBLY.
9. ADJUST THE REAR OUTBOARD BRACKET FOR YOUR STEP ASSEMBLY AND TIGHTEN THE BOLTS SECURING THE OUTBOARD BRACKET TO THE INBOARD BRACKET.
10. USING A 5/16-18 X 1" BOLT (ITEM #6) A 5/16" FLAT WASHER (ITEM #7) AND A 5/16-18 FLANGE NUT (ITEM #5) INSTALL THE REAR CLAMP BRACKET (ITEM #11) OVER THE CABLES FROM STEP 5 ONTO THE REAR INBOARD BRACKET.
11. REPEAT STEPS 2 – 9 FOR THE RIGHT SIDE OF THE VEHICLE.



SERVICE PARTS LIST

ITEM	QTY	DESCRIPTION
1	1	STEP ASSY, MEGA STEP / O-MEGA STEP / SES
2	6	BRACKET-MTG, MEGA STEP/O-MEGA STEP/SES, 571523
3	12	WASHER – NYLON, .36” X 1.5” X .032” BLACK
4	12	NUT- FLANGE, M8-1.25, ZP
5	5	NUT-FLANGE, 5/16-18, BZP
6	5	BOLT- 5/16-18 X 1.00” BZP
7	5	WASHER-FLAT, 5/16” BZP
8	1	BRKT-MTG, REAR, INBOARD, LH
9	1	BRKT-MTG, REAR, INBOARD, RH
10	2	BRKT,STEP, REAR, OUTBOARD
11	1	BRKT-CLAMP, REAR, LH

SERVICE PARTS LIST

MODEL NO. - 571529

FORD F150 W2W

NOTE: SUPERCREW CONFIGURATION SHOWN

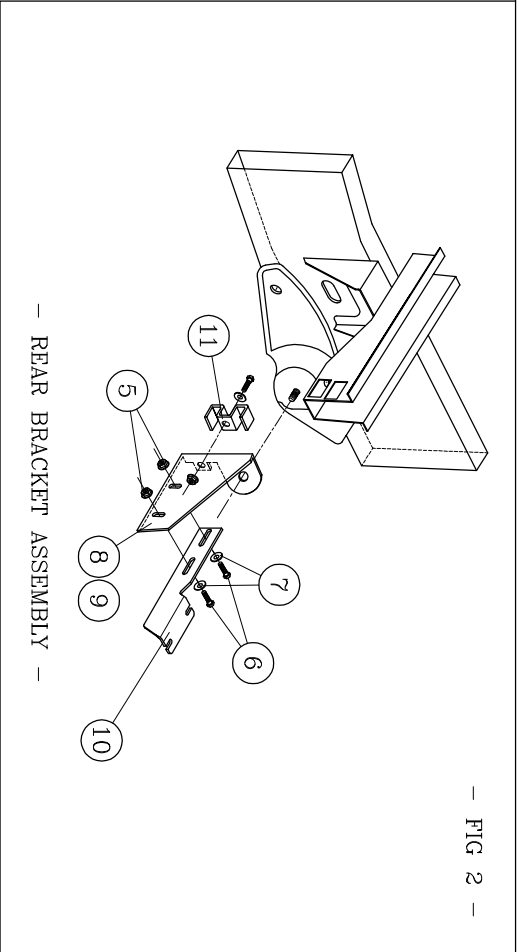
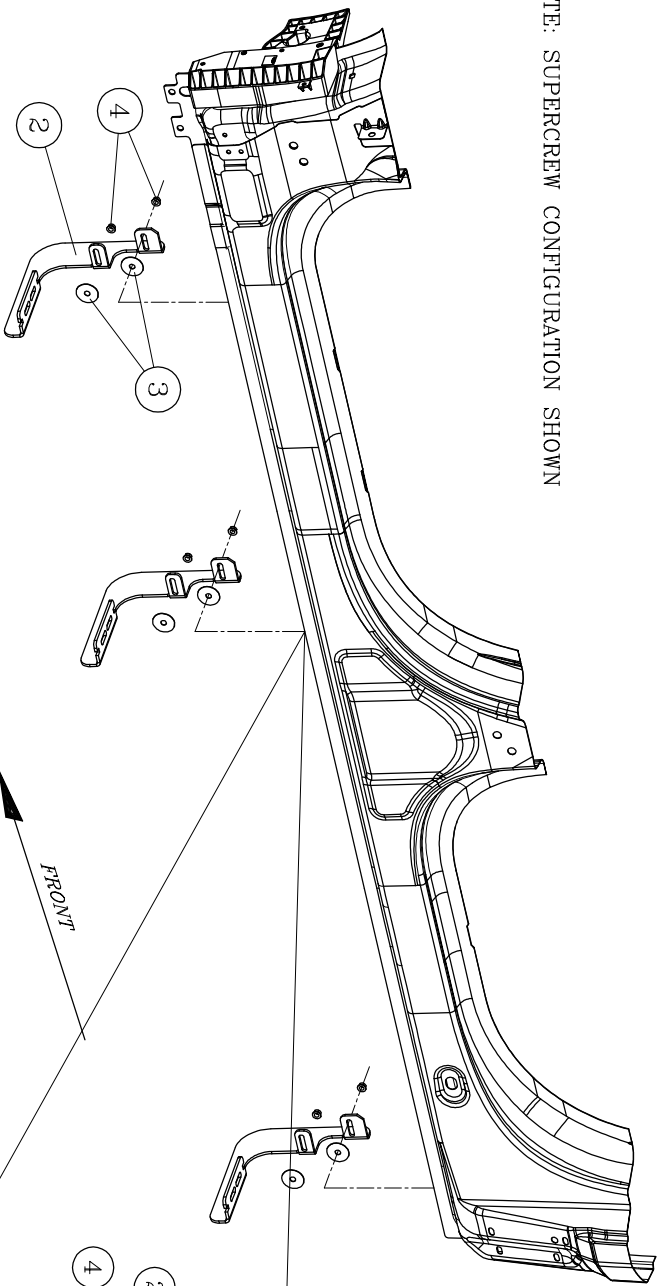

- FIG 2 -

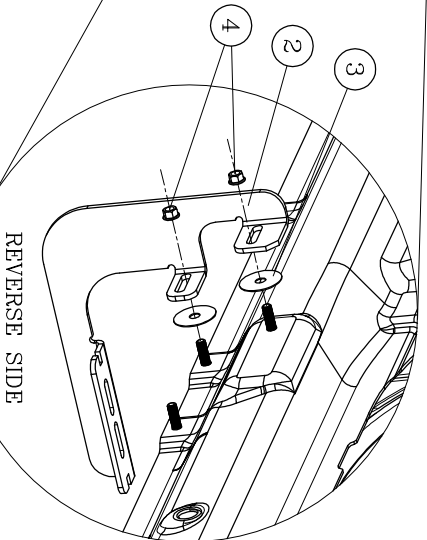

- LEFT (DRIVERS) SIDE SHOWN -
- RIGHT (PASSENGER) SIDE OPPOSITE -

