

# INSTALLATION INSTRUCTIONS AND PARTS LIST

## MODEL 561512 BUMPER GRILLE INSERT

VEHICLE APPLICATION:  
2015 AND NEWER CHEVROLET 2500 AND 3500 SERIES TRUCKS

**READ INSTRUCTIONS COMPLETELY AND CHECK TO MAKE SURE THAT ALL REQUIRED PARTS (LISTED ON SERVICE PARTS LIST) ARE ON HAND BEFORE STARTING THE INSTALLATION**

### NOTE: FOR GAS VEHICLES INSTALL AS FOLLOWS

1. INSTALL THE 5/16"-18 U-NUT (ITEM #1) OVER THE HOLES LOCATED AT THE SIDES OF THE BUMPER OPENING WITH THE NUT PORTION FACING TOWARDS THE FRONT OF THE VEHICLE.
2. USING THE 5/16"-18 X .875" BOLTS (ITEM #2) AND 5/16" LOCK WASHERS (ITEM #3) INSTALL THE RH AND LH BRACKETS (ITEM #4, 5). CHECK THAT EVERYTHING IS STRAIGHT AND SQUARE AND TIGHTEN BOLTS.

**NOTE: WHEN INSTALLED CORRECTLY THE MOUNTING HOLES FOR THE INSERT WILL BE AT THE BOTTOM OF THE BRACKET.**

### NOTE: FOR DIESEL VEHICLES INSTALL AS FOLLOWS

1. REMOVE THE BOLTS LOCATED AT THE SIDES OF THE BUMPER OPENING.
2. USING THE SAME BOLTS INSTALL THE RH AND LH BRACKETS (ITEM #4, 5). CHECK THAT EVERYTHING IS STRAIGHT AND TIGHTEN BOLTS.

**NOTE: WHEN INSTALLED CORRECTLY THE MOUNTING HOLES FOR THE INSERT WILL BE AT THE BOTTOM OF THE BRACKET.**

3. USING THE 1/4"-20 FLANGE NUTS (ITEM #6), 1/4"-20 BUTTON HEAD BOLT (ITEM #7) AND 1/4" LOCK WASHERS (ITEM #8) INSTALL THE GRILLE INSERT (ITEM #9).
4. ADJUST THE INSERT TO MAKE IT LEVEL AND TIGHTEN BOLTS.

## SERVICE PARTS LIST

ITEM	PART NO.	QTY	DESCRIPTION
1	105541	4	U-NUT 5/16"-18
2	104281	4	SCR-CAP, HEX, STL, 5/16"-18 X .875"
3	100030	4	WASHER - LOCK, 5/16", ZP
4	552504	1	BRKT-MTG, RH, 561512
5	552503	1	BRKT-MTG, LH, 561512
6	102366	4	NUT-SERR FLG, 1/4"-20, SST
7	105543	4	SCR-BTN HD, SST, 1/4"-20 X 1.00"
8	100017	4	WASHER - LOCK, 1/4", ZP
9	552507	1	GRILLE INSERT, 561512



(A LIVERNE Company)

1200 E. Birch St.

Brandon, SD 57005

552505 SHEET 1 OF 2 13AUG14

SERVICE PARTS LIST

MODEL NO. - 561512

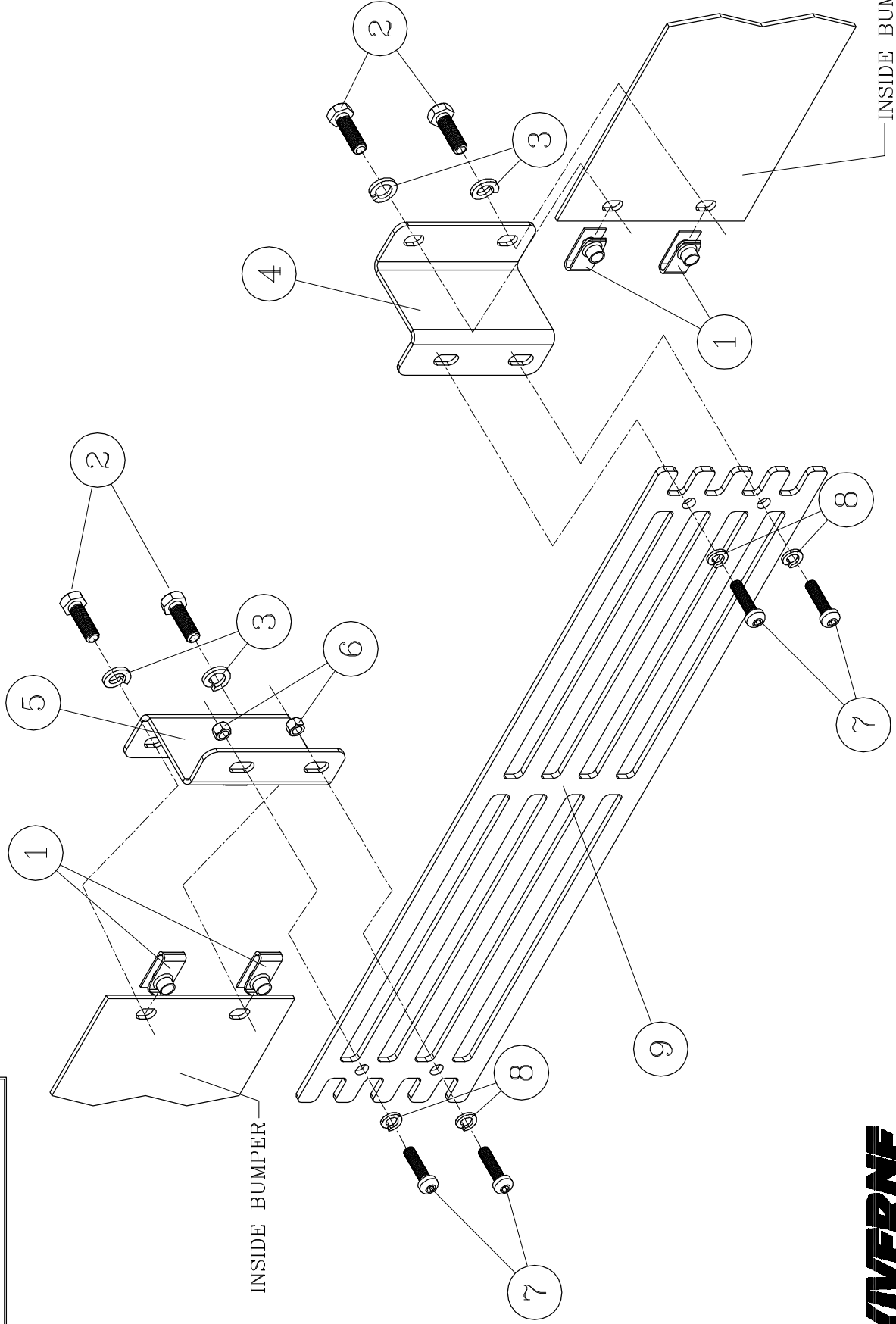

1200 E. Birch St.  
Bremerton, WA 98312