

INSTALLATION INSTRUCTIONS AND PARTS LIST

APPLICATION: MODEL: **553130**

TOW GUARD HEAT SHIELD KIT 2009+ RAM 1500 DUAL EXHUAUST

1. READ INSTRUCTIONS COMPLETELY AND CHECK TO MAKE SURE THAT ALL REQUIRED PARTS (LISTED ON SERVICE PARTS LIST) ARE ON HAND BEFORE STARTING THE INSTALLATION.
2. YOUR TOW GUARD COMES COMPLETELY ASSEMBLED. YOU WILL NEED TO REMOVE THE (4) OUTER MOST CARRIAGE BOLTS, AND REPLACE THEM WITH THE LONGER ONES PROVIDED.
3. WHILE YOU HAVE THE ORIGINAL CARRIAGE BOLTS OUT, USE THE CUTOUT TEMPLATES **FIGURES 2. AND 3.** TO MARK THE RUBBER TO BE CUT. CUT RUBBER ACCORDINGLY.
4. INSERT THE LONGER 5/16-18 X 1.25" CARRIAGE BOLTS PROVIDED (ITEM #1) INTO THE THE TOW-GUARD FRAME, AND THROUGH THE RUBBER, THREAD ON THE 5/16-18 SERRATED FLANG NUT (ITEM #2) TIGHTEN UNTIL RUBBER BEGINS TO COMPRESS. **SEE FIGURE 1.**
5. INSTALL HEAT SHIELDS (ITEMS #3, & 4) WITH THE BENT FLANGE TOWARDS THE RUBBER, THEN REPLACE THE ORIGINAL FLAT WASHER (ITEM #5), AND NYLOK NUT (ITEM #6), AND TIGHTEN. **SEE FIGURE 1.**

SERVICE PARTS LIST

ITEM	PART NO.	QTY	DESCRIPTION
1	108948	4	BLT-CRG, SST, 5/16-18 X 1.25"
2	102680	4	NUT-SERR FLG, SST, 5/16-18
3	553131	1	HEAT SHIELD, LH, SST
4	553132	1	HEAT SHIELD, RH, SST
5	102734	4	WSHR-FL, SST, 5/16-18 (NOT INCLUDED)
6	102675	4	NUT-HEX, NYLOK, SST, 5/16-18 (NOT INCLUDED)



Fig. 1

SERVICE PARTS LIST

MODEL NO. - 553130

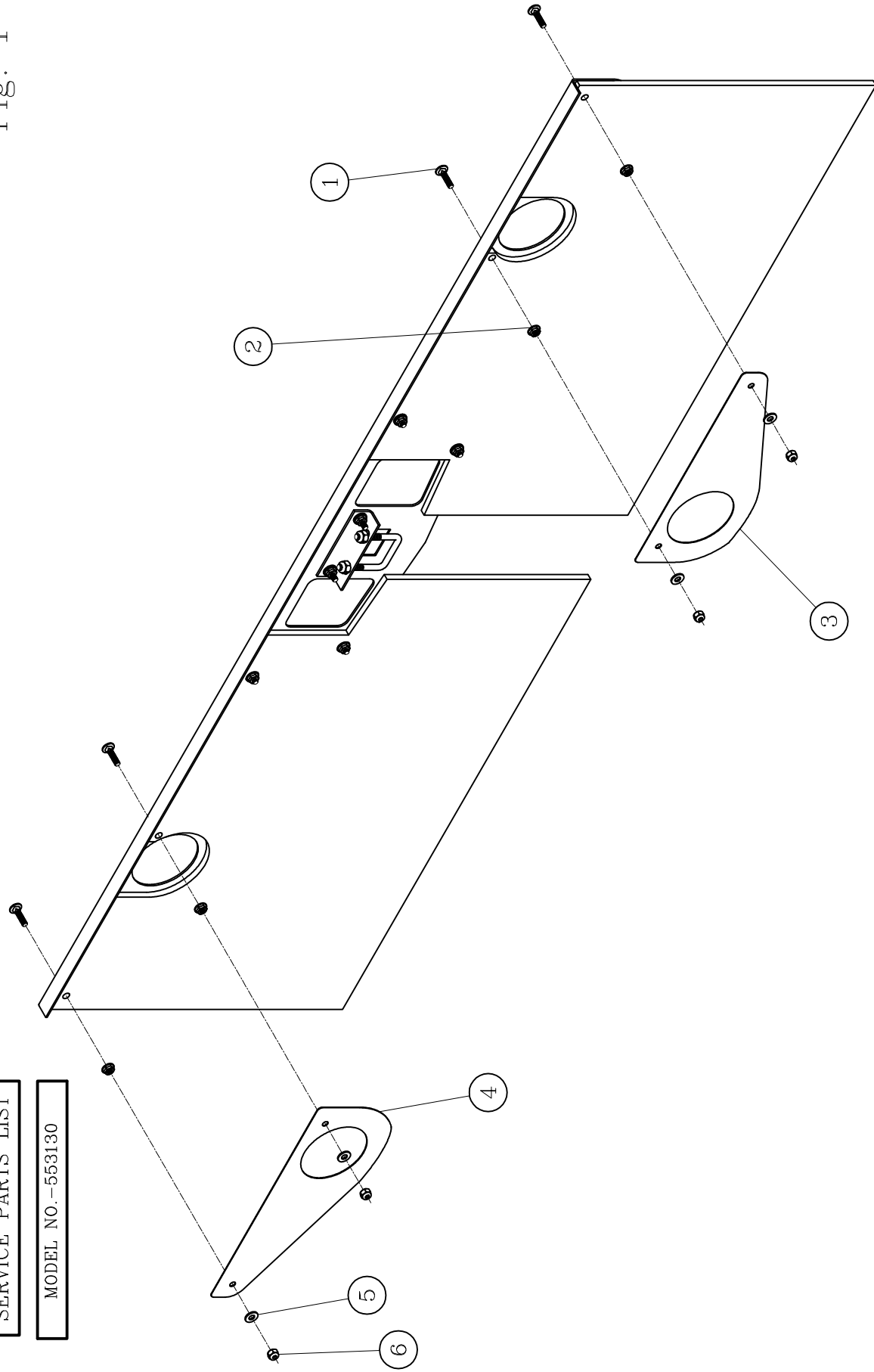

LOVERNE
TRUCK EQUIPMENT

SERVICE PARTS LIST

MODEL NO. -553130

Fig. 2

ALIGN HOLE WITH MIDDLE HOLE IN RUBBER

ALIGN THIS EDGE WITH TOP EDGE OF RUBBER.

CUT ALONG DOTTED LINE.
DISCARD THIS SIDE OF CUTOUT.



DRIVERS SIDE CUTOUT TEMPLATE

SERVICE PARTS LIST

MODEL NO. - 553130

ALIGN THIS EDGE WITH
TOP EDGE OF RUBBER.

Fig. 3

ALIGN HOLE WITH MIDDLE HOLE IN RUBBER

CUT ALONG DOTTED LINE.
DISCARD THIS SIDE OF CUTOUT.



PASSENGERS SIDE CUTOUT TEMPLATE