

## INSTALLATION INSTRUCTIONS AND PARTS LIST

ACCESSORY KIT FOR TUBULAR AND OVAL BED RAILS:

### 2014 SILVERADO/SIERRA 1500 TRUCKS

1. READ INSTRUCTIONS COMPLETELY AND CHECK TO MAKE SURE THAT ALL REQUIRED PARTS ARE ON HAND BEFORE STARTING THE INSTALLATION.  
SEE FIG. 1 FOR ROUND STAINLESS BED RAILS  
SEE FIG. 2 FOR OVAL ADJUSTABLE BED RAILS
2. THIS PRODUCT IS AN ACCESSORY KIT TO MOUNT THE BED RAILS ON TO A 2014+ GM SILVERADO/SIERRA. IT WILL ONLY BE USED TO CREATE A MOUNTING POINT FOR THE REAR STAKE POCKETS. YOU WILL ALSO NEED TO CUT OUT THE PLASTIC BED CAP FOR THE FRONT STAKE POCKET. USE THE EXISTING LINES AS A GUIDE.
3. ATTACH THE MULTI THREAD U-NUTS (ITEM #4) TO BOTH HOLES IN THE TWO MOUNTING BRACKETS (ITEM #1) AS SHOWN. USING THE LONG BOLT THAT IS SUPPLIED WITH THE BED RAIL. ATTACH IT TO THE TOP OF THE BRACKET TO HOLD THE BRACKET AS YOU LOWER IT INTO THE STAKE POCKET AS SHOWN. IT WILL NEED TO BE LOWERED BELOW THE PLASTIC BED CAP AND ROTATED TO FIT BACK UP INTO THE OPENING.
4. WITH THE BRACKET IN THE STAKE POCKET AND THE TOP THREADED INSERT SLIGHTLY BELOW THE PLASTIC BED CAP, ATTACH THE 5/16-18 HEX SCREW, 5/16 WASHER, AND 1/2" WASHER (ITEMS #5,6,7). TIGHTEN THE BOLT.
5. REMOVE THE LONG 5/16" SCREW FROM THE TOP OF THE BRACKET AND ASSEMBLE THE BED RAIL PER INSTRUCTIONS. YOU WILL BE REQUIRED TO USE THE LARGER PLASTIC BED CAPS TO COVER THE REAR STAKE POCKET OPENING. (ITEMS #2, 3)

### SERVICE PARTS LIST

ITEM	PART NO.	QTY	DESCRIPTION
1	510096	2	MOUNTING BRACKET, LH/RH
2	109332	1	PLASTIC SPACER PLATE, LH, BLACK
3	109333	1	PLASTIC SPACER PLATE, RH, BLACK
4	104264	4	MULTI THREAD U-NUT, 5/16-18
5	100647	2	SCEW-HEX HEAD, 5/16-18 X 1.0, ZP
6	100034	2	WASHER-FLAT, 5/16",ZP
7	100118	2	WASHER-FLAT, 1/2",ZP



SERVICE PARTS LIST
510095

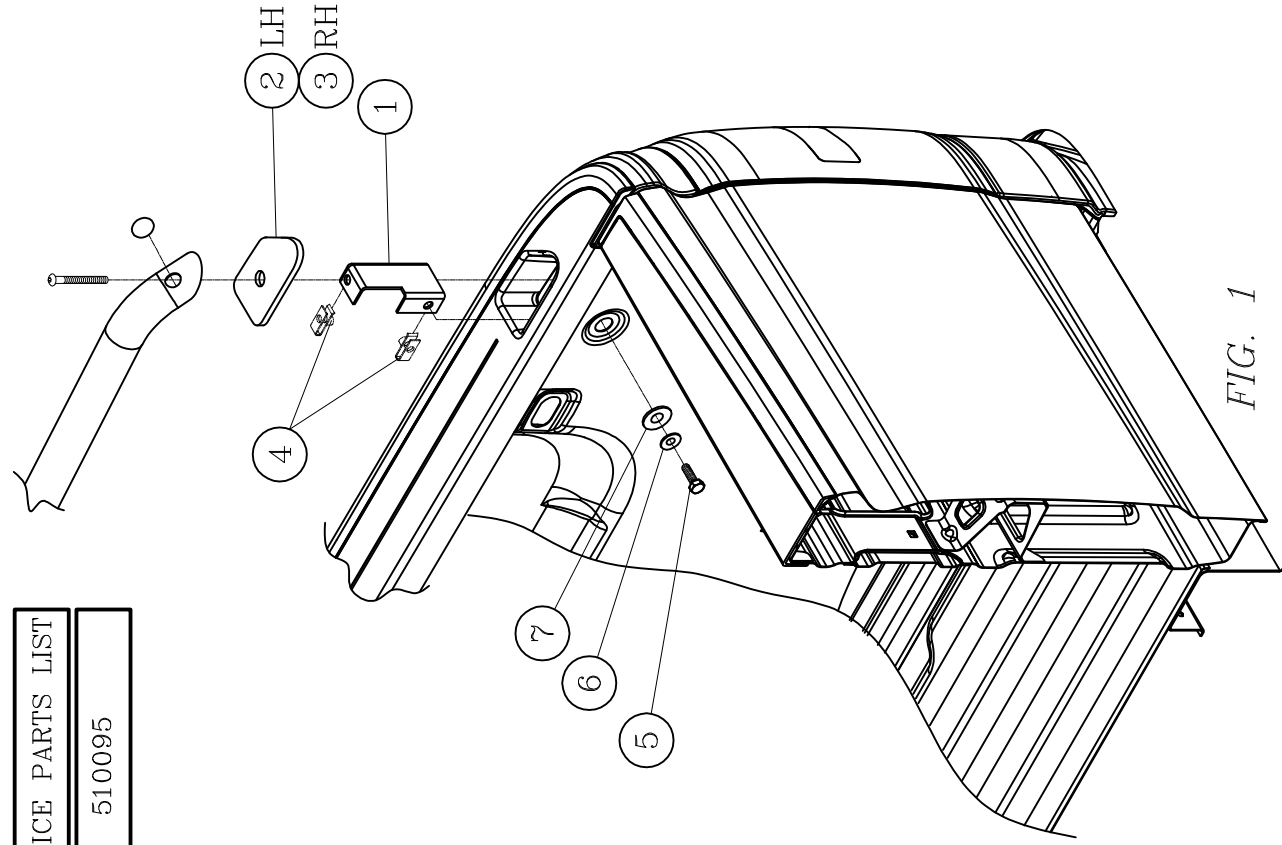

FIG. 1

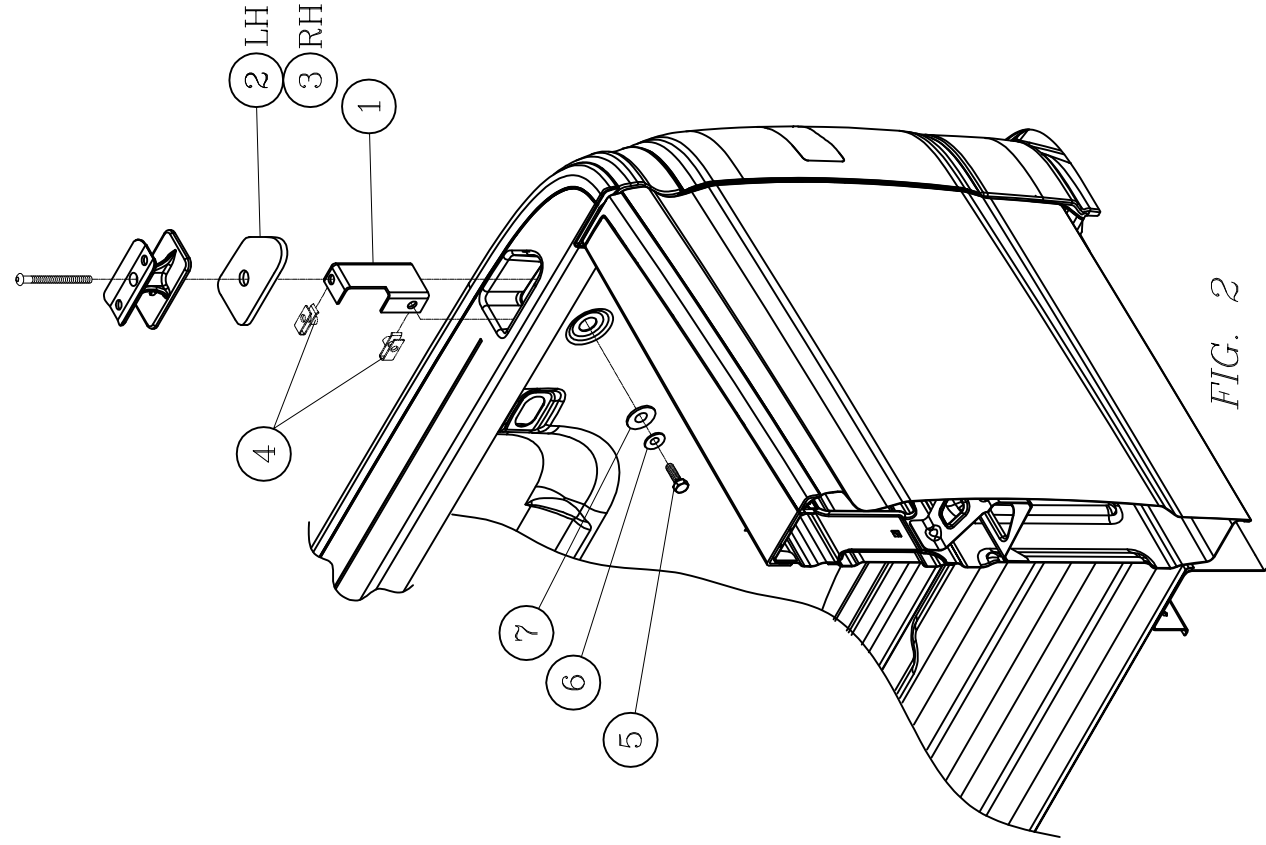

FIG. 2



ACCESSORY KIT FOR THE 2014+ GM 1500