

INSTALLATION INSTRUCTIONS AND PARTS LIST

MODEL 415114, GRIP STEPS (BOARDS ONLY)

UNIVERSAL APPLICATIONS

1. Read instructions completely and check to make sure that all required parts (listed on the service parts list) are on hand before starting the installation.
2. Follow the instructions included with the specific bracket package to mount the brackets to your vehicle.
3. Step assembly:
 - 3.1 This Board can be modified from its original length to fit many applications. Simply determine how long you will need the board, and cut to that length using a saber saw, chop saw, or hack saw. Use flat black paint to touch up the ends that were cut.
 - 3.2 Before attaching the grip steps to the brackets, slide the appropriate number of support braces (item #2) into the channel of the step (item #1).
 - 3.3 Slide the end cap (item #3) over the front and rear of each step. Using the supplied #8 x 1/2" self drilling tek screw (item #8), screw the end cap to the bottom of the step.
4. Attaching the step to the mounting bracket:
 - 4.1 Set the step on the mounting brackets, and slide each support brace over the top of each mounting bracket. Attach the flat spacer plate (item #4) to the bottom of the step, between the support brace, and the top of the mounting bracket.
 - 4.2 Using the supplied 5/16-18 x 1" carriage bolt, washer, and flange nuts, (item #5, 6, 7), attach the step assembly, flat spacer plate and mounting bracket. **(NOTE: Some of the flange nuts are supplied in the specific bracket package, not the step package.)**
 - 4.3 Set the step plate in the correct position and tighten all fasteners.
Torque all fasteners to 19 LB FT.

SERVICE PARTS LIST

ITEM	PART NO.	QTY	DESCRIPTION
1	551888	2	EXTRUSION-AL,97.87,GRIP STEP,BLK,415098
1	551889	2	EXTRUSION-AL,101.25,GRIP STEP,BLK,415102
1	551388	2	EXTRUSION-AL,113.62,GRIP STEP,BLK,415114
2	551296	10	SUPPORT BRACE, UPPER, GALV.
3	551394	4	CAP-END,GRIP STEP, BLACK, PLASTIC
4	551298	14	SPACER PLATE, LOWER, BLACK
5	108683	20	BOLT-CRG,5/16-18 X 1.0", SST
6	101369	20	WASHER-FLAT,5/16,SST
7	102680	20	NUT-SERR FLG,HX,SST,WX,5/16-18
8	107958	8	SCR-TEK #8-18 X 1/2",SST,BLK



1200 E. Birch St.

Brandon, SD 57005

REV C 01APR12

REV B 03DEC10

REV A 10JUL09

551391 SHEET 1 OF 2 01JUN09

SERVICE PARTS LIST

MODEL NO. - 415098
 415102
 415114

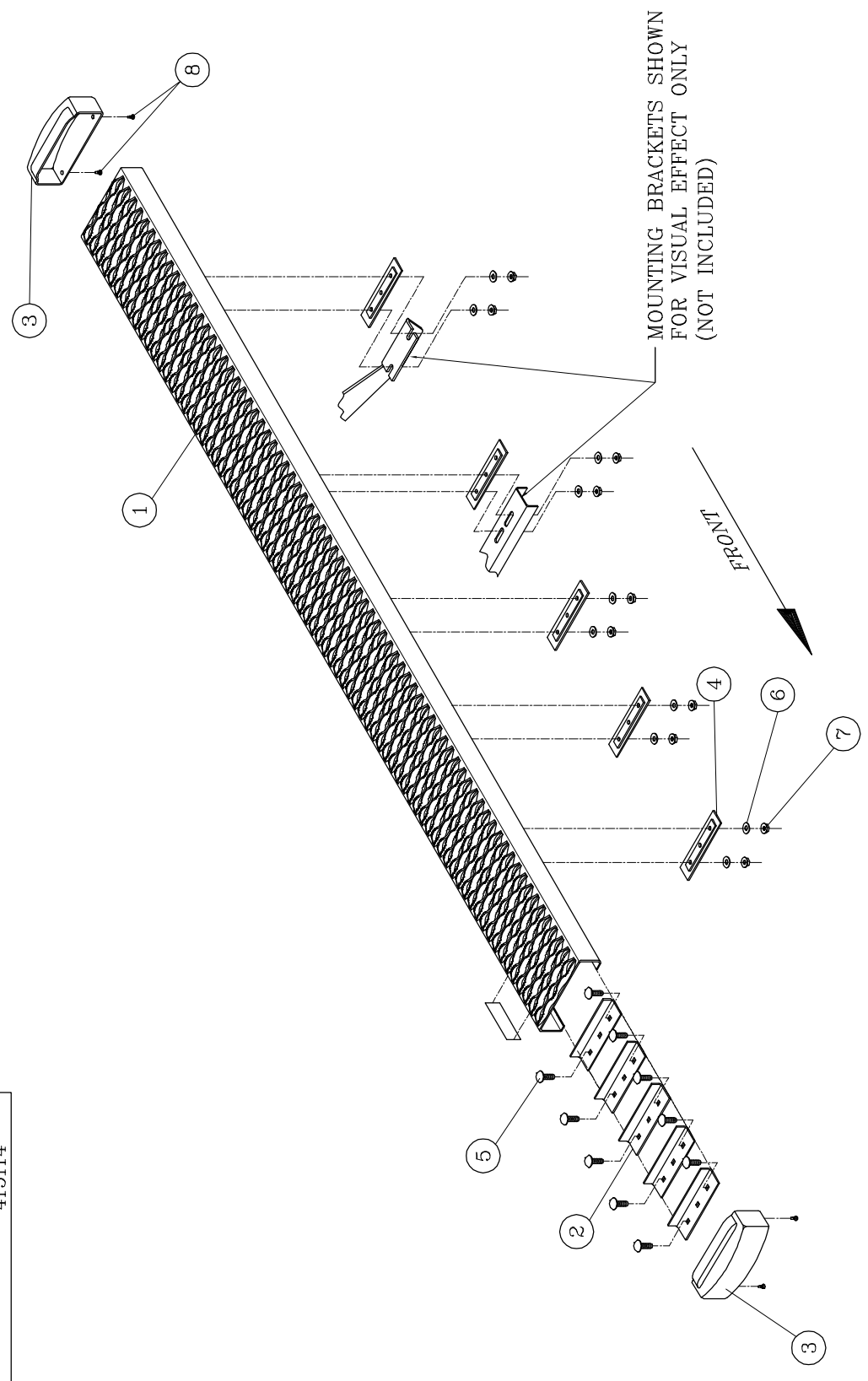

INSTALLATION INSTRUCTIONS AND PARTS LIST

MODEL 570125 MEGA STEPS

VEHICLE APPLICATION:

2001 AND NEWER FORD VANS

READ INSTRUCTIONS COMPLETELY AND CHECK TO MAKE SURE THAT ALL REQUIRED PARTS (LISTED ON SERVICE PARTS LIST) ARE ON HAND BEFORE STARTING THE INSTALLATION.

1. ON THE PASSENGERS SIDE OF THE VEHICLE, REMOVE THE TAPE THAT IS COVERING THE MOUNTING HOLES IN THE INSIDE QUARTER PANEL (FIVE LOCATIONS).
2. INSTALL THE SHORT 5/16-18" MULTI THREAD U-NUTS (ITEM #11) IN THE RECTANGULAR AND ROUND HOLES AT THE 1ST, 3RD, 4TH, & 5TH HOLES FROM THE FRONT. INSTALL THE LONG 5/16-18" MULTI THREAD U-NUT (ITEM #12) IN THE RECTANGULAR AND ROUND HOLE AT THE 2ND SET OF HOLES FROM THE FRONT.
3. INSTALL THE MOUNTING BRACKETS (ITEMS #2, #4, #6 & #7) USING THE 5/16-18 X 1" HEX BOLTS (ITEM #8), 5/16" FLAT WASHERS (ITEM #15) AND 5/16" LOCK WASHERS (ITEM #16) AS SHOWN IN FIG. 1. INTO THE MULTI THREAD U-NUTS. FINGER TIGHTEN ONLY AT THIS TIME.
4. INSTALL THE 5/16-18 X 1" HEX BOLTS (ITEM #8), 5/16" FLAT WASHERS (ITEM #15) AND BLACK PLATED 5/16" SERRATED FLANGE NUTS (ITEM #14) THROUGH THE HOLES IN THE LOWER PINCH WELD AND THE BRACKET AS SHOWN IN FIG. 1. FINGER TIGHTEN ONLY AT THIS TIME.
5. MAKE SURE THE TWO FRONT BRACKETS ARE UP TIGHT AGAINST THE VEHICLE SURFACE AT THE TOP AND TIGHTEN THE BOLT THAT GOES THROUGH THE PINCH WELD.
6. INSTALL FIVE SQUARE HEAD SCREWS, 5/16-18 X 1" (ITEM #9) IN THE FRONT TRACK OF THE STEP PLATES. (**NOTE:** THERE ARE ONLY FOUR SCREWS IN THE BACK CHANNEL OF THE MEGA STEPS SO USE ONLY ONE SCREW IN THE CENTER BRACKET.)
7. POSITION THE MEGA STEP ON THE MOUNTING BRACKETS SO THAT THE SQUARE HEAD SCREWS ARE LOCATED IN THE SLOTS OF THE MOUNTING BRACKETS AND THE STEP IS CENTERED, FRONT TO REAR, ON THE VEHICLE. INSTALL 5/16" SERRATED FLANGE NUTS (ITEM #13) ON THE SQUARE HEAD SCREWS. FINGER TIGHTEN ONLY AT THIS TIME.
8. ALIGN THE STEP PLATE WITH THE BOTTOM OF THE BODY SHEET METAL. THE BOTTOM EDGE OF THE MOUNTING BRACKET FLANGES SHOULD BE EVEN WITH THE BOTTOM EDGE OF THE PINCH WELD ON THE VEHICLE. TIGHTEN THE BOLTS FROM THE STEP PLATE TO THE FRAME TO 19 FOOT POUNDS OF TORQUE.
9. TIGHTEN THE BODY MOUNTING BOLTS TO 19 FOOT POUNDS OF TORQUE.
10. ON THE LEFT SIDE (DRIVERS SIDE), HOLES ARE ONLY PROVIDED FOR THE FRONT TWO BRACKETS. MOUNT THEM THE SAME AS THE RIGHT SIDE FRONT BRACKETS WERE MOUNTED.
11. MOUNT ONE OF THE (ITEM #6) BRACKETS TO THE END OF THE STEP PLATE AS SHOWN IN FIG. 1. (**NOTE:** THE HOLES THROUGH THE FLANGE OF THE THREE REAR BRACKETS SHOULD BE 51-1/2", 73-1/4" AND 92-1/8" FROM THE FRONT. CHECK THE PASSENGERS SIDE OF THE VEHICLE FOR THE LOCATIONS.



(A LIVERNE Company)

1200 E. Birch St.

Brandon, SD 57005

551796 SHEET 1 OF 3 09MAY08

12. SET THE OTHER END OF THE STEP PLATE ON THE FRONT BRACKETS AND CLAMP THE REAR MOUNTING BRACKET TO THE PINCH WELD SO THE BOTTOM EDGE OF THE FLANGE IS FLUSH WITH THE PINCH WELD.
13. INSTALL THE TWO REMAINING BRACKETS (ITEM #6 & #7) TO THE STEP PLATE THEN CLAMP THEM TO THE PINCH WELD.
14. USING THE HOLES IN THE BRACKET AS A GUIDE DRILL Ø11/32" HOLES THROUGH THE CENTER OF THE PINCH WELD.
15. FASTEN THE BRACKETS TO THE PINCH WELD WITH THE 5/16-18 X 1" HEX BOLTS (ITEM #8), 5/16" FLAT WASHERS (ITEM #15) AND BLACK PLATED 5/16" SERRATED FLANGE NUTS (ITEM #14). FINGER TIGHTEN ONLY AT THIS TIME.
16. USING THE TOP HOLES IN THE BRACKET AS A GUIDE, DRILL Ø17/64" HOLES THROUGH THE INSIDE BODY PANEL AND INSTALL THE 5/16 X 1" WASHER HEAD SCREWS (ITEM #10), 5/16" FLAT WASHERS (ITEM #15) AND 5/16" LOCK WASHERS (ITEM #16) AS SHOWN IN FIG. 1.
17. TIGHTEN ALL BOLTS TO 19 FOOT POUNDS OF TORQUE.

SERVICE PARTS LIST

ITEM	PART NO.	QTY	DESCRIPTION
1	575098	1	STEP ASSY- 98.00" (MOD. 575098)
2	551789	1	MOUNTING BRACKET – FRONT, RH
3	551790	1	MOUNTING BRACKET - FRONT, LH
4	551791	1	MOUNTING BRACKET – CENTER, RH
5	551792	1	MOUNTING BRACKET – CENTER, LH
6	551793	3	MOUNTING BRACKET – REAR, RH
7	551794	3	MOUNTING BRACKET – REAR, LH
8	106997	17	SCREW – HHC, 5/16-18" X 1", BZP
9	106880	24	SCREW-SQUARE HD,5/16-18 X 1"
10	105537	3	SCREW-HEX WASHER HD,5/16" X 1", TF, AB, SST
11	104264	5	U-NUT – MULTI THREAD, 5/16-18"
12	105541	2	U-NUT – MULTI THREAD, 5/16-18", LONG
13	102680	20	NUT – SERRATED FLANGE, 5/16-18", SST
14	106996	10	NUT – SERRATED FLANGE, 5/16-18", BZP, SST
15	106998	30	FLAT WASHER - 5/16", SST, BZP
16	102668	10	LOCK WASHER - 5/16", SST



(A LUVERNE Company)

1200 E. Birch St.

Brandon, SD 57005

551796 SHEET 2 OF 3 09MAY08

SERVICE PARTS LIST

MODEL NO. - 570125

LEFT SIDE (DRIVER)

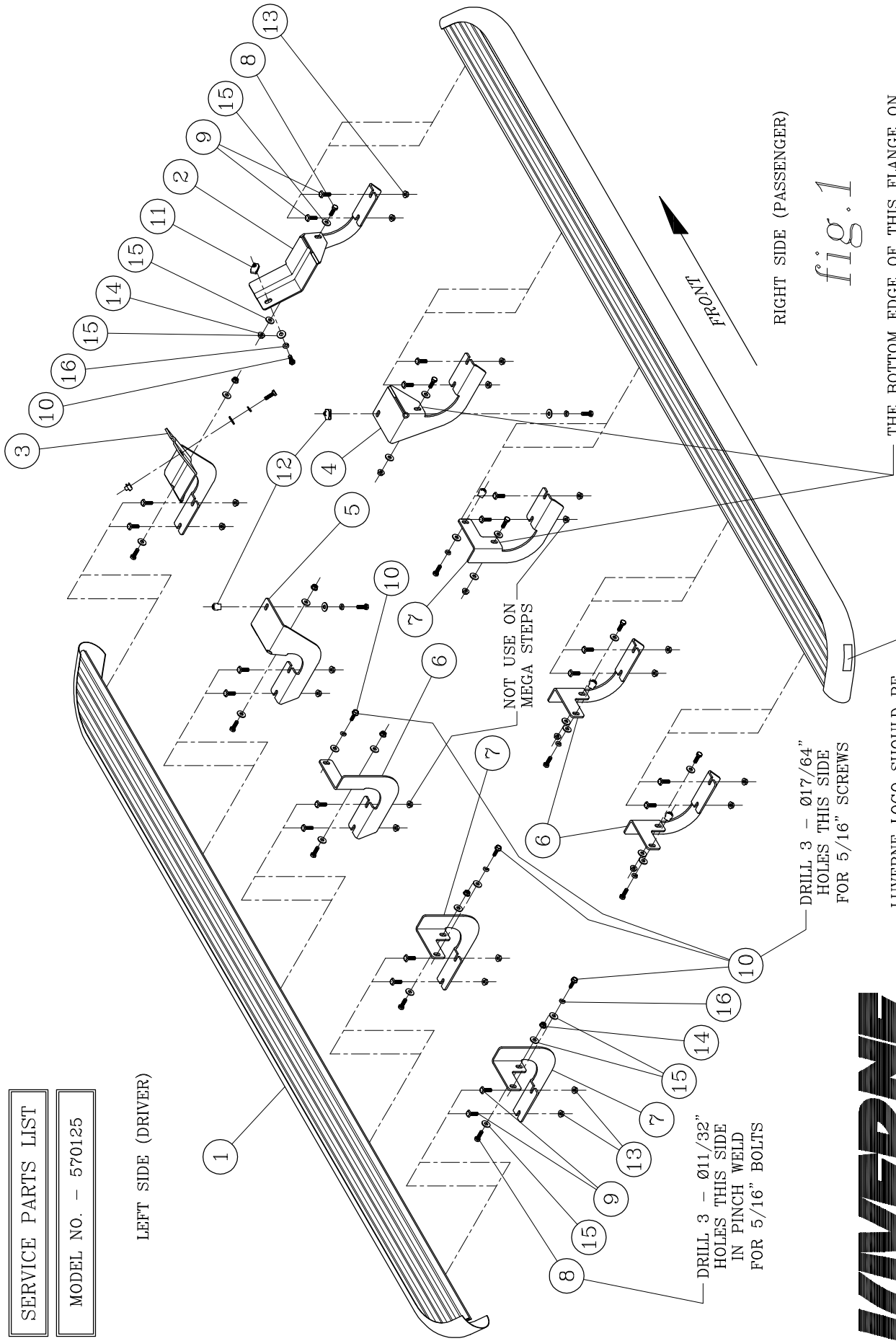

fig. 1

RIGHT SIDE (PASSENGER)

THE BOTTOM EDGE OF THIS FLANGE ON ALL OF THE MOUNTING BRACKETS SHOULD BE APPROXIMATELY EVEN WITH THE BOTTOM OF THE PINCH WELD.

LUVERNE LOGO SHOULD BE TOWARD REAR OF VEHICLE

DRILL 3 - Ø17/64" HOLES THIS SIDE FOR 5/16" SCREWS

DRILL 3 - Ø11/32" HOLES THIS SIDE IN PINCH WELD FOR 5/16" BOLTS

LUVERNE
TRUCK EQUIPMENT
(A LUVERNE Company)

1200 E. Birch St.
Brandon, SD 57005