

# INSTALLATION INSTRUCTIONS AND PARTS LIST

MODEL 415078, 415088, GRIP STEPS (BOARDS ONLY)

UNIVERSAL APPLICATIONS

1. Read instructions completely and check to make sure that all required parts (listed on the service parts list) are on hand before starting the installation.
2. Follow the instructions included with the specific bracket package that you are using to mount the brackets to your vehicle.
3. Step assembly:
  - 3.1 Before attaching the grip steps to the brackets, slide the appropriate number of support braces (item #2) into the channel of the step (item #1).
  - 3.2 Slide the end cap (item #3) over the front and rear of each step. Using the supplied #8 x 1/2" self drilling tek screw (item #8), screw the end cap to the bottom of the step.
4. Attaching the step to the mounting bracket:
  - 4.1 Set the step on the mounting brackets, and slide each support brace over the top of each mounting bracket. Attach the flat spacer plate (item #4) to the bottom of the step, between the support brace, and the top of the mounting bracket.
  - 4.2 Using the supplied 5/16-18 x 1" carriage bolt, washer, and flange nuts, (item #5, 6, 7), attach the step assembly, flat spacer plate and mounting bracket. **(NOTE: Some of the flange nuts are supplied in the specific bracket package, not the step package.)**
  - 4.3 Set the step plate in the correct position and tighten all fasteners.  
Torque all 5/16" fasteners to 19 LB FT.

## SERVICE PARTS LIST

ITEM	PART NO.	QTY	DESCRIPTION
1	551384	2	EXTRUSION-AL,77.62, GRIP STEP,BLK,415078
1	551385	2	EXTRUSION-AL,87.75,GRIP STEP,BLK,415088
2	551296	8	SUPPORT BRACE, UPPER, GALV
3	551394	4	CAP-END,GRIP STEP, BLACK, PLASTIC
4	551298	8	SPACER PLATE, LOWER, BLACK
5	108683	16	BOLT-CRG,5/16-18 X 1.0", SST
6	101369	16	WASHER-FLAT,5/16,SST
7	102680	16	NUT-SERR FLG,HX,SST,WX,5/16-18
8	107958	8	SCR-TEK #8-18 X 1/2",SST,BLK

**LIVERNE**  
TRUCK EQUIPMENT

(A LIVERNE Company)

1200 E. Birch St.

Brandon, SD 57005

REV B 03DEC10

REV A 10JUL09

551267 SHEET 1 OF 2 20AUG08

SERVICE PARTS LIST

MODEL NO. - 415078  
- 415088

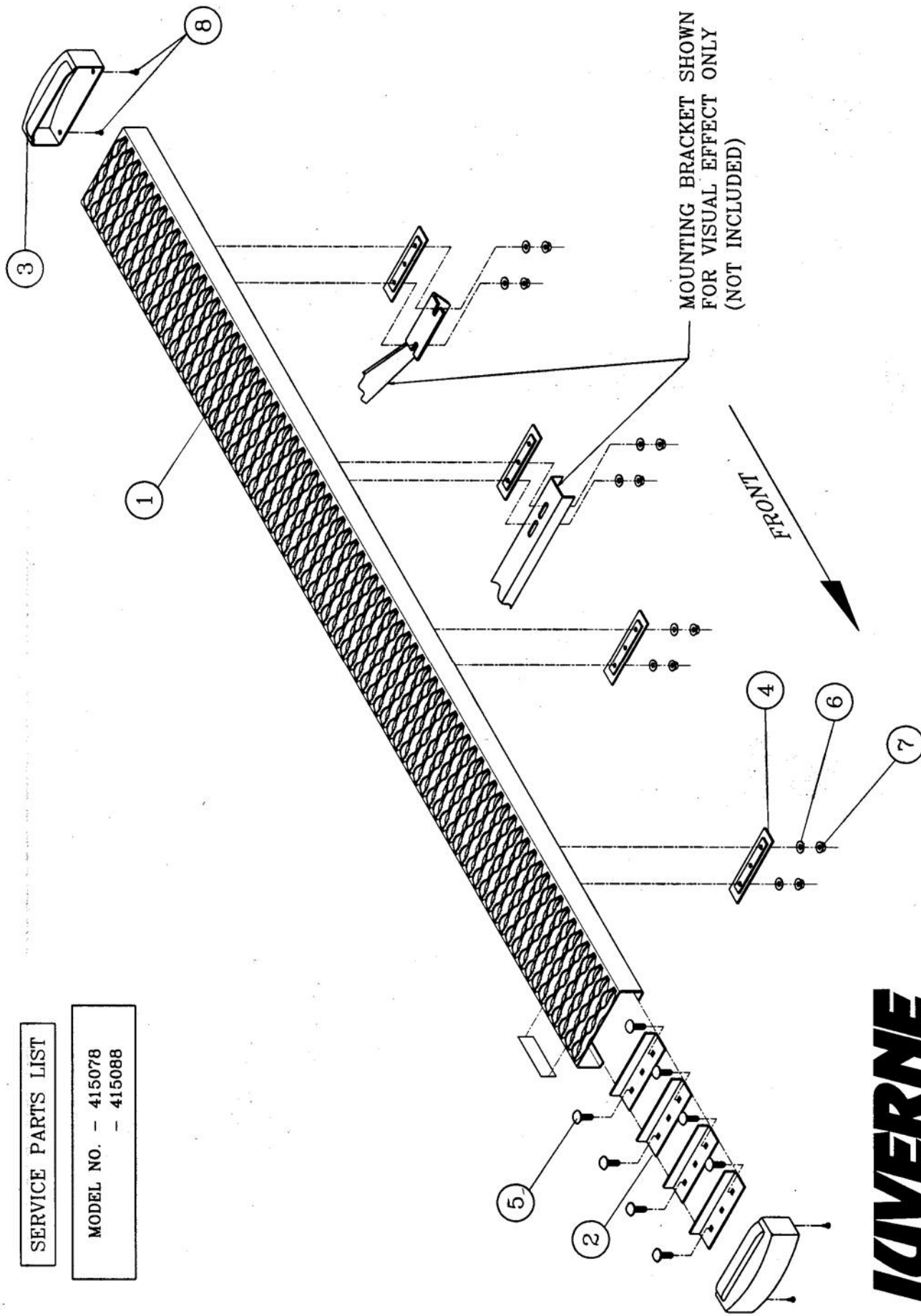

**LAVERNE**  
TRUCK EQUIPMENT  
(A LAVERNE Company)

1200 E. Birch St.  
Brandon, SD 57005

REV B 03DEC10  
REV A 10JUL09  
551267 SHEET 3 20AUG08

# INSTALLATION INSTRUCTIONS AND PARTS LIST

APPLICATION:

**MODEL 401335 STEP BRACKETS:**

**2011 RAM 3500/4500/5500 CHASSIS CAB CREW CAB PICKUPS**



1. READ INSTRUCTIONS COMPLETELY AND CHECK TO MAKE SURE THAT ALL REQUIRED PARTS (LISTED ON THE SERVICE PARTS LIST) ARE ON HAND BEFORE STARTING THE INSTALLATION.
  
2. ATTACH THE MOUNTING BRACKETS TO THE RIGHT SIDE AS FOLLOWS: [SEE FIG. 1]
  - 2.1 ON THE VERTICAL WALL OF THE ROCKER PANEL, INSTALL THE T-BOLT WELDMENT (ITEM #2) INTO THE LARGE OBROUND HOLE AND FISH THE OTHER END THROUGH 1/2" HEXAGON HOLE SS SHOWN IN FIG. 1. **USE CAUTION NOT TO DROP THE T-BOLT INSIDE OF THE ROCKER PANEL.** ATTACH THE FLAT NYLON WASHER (ITEM #4) TO THE END OF EACH BOLT. (THIS IS A RETAINER.)
  - 2.2 POSITION THE MOUNTING BRACKET (ITEM #1) SO THAT THE HOLES IN THE BRACKETS LINE UP WITH THE THREADED STUDS ON THE INSIDE WALL OF THE ROCKER PANEL. INSTALL THE 3/8-16 SERRATED FLANGE NUTS (ITEM #3). TIGHTEN BRACKET FASTENERS TO 19 LB FT.
  - 2.3 ASSEMBLE THE DOUBLE ENDED STUD & FASTENERS TO THE BRACKETS AS SHOWN:  
**[NOTE: THE REAR BRACKET WILL USE THE COUPLER AND EXTENSION ROD (ITEMS #9,10)]**
  - 2.4 INSTALL 3/8" SERRATED FLANGE NUTS (ITEM #3) BACKWARDS, TO THE END OF THE THREAD, ON EACH END OF THE DOUBLE ENDED STUD (ITEM #6).
  - 2.5 ON ONE END OF THE THREADED STUD, INSTALL A 3/8" FLAT WASHER (ITEM #7) AND THEN PUSH THE 3/4" THICK RUBBER WASHER (ITEM #5) AND FLAT WASHER TIGHT UP AGAINST THE SERRATED FLANGE NUT. **(THE END OF THE DOUBLE ENDED STUD SHOULD BE RECESSED BACK IN THE HOLE OF THE RUBBER WASHER APPROXIMATELY 3/16").**
  - 2.6 INSTALL THE OTHER END OF THE THREADED STUD ASSEMBLY THRU THE HOLE IN THE BRACKET (ITEM# 1) AS SHOWN AND INSTALL A 3/8" SERRATED FLANGE NUT. (FINGER TIGHT ONLY).
  - 2.7 POSITION SNUG AGAINST FRAME RAIL AND TIGHTEN ALL FASTENERS. THIS WILL REINFORCE THE STEP.
  
3. REPEAT STEPS 2.1 THRU 2.7 FOR THE DRIVER'S SIDE, BUT USE THE MOUNTING BRACKET (ITEM #8) FOR THE CENTER BRACKET LOCATION. YOU WILL NOT BE USING THE LOAD REACTION BOLT. SEE FIG.2
  
4. ATTACHING THE STEP ASSEMBLY:  
 PLEASE REVIEW THE INSTALLATION INSTRUCTIONS THAT ARE INCLUDED IN YOUR STEP ASSEMBLY FOR SPECIFIC DETAILS.

## SERVICE PARTS LIST

ITEM	PART NO.	QTY	DESCRIPTION
<b>PARTS INCLUDED IN THE BRACKET PACKAGE</b>			
1	551858	5	MOUNTING BRACKET, BLK, DODGE, GRIP STEP, 12 GA.
2	550147	6	T-BOLT WELDMENT, ZP
3	100181	30	NUT-SERRATED FLANGE,HEX,3/8-16,ZP
4	108442	12	WASHER-NYLON,.360 X 1.50 X .032
5	102592	5	WASHER -RUBBER,.354 X 1.00 X .748
6	551899	5	STUD DBL THREADED,3/8-16 X 11.00,ZP
7	100062	5	WASHER-FLT,3/8,ZP
8	552146	1	MOUNTING BRACKET, BLK, DODGE, GRIP STEP, 7 GA.
9	109185	2	HEX COUPLER, 3/8-16 X 1.75", ZP
10	104697	2	STUD FULL THREAD, 3/8-16 X 3.00,ZP



1200 E. Birch St.

Brandon, SD 57005

552149 SHEET 1 OF 3 02AUG13

SERVICE PARTS LIST

MODEL NO. -401335

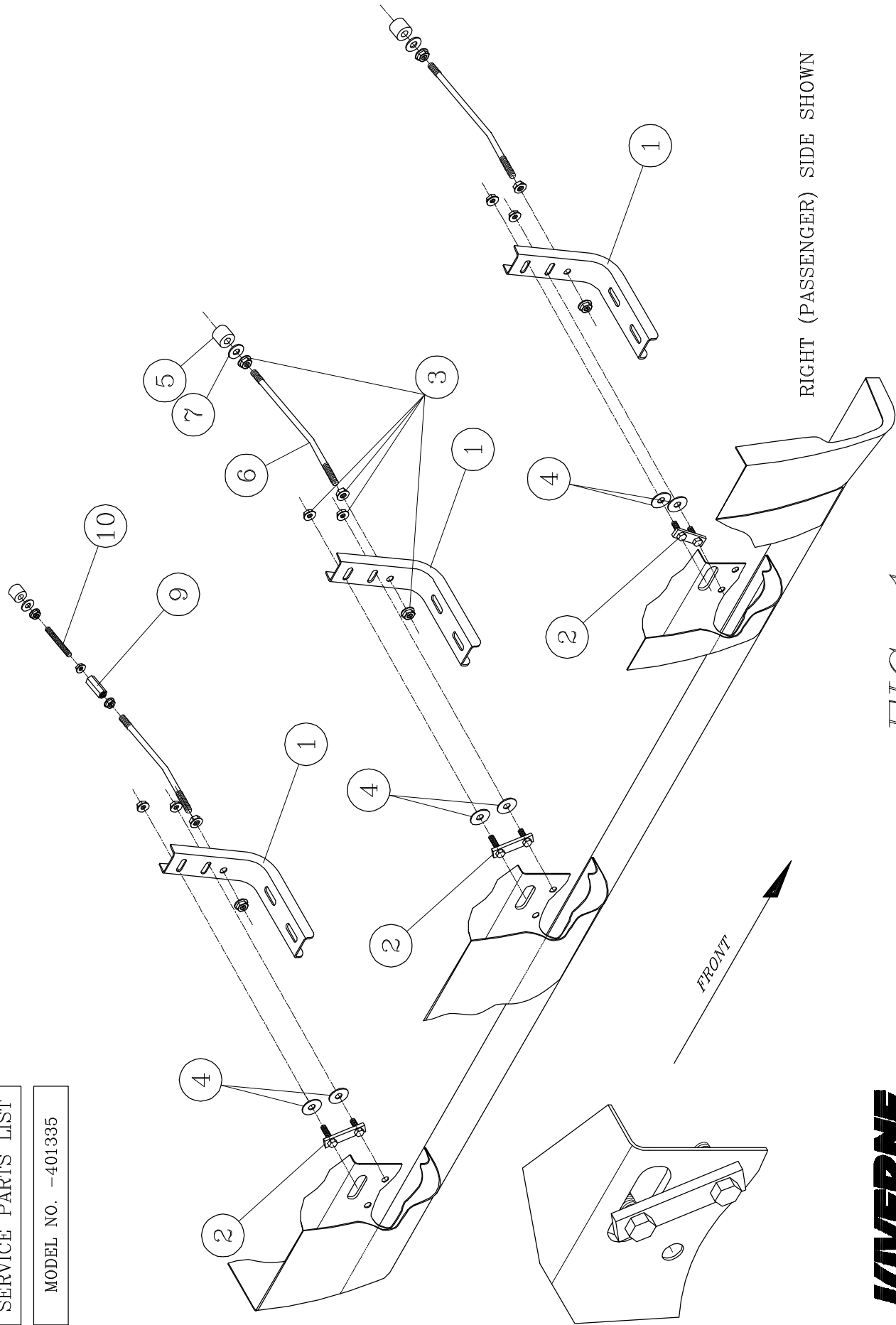

RIGHT (PASSENGER) SIDE SHOWN

FIG. 1

SERVICE PARTS LIST

MODEL NO. - 401335

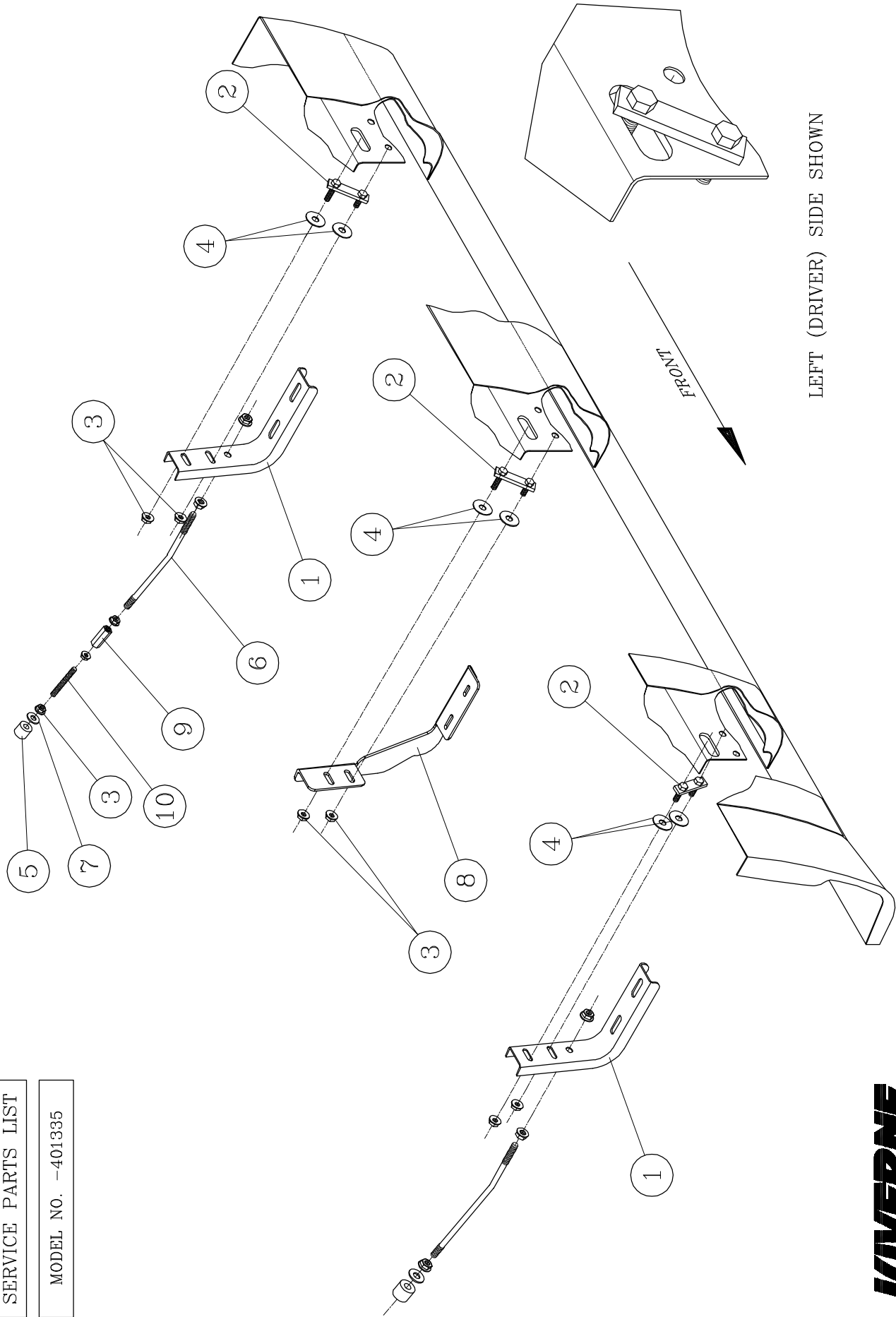

LEFT (DRIVER) SIDE SHOWN

FIG. 2



1200 E. Street St. Beverly, MA 01965