

INSTALLATION INSTRUCTIONS AND PARTS LIST

APPLICATION: MODEL **401741** GRIP-STEP/REGAL 7 BRACKETS ON:
2015 GM 2500/3500HD REGULAR CAB PICKUPS, GAS/DIESEL
BODY MOUNT APPLICATION



NO DRILL APPLICATION

1. READ INSTRUCTIONS COMPLETELY AND CHECK TO MAKE SURE THAT ALL REQUIRED PARTS (LISTED ON SERVICE PARTS LIST) ARE ON HAND BEFORE STARTING THE INSTALLATION.
2. ON THE LEFT SIDE OF THE VEHICLE PREASSEMBLE THE FRONT BRACKET (ITEMS #1, 3, 12) AS SHOWN IN **FIG. 1** USING THREE 3/8"-16 X 1.0" SCREWS, 3/8" FLAT WASHERS AND 3/8" FLANGE NUTS. (ITEMS #10, 7, 8). TORQUE TO 19 LB. FT.
3. ASSEMBLE THE LOAD REACTION STUDS AND HARDWARE (ITEMS #6 THRU #9) AS FOLLOWS.
 - 3.1. ON THE SHORT THREADED END OF THE LOAD REACTION STUD (ITEM #9), INSTALL A 3/8" SERRATED FLANGE NUT (ITEM #8) BACKWARDS TO THE BOTTOM OF THE THREAD. THEN INSTALL A 3/8" FLAT WASHER (ITEM #7) AND RUBBER "CUSHION" WASHER (ITEM #6) TIGHT UP AGAINST THE SERRATED FLANGE NUT. (THE END OF THE STUD MUST BE RECESSED IN THE RUBBER WASHER APPROX. 3/16").
 - 3.2. ON THE LONG THREADED END OF THE STUD, INSTALL A 3/8" SERRATED FLANGE NUT (ITEM #8) BACKWARDS TO NEAR TO THE BOTTOM OF THE THREADS
4. ATTACH THE LOAD REACTION STUD ASSEMBLIES TO THE MOUNTING BRACKETS AS SHOWN IN **FIG. 2**. INSERT THE STUD, FROM WHAT WILL BE THE INBOARD OR FRAME SIDE THRU THE LOWEST HOLE IN THE BENT FLANGE OF THE BRACKET THAT WILL ALLOW THE RUBBER WASHER TO SEAT FIRM AGAINST THE SIDE WALL OF THE FRAME. INSTALL A 3/8"-16 FLANGE NUT (ITEM #8) ON THE OUTBOARD END OF THE STUD (FINGER TIGHT ONLY).

NOTE:

DUE TO EXCESSIVE THREAD LOCKER IN THE BODY MOUNT BOLT AREA ON THE SILVERADO/SIERRA, USE CAUTION WHEN REMOVING THE BODY MOUNT BOLTS.

5. REMOVE THE FACTORY FRONT, AND REAR BODY MOUNT BOLTS AND INSTALL THE MOUNTING BRACKETS PER THE FOLLOWING INSTRUCTIONS:
 - 5.1. INSTALL THE FRONT MOUNTING BRACKET (ITEM #1, 3) TO THE FRONT BODY MOUNT AS SHOWN (LEAVE THESE FASTENERS FINGER TIGHT).
 - 5.2. INSTALL THE REAR MOUNTING BRACKET (ITEM #4) & WASHER (ITEM #11) TO THE REAR BODY MOUNT AS SHOWN (LEAVE THESE FASTENERS FINGER TIGHT).
6. INSTALL THE STEP BOARDS AS DESCRIBED BY THE INSTRUCTIONS INCLUDED WITH YOUR STEP BOARDS. (**NOTE: INSURE THAT THE MOUNTING BRACKETS DO NOT TOUCH THE INSIDE WALL OF THE BODY MOUNT HOUSING AND TORQUE THE BODY MOUNT FASTENERS TO MANUFACTURES SPECS**).
7. POSITION THE LOAD REACTION BOLT ASSEMBLY SO THAT THE RUBBER CUSHION IS SNUG UP AGAINST THE SIDE OF THE FRAME. TIGHTEN THE 3/8" FLANGE NUTS ON EITHER SIDE OF THE BRACKET TO 19LB. FT.
8. REPEAT STEPS 2-7 FOR THE RIGHT SIDE OF THE VEHICLE.

SERVICE PARTS LIST

| ITEM | PART NO. | QTY | DESCRIPTION |
|------|----------|-----|---|
| 1 | 552729 | 1 | BRACKET-MTG, FRONT, LH, 401541 |
| 2 | 553124 | 1 | BRACKET-MTG, FRONT, RH, 401741 |
| 3 | 552718 | 2 | BRACKET-MTG, FRONT, INBOARD, 581541 |
| 4 | 552731 | 1 | BRACKET-MTG, CENTER, LH, 401541 |
| 5 | 552730 | 1 | BRACKET-MTG, CENTER, RH, 401541 |
| 6 | 102592 | 4 | WSHR, RUBBER, .354 ID X 1.00 OD X .75 THK |
| 7 | 100062 | 10 | WSHR, FL, 3/8", .438 ID X 1.00 OD X .083" THK |
| 8 | 100181 | 18 | NUT, SERR FLG, HEX, 3/8-16 UNC, ZP |
| 9 | 104686 | 4 | STUD, -DBL ENDED, STL, 3/8-16 X 4.00", ZP |
| 10 | 100040 | 6 | SCR-HEX HD, 3/8"-16 X 1.0" UNC, ZP |
| 11 | 108882 | 2 | WSHR, FL, .59 ID X 1.06 OD X .19 THK, ZP |
| 12 | 551571 | 2 | BRACKET, 90° 3 HOLE BLACK |

SERVICE PARTS LIST

MODEL NO. - 401741

FIG. 2

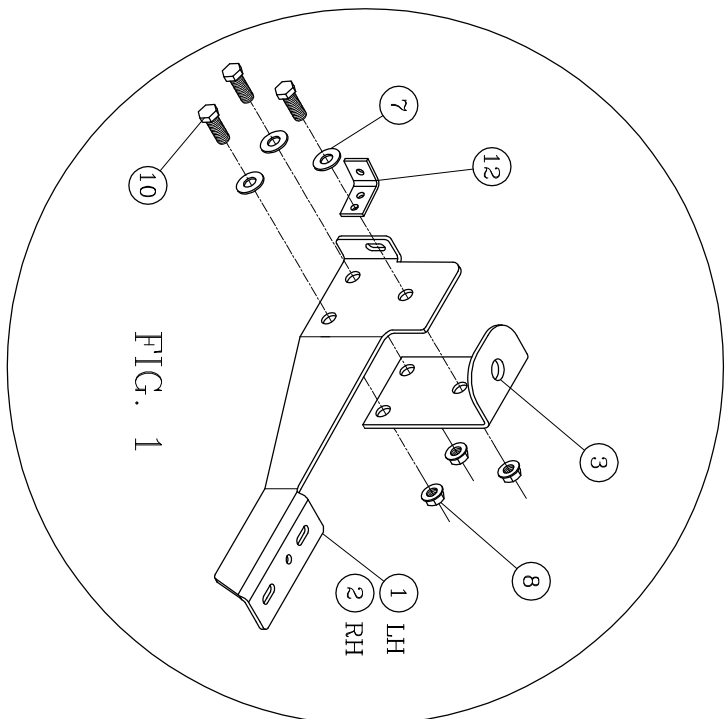
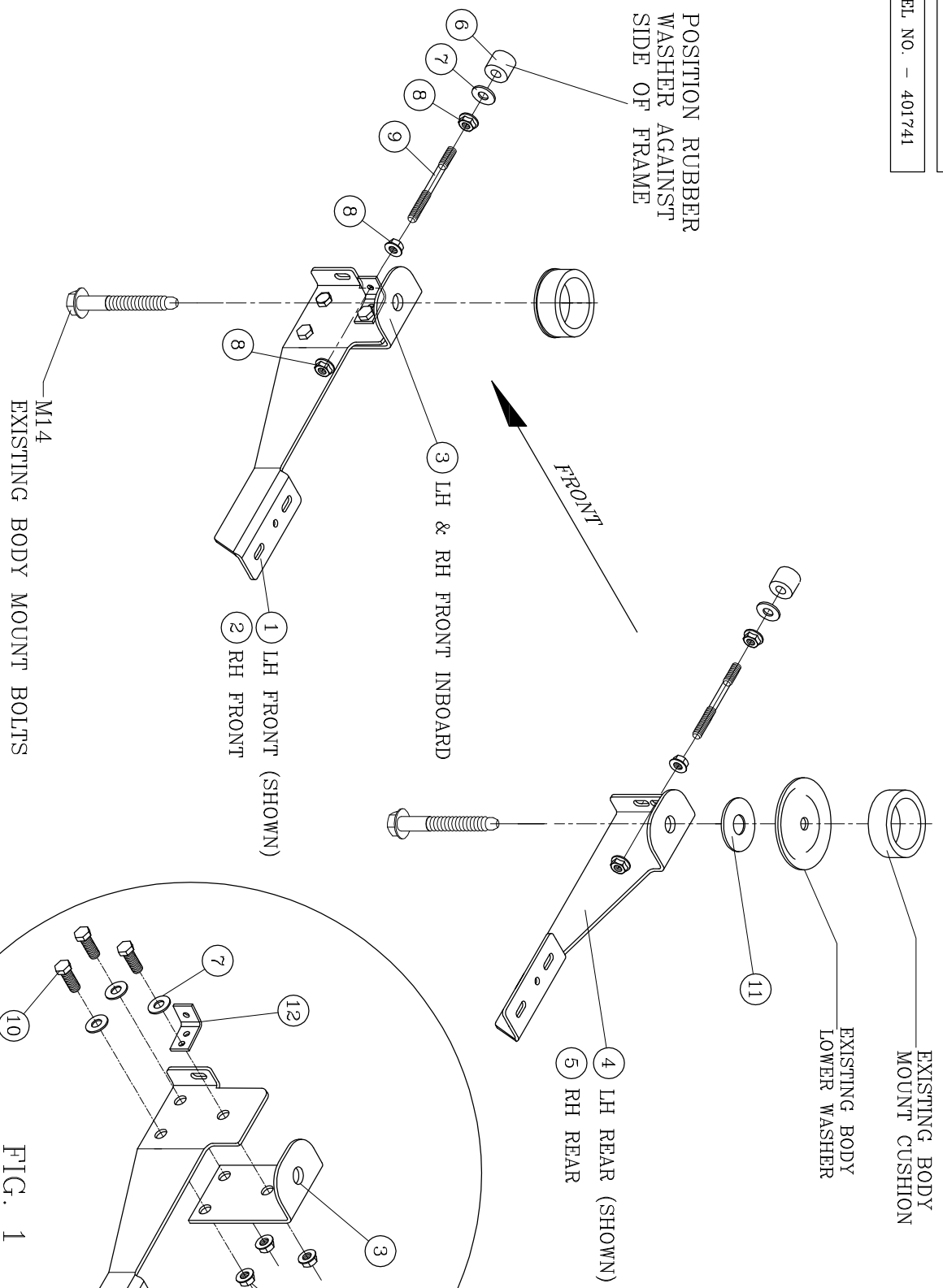

FIG. 1



LEFT (DRIVER) SIDE SHOWN
 -RIGHT (PASSENGER) SIDE OPPOSITE-