

# INSTALLATION INSTRUCTIONS FOR MOUNTING

LUVERNE BULL BARS WITH THE FOLLOWING MODEL NOS.:  
300210, 300250, 300310, 300350 – BULL BAR ASSEMBLY  
300712 – BRACKET PACKAGE

2007 AND NEWER 2500/3500 HD CHEVROLET SILVERADO  
2007 AND NEWER 2500/3500 HD GMC SIERRA



1. READ THE INSTRUCTIONS COMPLETELY AND CHECK TO MAKE SURE THAT ALL OF THE REQUIRED PARTS ARE ON HAND BEFORE STARTING THE INSTALLATION. THE CARTONS SHOULD CONTAIN:  
  
(1) BULL BAR  
(1) BRACKET PACKAGE:  
    (1) MOUNTING BRACKET, RH  
    (1) MOUNTING BRACKET, LH  
    (1) FASTENER PACKAGE
2. LOOSEN AND REMOVE THE TWO BOLTS AND NUT THAT HOLD THE TOW HOOKS TO THE END OF THE FRAME. REMOVE THE TOW HOOKS (YOU WILL NOT REINSTALL THEM).
3. INSTALL THE RIGHT HAND MOUNTING BRACKET (ITEM #2) ON TO THE END OF THE FRAME AS SHOWN IN FIG 1. **(NOTE: WHEN INSTALLING THE BRACKET, YOU MAY NEED TO TRIM 1/2" OFF THE BOTTOM OF THE TOW HOOK HOLE IN THE AIR DAM WITH WITH A UTILITY KNIFE TO MAKE ROOM FOR THE BRACKET).** FASTEN WITH THE 1/2-13 X 1-1/4 BOLTS (ITEM #7), 1/2" FLAT WASHERS (ITEM #8), AND THE 1/2-13 SERRATED FLANGE NUTS (ITEM #9). TORQUE THE BOLTS TO 64 LB-FT.
4. REPEAT STEP #3 ON THE LEFT SIDE.

**NOTE: BASED ON YOUR STATE AND LOCAL LAWS, DETERMINE IF YOU NEED TO RELOCATE YOUR LICENSE PLATE PRIOR TO STEP #5. REMOVE/RELOCATE/INSTALL YOUR LICENSE PLATE BRACKET AND LICENSE PLATE BEFORE MOUNTING THE BULL BAR TO YOUR VEHICLE (SEE FIG 1).**

5. INSTALL THE BULL BAR TO THE MOUNTING BRACKETS. THE WELDED TABS ON THE BULL BAR FIT ON THE OUTBOARD SIDE OF THE MOUTING BRACKETS. FASTEN WITH THE 3/8-16 X 1-1/4 BOLTS (ITEM #4), 3/8" FLAT WASHERS (ITEM #5) (ONE ON THE BOLT SIDE, ONE ON THE NUT SIDE OF THE BRACKET), AND 3/8-16 SERRATED FLANGE NUTS (ITEM #6). ADJUST THE BULL BAR IN AND OUT AND UP AND DOWN AS NEEDED, THEN TIGHTEN THE FASTENERS. TORQUE THE BOLTS TO 26 LB-FT.



(A LUVERNE Company)

1200 E. Birch St.

Brandon, SD 57005

REVA 20JAN16  
305007 SHEET 1 OF 3 16SEP10

**SERVICE PARTS LIST**

ITEM	PART NO.	QTY	DESCRIPTION
1	300210	1	BULL BAR, 4" TOP MNT, SST,W/O SKD PL
1	300250	1	BULL BAR, 4" TOP MNT, BLK,W/O SKD PL
1	300310	1	BULL BAR, 3" TOP MNT, SST,W/O SKD PL
1	300350	1	BULL BAR, 3" TOP MNT, BLK,W/O SKD PL
2	305004	1	MOUNTING BRACKET, RH
3	305005	1	MOUNTING BRACKET, LH
4	100047	4	HEX HEAD SCREW, 3/8-16 X 1-1/4, ZP
5	100062	8	FLAT WASHER, 3/8", ZP
6	100181	4	SERRATED FLANGE NUT, 3/8-16, ZP
7	100086	4	HEX HEAD SCREW, 1/2-13 X 1-1/4, ZP
8	100118	4	FLAT WASHER, 1/2", ZP
9	100123	4	SERRATED FLANGE NUT, 1/2-13, ZP
10	108023	4	HEX HEAD SCREW, SELF TAP, 1/4-20, ZP
11	100170	4	NUT, PLASTIC, SQUARE, 1/4", WHITE



(A LIVERNE Company)

1200 E. Birch St.

Brandon, SD 57005

REVA 20JAN16  
305007 SHEET 1 OF 3 16SEP10

SERVICE PARTS LIST  
 MODEL NO. - 300712

fig. 1

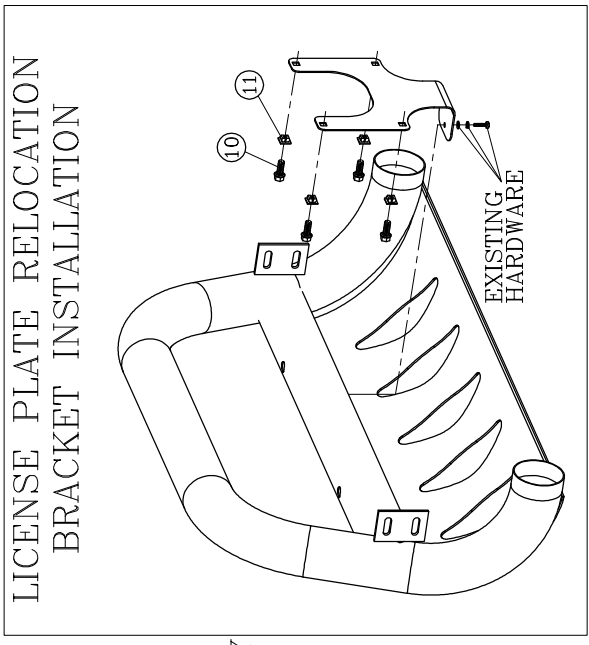
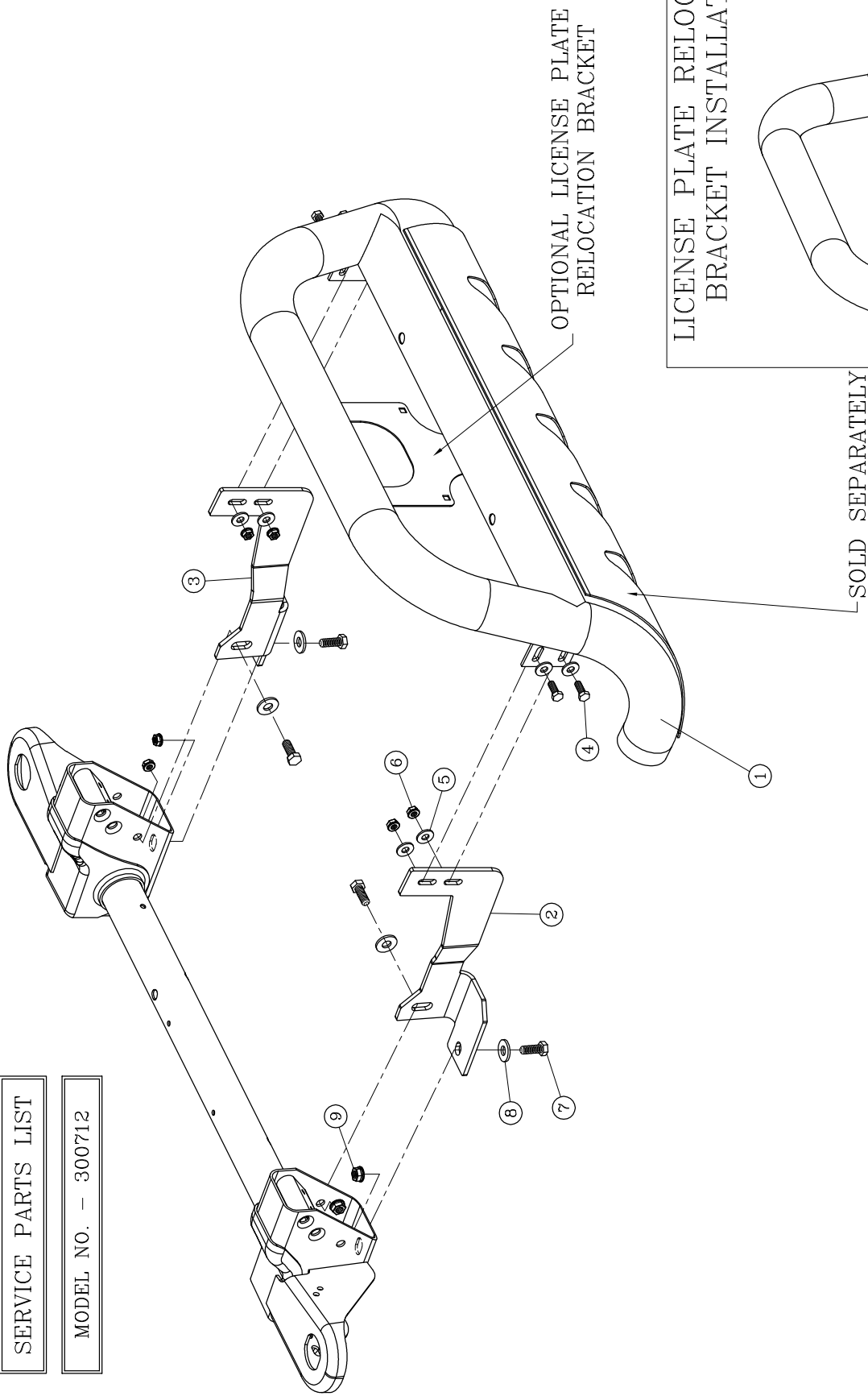

**LIVERNE**  
 ISO9001 QS9000 CERTIFIED TRUCK  
 1200 Birch Street EQUIPMENT  
 Brandon, SD 57005 INC.