

# INSTALLATION INSTRUCTIONS FOR MOUNTING

300210, 300250, 300310, 300350 – BULL BAR ASSEMBLY  
301441 – BRACKET PACKAGE

## **301441 SPRINTER VAN 2014-CURRENT**

### **INSTALLATION INSTRUCTIONS**

READ THE INSTRUCTIONS COMPLETELY AND CHECK TO MAKE SURE THAT ALL OF THE REQUIRED PARTS ARE ON HAND BEFORE STARTING THE INSTALLATION.

1. REMOVE FACTORY LICENSE PLATE BRACKET, SHOWN IN FIG.

2. ONCE THE LICENSE PLATE BRACKET IS REMOVED, THERE ARE TWO M8 BOLTS THAT WILL NEED TO BE REMOVED. THERE ARE ALSO TWO 8MM TORX BOLTS IN THE CUTOUT ABOVE THE LICENSE PLATE BRACKET. SHOWN IN FIG. 2

3. INSTALL THE BRACKETS (ITEM #2&3) USING THE M8 FASTENERS. USING THE TWO M8-40, LOCK WASHERS AND WASHERS (ITEM #4,5&6) FASTEN THROUGH THE TOP HOLES AND THE TWO M8-30, LOCK WASHERS, WASHERS, (ITEM #5,6&7) FASTEN THROUGH THE FORWARD FACING HOLES IN THE BRACKET. MAKE SURE TO LEAVE THESE LOOSE TO FASTEN ALL THE BOLTS.

4. ONCE THE ALL THE FASTENERS ARE IN PLACE TIGHTEN THEM DOWN TO 19 FT LBS.

5. REINSTALL THE LICENSE PLATE BRACKET SHOWN IN FIG. 1. YOU WILL NEED TO CUT TWO NOTCHES OUT OF THE TOP EDGE OF THE PLASTIC STARTING AT 2" FROM BOTH SIDES AND CUT THROUGH TO 4.5" FROM BOTH SIDES. CUTTING THESE NOTCHES OUT WILL LET THE ORIGINAL LICENCE PLATE BRACKET TO LAY FLAT IN THE FACTORY POSITION.

6. PLACE THE BULL BAR IN PLACE USING THE SUPPLIED FASTENERS (ITEM #8,9&10). THE BOLT AND WASHER WILL BE PLACED ON THE OUTSIDE WHILE THE FLANGE NUT WILL FASTEN FROM THE INSIDE. ONCE ALL THE FASTENERS ARE IN PLACE POSITION THE BULL BAR AND TIGHTEN THE FASTENERS DOWN TO 25 FT LBS.

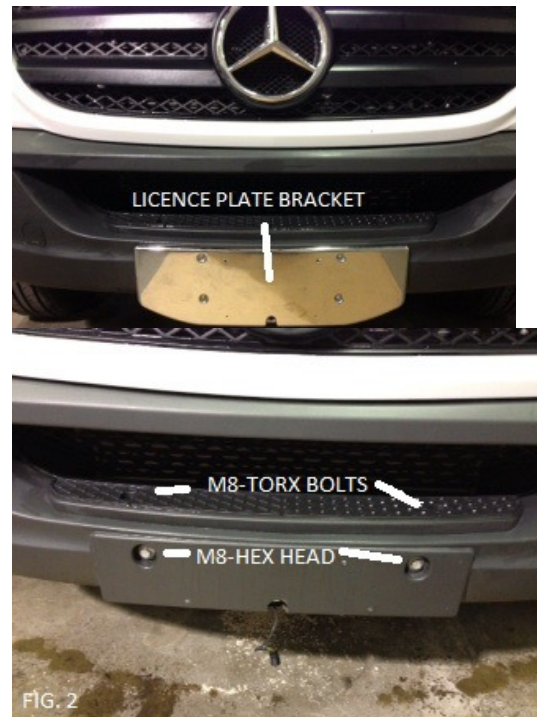

**LIVERNE**  
TRUCK EQUIPMENT

(A LIVERNE Company)

1200 E. Birch St.

Brandon, SD 57005

REV A 19JAN16  
305065 PAGE 1 OF 3 11MAR14

**SERVICE PARTS LIST**

ITEM	PART NO.	QTY	DESCRIPTION
1	300210	1	BULL BAR, 4" TOP MNT, SST,W/O SKD PL
1	300250	1	BULL BAR, 4" TOP MNT, BLK,W/O SKD PL
1	300310	1	BULL BAR, 3" TOP MNT, SST,W/O SKD PL
1	300350	1	BULL BAR, 3" TOP MNT, BLK,W/O SKD PL
2	305063	1	MOUNTING BRACKET-LH, BLACK
3	305064	1	MOUNTING BRACKET-RH, BLACK
4	109482	2	SCR-HX HD, M8-1.25X40, ZP
5	100030	4	WSHR-LK, 5/16, ZP
6	100034	4	WSHR-FL, 5/16, ZP
7	100180	2	SCR-HX HD, M8-1.25X30, BZP
8	100040	4	SCR-HX HD, 3/8-18X1", ZP
9	100062	4	WSHR-FL, 3/8, ZP
10	100181	4	NUT-HEX FLG, 3/8-18, ZP
11	108023	4	HEX HEAD SCREW, SELF TAP, 1/4-20, ZP
12	100170	4	NUT, PLASTIC, SQUARE, 1/4", WHITE



(A LUPERNE Company)

1200 E. Birch St.

Brandon, SD 57005

REV A 19JAN16  
305065 PAGE 2 OF 3 11MAR14

SERVICE PARTS DRAWING

MODEL NO. - 301441

FIG. 1

LICENSE PLATE RELOCATION  
BRACKET INSTALLATION

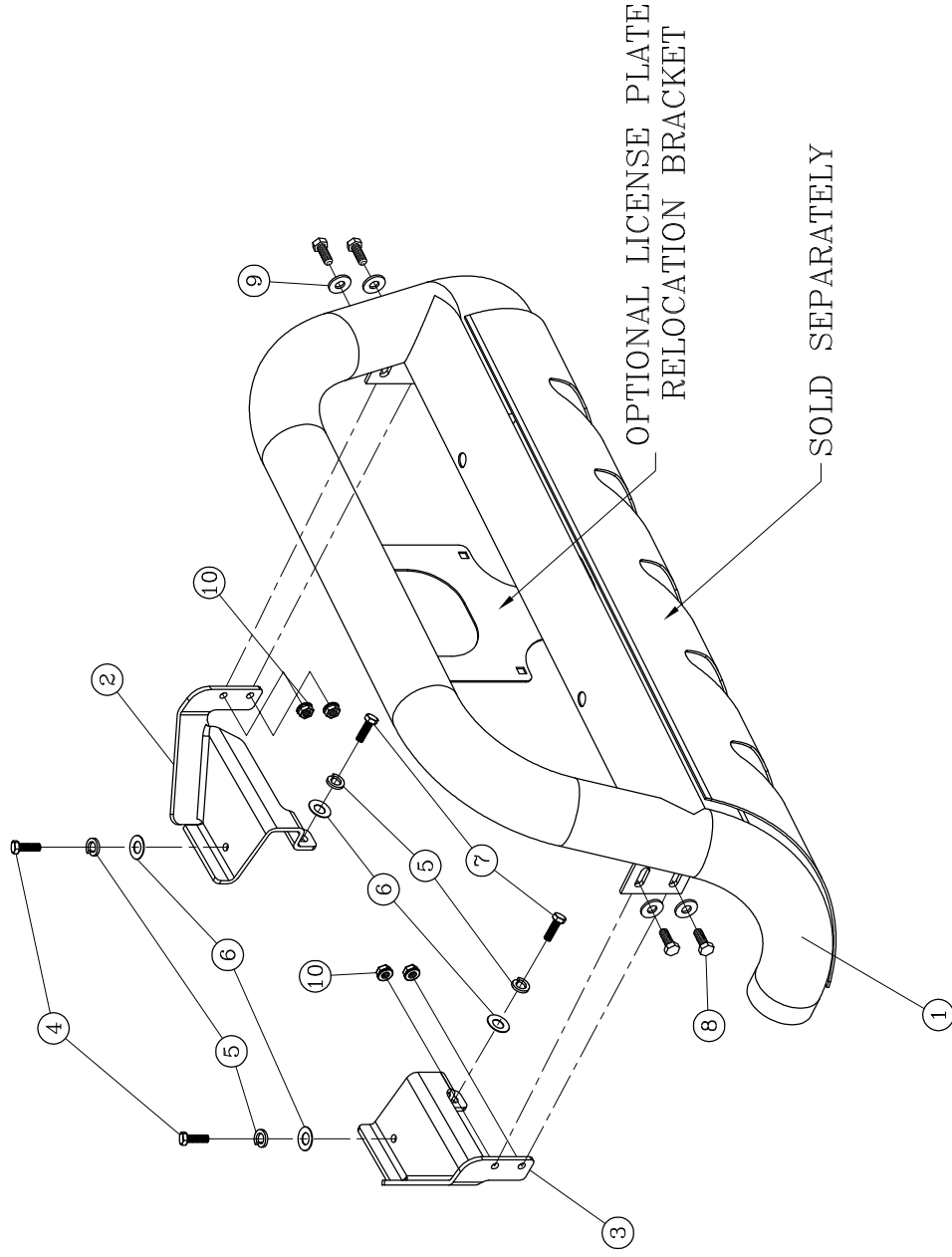
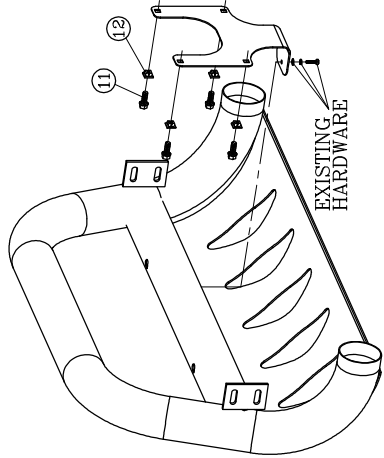

**LOVERNE**  
TRACTOR EQUIPMENT

(A LOVERNE Company)

1200 E. Birch St.      Rapid City, SD 57705

305065 SHEET 3 OF 3 11MAR14  
REV A