

LIVERNE

TRUCK EQUIPMENT

205930

SPRINTER VAN 2014-CURRENT

INSTALLATION INSTRUCTIONS

READ THE INSTRUCTIONS COMPLETELY AND CHECK TO MAKE SURE THAT ALL OF THE REQUIRED PARTS ARE ON HAND BEFORE STARTING THE INSTALLATION.

1. REMOVE FACTORY LICENSE PLATE BRACKET, SHOWN IN *fig. 1*.

2. ONCE THE LICENSE PLATE BRACKET IS REMOVED, THERE ARE TWO M8 BOLTS THAT WILL NEED TO BE REMOVED. THERE ARE ALSO TWO 8MM TORX BOLTS IN THE CUTOUT ABOVE THE LICENSE PLATE BRACKET. SHOWN IN *fig. 2*.

3. INSTALL THE BRACKETS (ITEM #2 & #3) USING THE TWO M8 X 1.25 X 40mm HEX SCREWS (ITEM #6), 5/16" LOCK WASHERS (ITEM #13) AND 5/16" FLAT WASHERS (ITEM #15). FASTEN THROUGH THE TOP HOLES AND THE TWO M8 X 1.25 X 30mm HEX SCREWS (ITEM #7), 5/16" LOCK WASHERS (ITEM #13) & 5/16" FLAT WASHERS (ITEM #15). FASTEN THROUGH THE FORWARD FACING HOLES IN THE BRACKET. LEAVE THESE LOOSE AT THIS TIME.

4. BEFORE YOU MOUNT THE TUFF GUARD INTO PLACE, DEPENDING ON YOUR STATE, THERE IS AN OPTIONAL LICENSE PLATE BRACKET (ITEM #4) THAT WILL NEED TO BE INSTALLED ON ONE OF THE TUBES, USING THE TWO SELF DRILLING SCREWS (ITEM #9).

5. FASTEN THE TUFF GUARD TO THE BRACKETS INSTALLED ON THE TRUCK USING THE FOUR 1/2"-13 X 1-1/4" CARRIAGE BOLTS (ITEM #5), 1/2" LOCK WASHERS (ITEM #12), 1/2" FLAT WASHERS (ITEM #14) AND 1/2"-13 ACORN NUTS (ITEM #10). SNUG UP THE NUTS.

6. TIGHTEN THE BOLTS FASTENING THE MOUNTING BRACKETS TO THE VEHICLE.

7. TIGHTEN THE BOLT FASTENING THE GRILLE GUARD TO THE MOUNTING BRACKETS.

8. TO REINSTALL THE LICENSE PLATE BRACKET SHOWN IN *fig. 1*. YOU WILL NEED TO CUT TWO NOTCHES OUT OF THE TOP CORNERS OF THE PLASTIC BRACKET STARTING AT 2" DOWN FROM THE TOP AND CUT THROUGH TO 4.5" FROM BOTH SIDES. CUTTING THESE NOTCHES OUT WILL LET THE ORIGINAL LICENCE PLATE BRACKET LAY FLAT IN THE FACTORY POSITION.





SERVICE PARTS LIST

ITEM	PART NO.	QTY	DESCRIPTION
1	205530	1	GUARD-TUBULAR,3" BLACK
2	205931	1	MOUNTING BRACKET-LH, BLACK
3	205932	1	MOUNTING BRACKET-RH, BLACK
4	205865	1	LICENSE PLATE BRACKET
5	109515	4	BOLT-CARRIAGE, 1/2"-13 X 1-1/4". BZP
6	109482	2	SCREW-HEX HEAD, M8 X 1.25 X 40mm, ZP
7	106719	2	SCREW-HEX HEAD, M8 X 1.25 X 30mm, BZP
8	108023	4	SCREW-SELF TAPPING, 1/4"-20 X 1/2", ZP
9	103778	2	SCREW-DRILL, 1/4" X 3/4", ZP , STL
10	109510	4	NUT-ACORN, 1/2"-13, BLACK ZP
11	100170	4	NUT-PLASTIC EXPANDING,1/4", WHITE
12	109511	4	WASHER-LOCK, 1/2", BLACK ZP
13	100030	4	WASHER - LOCK, 5/16", ZP
14	100940	4	WASHER-FLAT, SAE, 1/2", BLACK ZP
15	100034	4	WASHER-FLAT, 5/16", ZP
16	102500	4	TUBE INSERT-3"
17	100252	1	SERIAL NUMBER DECAL

SERVICE PARTS DRAWING

MODEL NO. - 205930

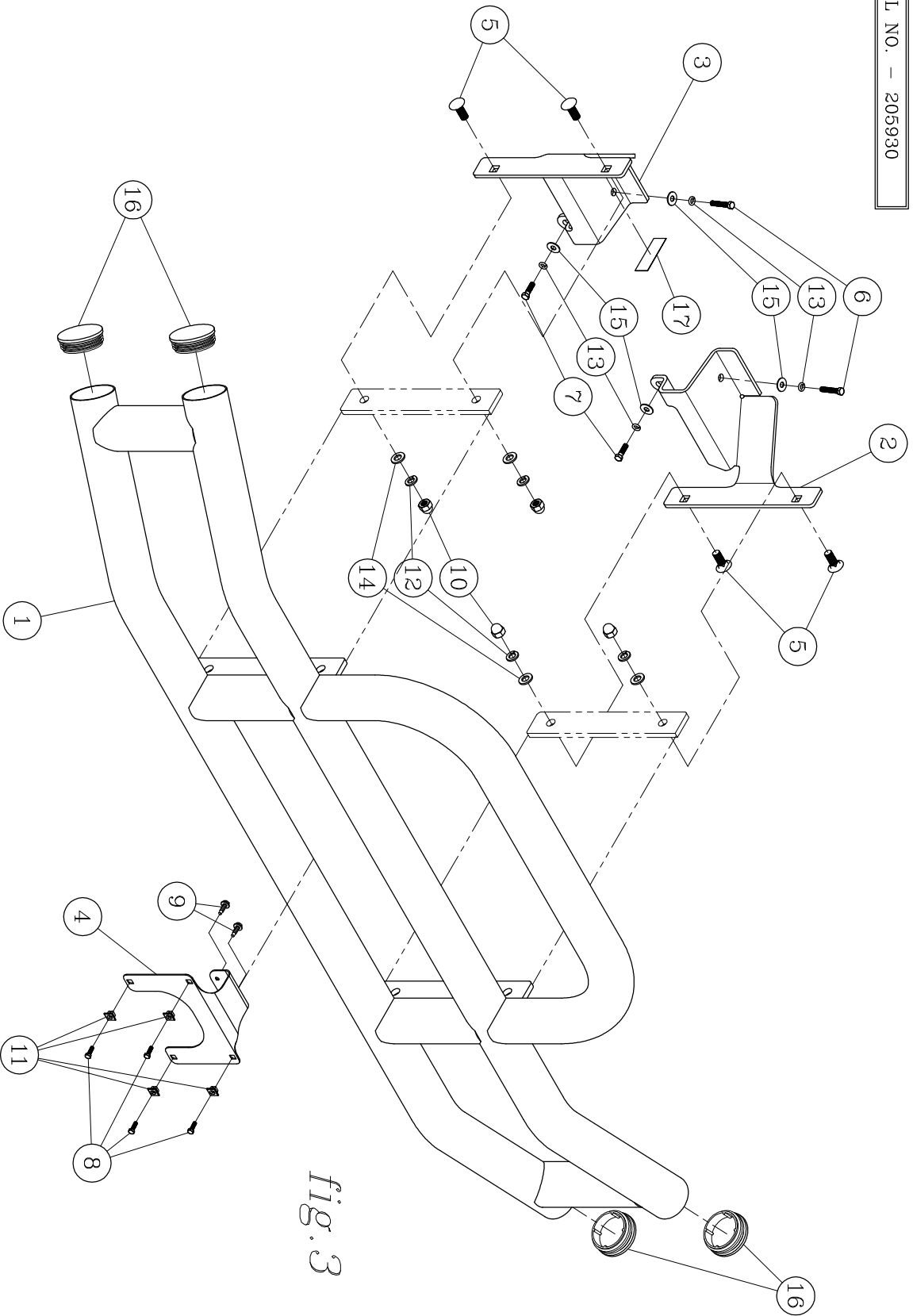

fig. 3

