

### Parts List

1	Driver / left side bar
1	Passenger / right side bar
1	Driver / left side mounting bracket, front
1	Passenger / right side mounting bracket, front
1	Driver / left side mounting bracket, center
1	Passenger / right side mounting bracket, center
1	Driver / left side mounting bracket, rear
1	Passenger / right side mounting bracket, rear
12	Hex bolt, M10 x 30mm
12	Flat washer, M10
12	Lock washer, M10

### Level of Difficulty

Easy



Scan for helpful install tips

### Product Image



### Torque Specifications

	Torque Specifications	
METRIC	M6 bolt	3 ft.-lbs.
	M8 bolt	7 ft.-lbs.
	M10 bolt	16 ft.-lbs.
SAE	M12 bolt	28 ft.-lbs.
	1/4" bolt	3 ft.-lbs.
	5/16" bolt	7 ft.-lbs.
	3/8" bolt	16 ft.-lbs.
	7/16" bolt	20 ft.-lbs.
	1/2" bolt	28 ft.-lbs.

### Brackets

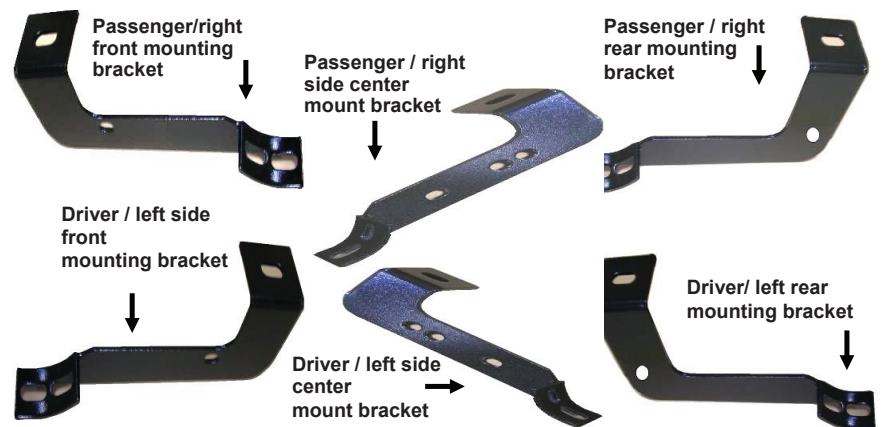

### Notes and Maintenance

Before you begin installation, read all instructions thoroughly.

Proper tools will improve the quality of installation and reduce the time required.

To protect the product, wax after installing. Regular waxing is recommended to add a protective layer over the finish. Do not use any type of polish or wax that may contain abrasives that could damage the finish.

For stainless steel and aluminum, polish may be used to clear small scratches and scuffs on the finish. Mild soap may be used also to clean the product.

Refer to the table to the left when securing hardware during the installation process to help prevent damage to the product or vehicle.

## PROCEDURE:

1. REMOVE CONTENTS FROM BOX. VERIFY ALL PARTS ARE PRESENT. READ INSTRUCTIONS CAREFULLY BEFORE STARTING INSTALLATION.
2. Starting at the Passenger/Right side-front of the vehicle, remove the front factory body bolt & washer. From the list above select the Passenger/Right side front mounting bracket and secure to vehicle with factory Hex Bolt, 12mm Flat Washer, & Lock Washers (**Fig 1**). Snug but do not tighten hardware at this time.
3. Moving to the Passenger/Right side middle of the vehicle, remove the front factory body bolt & washer. From the list above select the Passenger/Right side Middle mounting bracket and secure to vehicle with factory Hex Bolt, Flat Washer, Lock Washers (**Fig 2**). Snug but do not tighten hardware at this time.
4. Remove the passenger/Right side rear factory body bolt, from the list above select the Passenger/Right side rear mounting bracket and secure it with factory Hex Bolt, Flat Washer, Lock Washers (**Fig 3**) Shows bracket attached. Snug but do not tighten hardware at this time.
5. Select the Passenger/Right side sidebar and secure it to all mounting brackets with the (6) 10mm x 30mm hex bolts, (6) 10mm lock washer, and (6) 10mm flat washer. (**Fig 4**) shows side bar attached to all brackets, Snug but do not tighten hardware at this time.
6. Level and align Sidebar properly; then tighten all hardware at this time.
7. Repeat steps 2-6 for Driver/left sidebar.
8. Do periodic inspections to the installation to make sure all hardware is secure and tight.

## FRONT PASSENGER SIDE

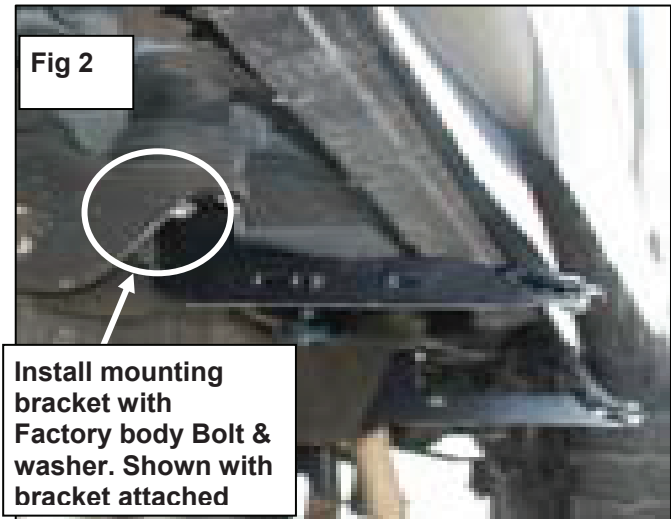
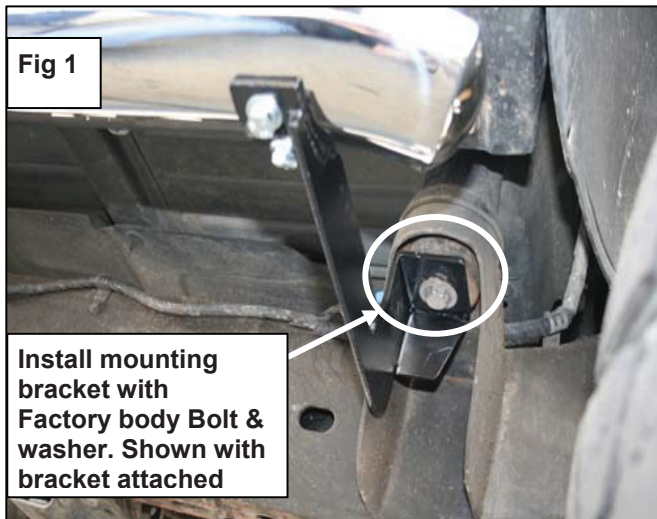

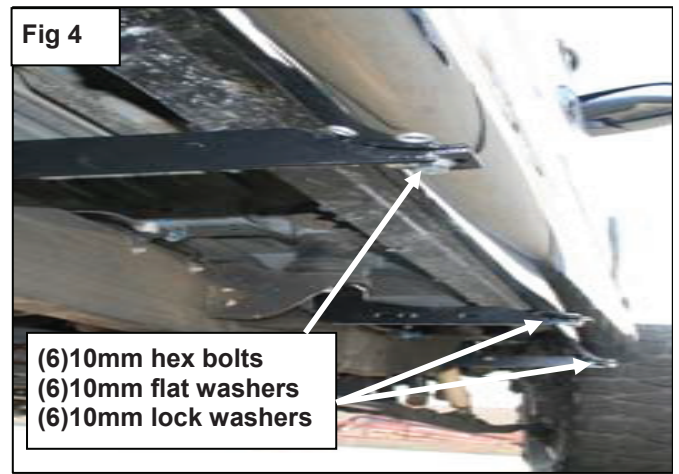
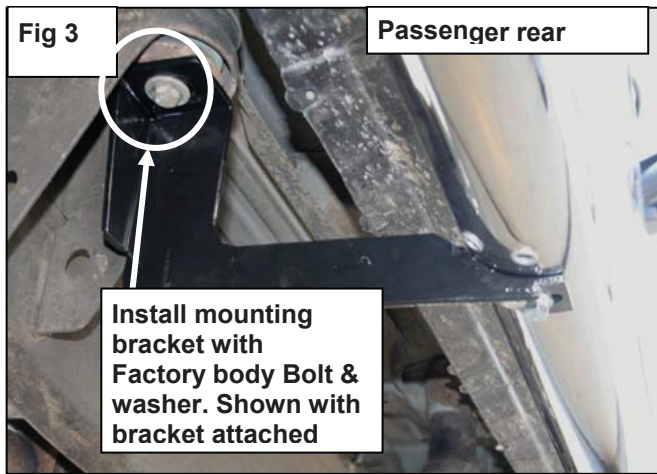

## INSTALLTION ALERT

General Motors has made changes to their late model 2010 and 2012 Chevrolet Silverado and GMC Sierra Light Duty and Heavy Duty Trucks and these changes affect the installation of our Side Bars.

Currently, all Side Bars manufactured for GM trucks use the factory body mount bolts to attach the bars and brackets to the truck. In years past, GM used a fixed nut that was welded in place to the chassis of the truck. Starting late 2010, GM has now gone to a loose nut that is surrounded by a "Cage Nut" which has two tabs on either side of the nut to keep it from loosening. Along with this cage nut, GM is also using Heavy Duty Loc-tite on the Body Mount Bolts for added protection.

Due to this change, Aries is recommending **EXTREME CARE** when removing the factory body mount bolts from these trucks. **Loosen and re-tighten all body mount bolts by hand! DO NOT use Impact Tools of any kind!** If bolts become increasingly tight as you are loosening them you may need to retighten & loosen the bolt several times to clear the loc-tite from the threads Failure to follow this instruction could cause the body mount bolts to seize and the tabs of the 'Cage Nut' to bend allowing the nut to spin freely inside Chassis floor board!

Most of clients have been installing the existing side bar applications on these new trucks with no issues, but please be sure to follow our recommendation to prevent any installation issues. If you have any questions, please feel free to call our Customer Service Department at 888-800-2743.

