

INSTALLATION INSTRUCTION

2012 MISUBISHI OUTLANDER SIDE BAR

PART# 208005-2/208005

NOTICE:

- ≡ Please read the instruction completely for easy installation, which will also help you to avoid scratches or other potential damages to your appealing car.
- ≡ Please periodically check and retighten all the hardware and clean the investment for a refresh look.

PARTS LIST:

No.	Name	Qty	Remarks	No.	Name	Qty	Remarks
①	Side bar	2		⑨	T-bolt	2	M8x30
②	Front bracket	2		⑩	Plastic clip	2	D8
③	Rear bracket	2		⑪	Enlarged washer	2	D8
④	T-bolt	6	M10x30	⑫	Spring washer	10	D8
⑤	Plastic clip	6	D10	⑬	Hex nut	2	M10
⑥	Enlarged washer	6	D10	⑭	Hex bolt	8	M8x25
⑦	Spring washer	6	D10	⑮	Washer	8	D8
⑧	Hex nut	6	M10				

ASSEMBLY PROCEDURE:

- Step 1: Check all the contents are available in accordance with the above list.
- Step 2: Install the Mount Brackets in vehicle bottom using the hardware ④⑤⑥⑦⑧ and ⑨⑩⑪⑫⑬ as Pic1
- Step 3: Install the side bar on the vehicle using the hardware ⑭⑮⑯ as Pic1
- Step 4: After checking for proper clearance and alignment of the Grille Guard on the vehicle, fully tighten all hardware.

Pic1

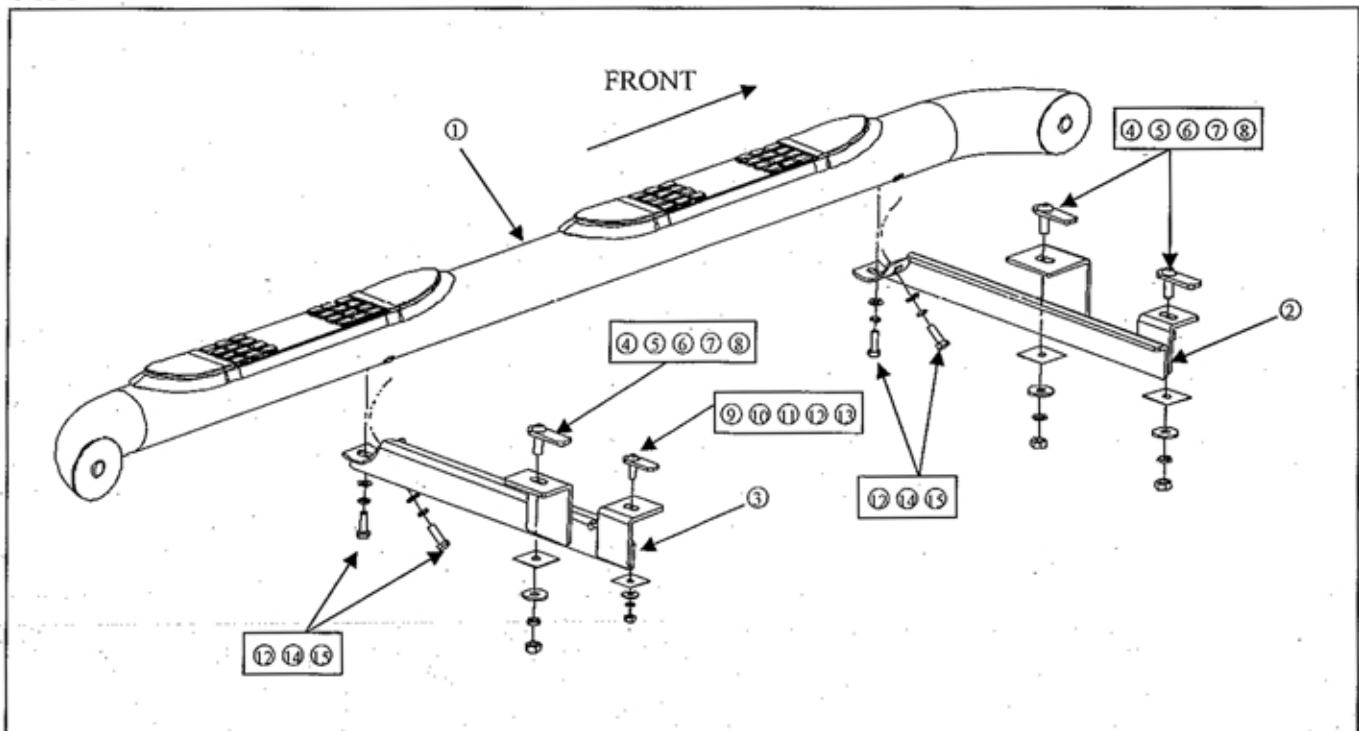

DISCLAIMER: We are not responsible for any quality problems caused by improper installation and use.