

INSTALLATION INSTRUCTIONS

2007-14 WRANGLER WINCH RECIEVER PLATE BRACKET FOR AL15600

PART # 15600WRB

Photo of parts shown for reference

PARTS LIST:

Qty's	Description	Qty's	Description
1	Winch receiver plate bracket	8	12mm Speed nuts

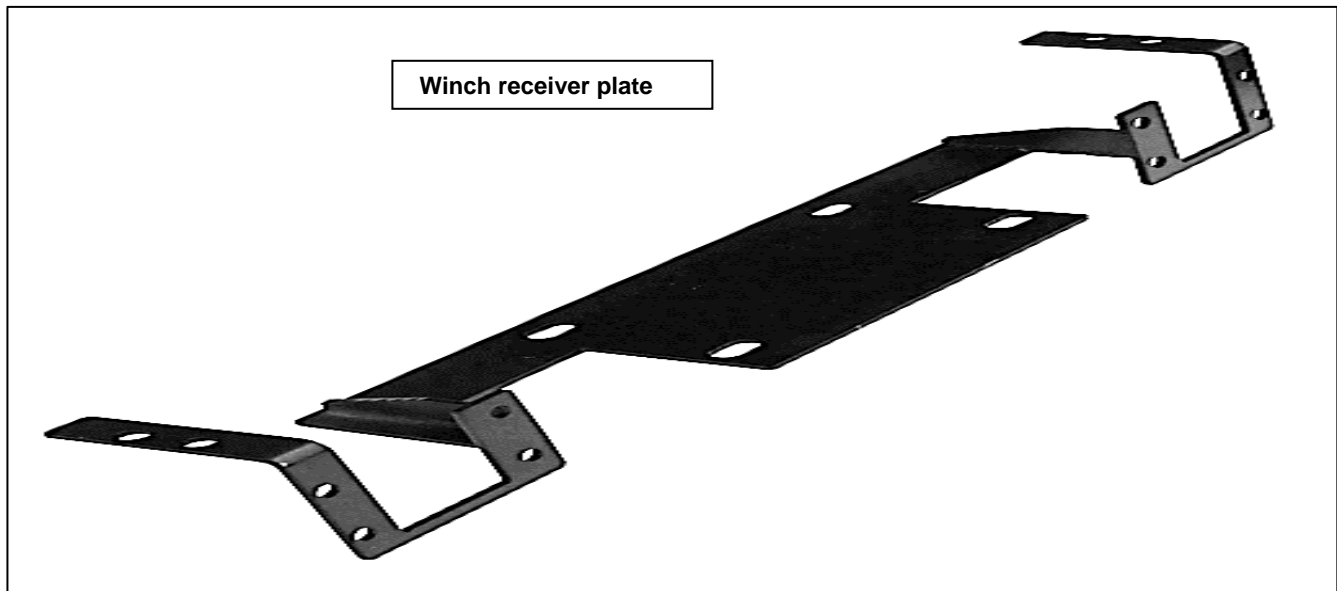

PROCEDURE:

- 1. REMOVE CONTENTS FROM BOX. VERIFY ALL PARTS ARE PRESENT. READ INSTRUCTIONS CAREFULLY BEFORE STARTING INSTALLATION.**
- 2. Please NOTE:** This part is an addition to part # AL15600 & will be installed on your JK after **(Steps 3 to 8 have been completed on new installs.** If your JK already has the AL15600 installed please remove it and then follow **(Step 10 for 2007-11 model years.)** or **Step 13** for model years **2012-14 NOTE:** Cutting of the factory air pump bracket will need to be performed for relocation & fitment of the 15600WRB for model years 2012-14 **(Step 13** for reference)
- 3.** Start by removing front plastic skid shield from under the vehicle, using a flat tip screwdriver pry and remove the plastic push pins holding the skid shield, seen in **(Fig 1 & 1A)**
- 4.** Once removed start to remove the top plastic cover there are 2 push pins holding the plastic cover in front of the grill, as seen in **(Fig 2)** with the plastic push pins removed, slide the cover to the left side to allow for access of the inner nuts holding the bumper onto vehicle, as seen in **(Fig 3 & 3A),** once done continue to remove driver side by sliding plastic to the right side **(Fig 4 & 4A)** shows location of nuts to be removed.

5. Once inner nuts are removed begin to unplug the road lights from the factory wire harness, and unclip the harness from the bumper cover, as seen in **(Fig 5)** once done, remove the outer nuts holding the bumper onto the vehicles frame. as seen in **(Fig 5A & 5B)**
6. With the factory bumper removed, Select the Passenger & driver side bumper corners and mount each side to the center section of your new bumper, with the supplied (12) 10mm hex bolts, (24) 10mm flat washers, (12) 10mm lock washers & (12) 10mm nuts as seen in **(Fig 6 & 6A)** Snug fasteners as you go along once all fasteners are secure and your happy with the alignment tighten hardware.
7. Once corners are assembled to the center section, begin to install the upper tubes secure the right & left sides with the (4) 12mm hex bolts, (4) 12mm x 30mm OD flat washers and (4) 12mm lock washers, secure the center section tube with the (2) 12mm hex bolts, (2) 12mm x 24mm OD flat washers and (2) 12mm lock washers as seen in **(Fig 6 & 6A)** align & tighten all hardware.
8. Next remove the factory road lights from the factory bumper and begin to install them into the new bumper with the (3) 4mm Socket cap screws, (6) 4.25mm flat washers & (3) 4mm lock nuts per side as seen in **(Fig 7)** align & tighten all hardware.
9. **If you purchased the optional 15600WRB for model years 2007-11 follow STEP 10 NOTE: For years 2012-14 models you will need to relocate the air pump first before installing the 15600WRB Step 12**
10. **2007-2011 MODELS** Place the 15600WRB on an angle leaning forward as seen in **(Fig 7A)** then up and into place pull forward to allow it to sit into place as seen in **(Fig 7B)** add (2) 12mm x 40mm Hex bolts, (2) 12mm flat washers per side into the mounting holes on the 15600WRB and through the frame horn followed by (2) speed nuts per side, (the speed nuts will keep the unit from moving) keeping the speed nuts loose to allow for adjustment as seen in **(Fig 7C & 7D)** with this done begin to install your new bumper follow step 11 for 2007-11 models
11. **NOTE: 2007-2011 MODELS** With help, position the new bumper up and over the factory mounting points & secure the new bumper with (4) 12mm x 24mm OD flat washers, (4) 12mm lock washers & (4) 12mm nuts per side, **NOTE:** pending on the year of the vehicle only 2 of the 4 bolts per side will line up when mounting to the factory bumper brackets, as seen in **(Fig 8)** Snug but do not tighten hardware, Plug in the road lights with the wire harness and secure harness to bumper.
12. Level and adjust the bumper and tighten all hardware, Install is now complete.
13. **NOTE: FOR 2012-14 MODELS;** With the factory bumper or the AL15600 bumper removed you will see the air pump on the driver's side front of frame horn **(Fig 9 shows location)** remove the (2) factory nuts securing it to frame bracket once removed slip it off the factory studs and temporarily move it just off to the side, next you will need to cut off the factory support bracket with a grinder with a cut off wheel **(Fig 9A & 9B show bracket & location of where to cut off)**. With bracket removed you can install the 15600WRB as seen in **(Fig 7A)** then up and into place pull forward to allow it to sit into place as seen in **(Fig 7B)** add (2) 12mm x 40mm Hex bolts, (2) 12mm flat washers per side into the mounting holes on the 15600WRB and through the frame horn followed by (2) speed nuts per side, (the speed nuts will keep the unit from moving) keeping the speed nuts loose to allow for adjustment as seen in **(Fig 7C & 7D)**.
14. With help, position the new bumper up and over the factory mounting points & secure the new bumper with (2) 12mm x 24mm OD flat washers, (2) 12mm lock washers & (2) 12mm nuts per side, **NOTE:** pending on the year of the vehicle only 2 of the 4 bolts per side will line up when

mounting to the factory bumper brackets, as seen in **(Fig 8)** Snug but do not tighten hardware, Plug in the road lights with the wire harness and secure harness to bumper.

15. Next select the air pump support bracket and air pump support bracket plate, place the support bracket in from under & behind the bumper and secure it with the support plate to the bumper using the 8mm hex bolt & lock washer snug but do not tighten as seen in **(Fig 10 & 10A)** with the bracket attached to bumper secure the air pump to the bracket with the 6mm hardware Snug but do not tighten as seen in **(Fig 11)**

16. Level and adjust the bumper and tighten all hardware.

17. Do periodic inspections to the installation to make sure that all hardware is secure and tight. **To protect your investment**, wax this product after installing. Regular waxing is recommended to add a protective layer over the finish. Do not use any type of polish or wax that may contain abrasives that could damage the finish.

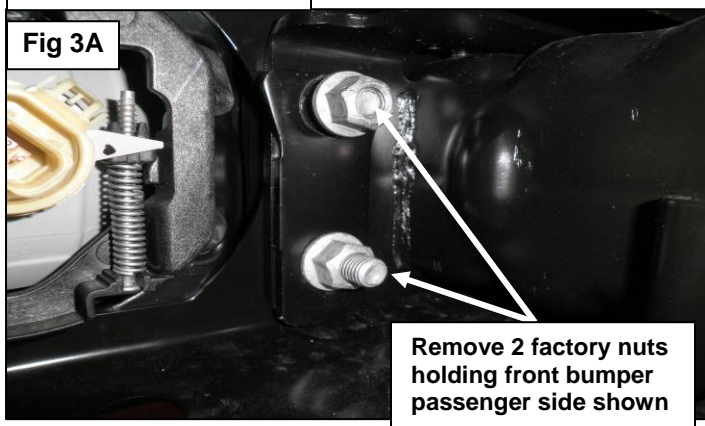
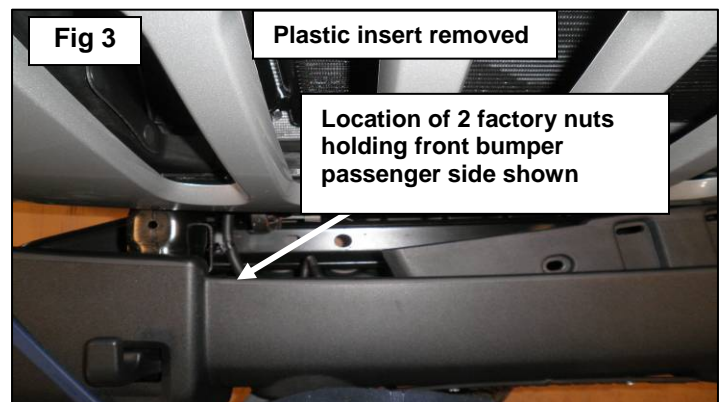
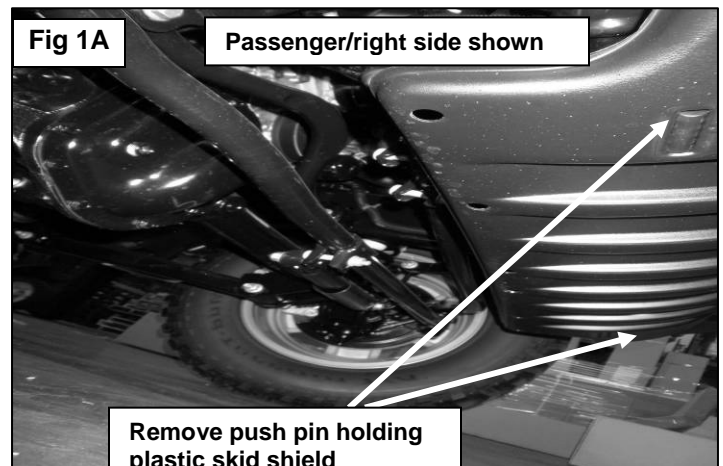
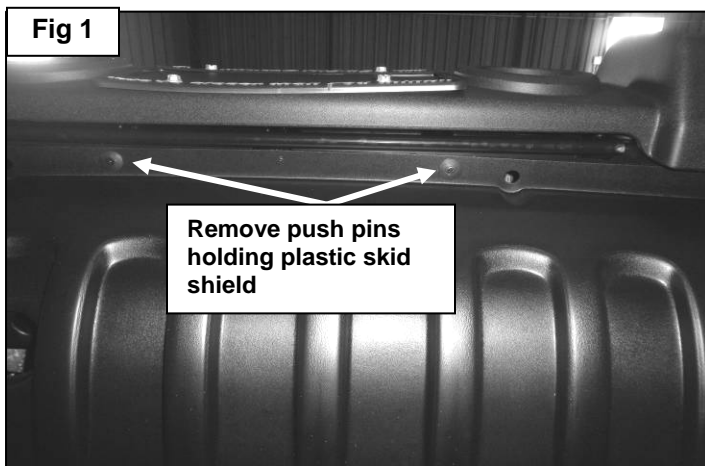

Driver/left side shown

Fig 4A

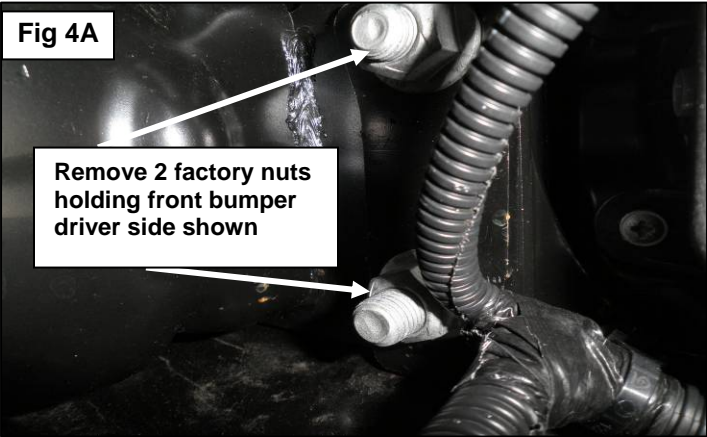

Remove 2 factory nuts holding front bumper driver side shown

Fig 5

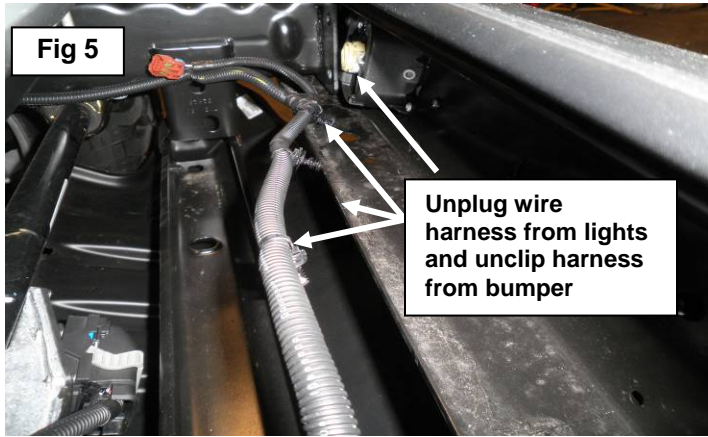

Unplug wire harness from lights and unclip harness from bumper

Fig 5A



Remove 2 factory nuts holding front bumper driver side shown

Fig 5B

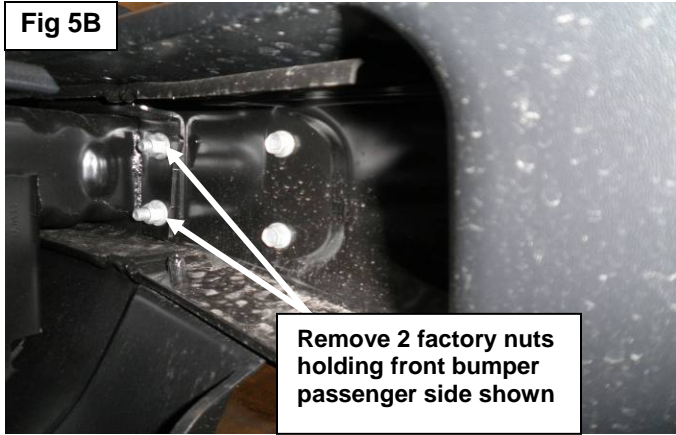

Remove 2 factory nuts holding front bumper passenger side shown

Fig 6

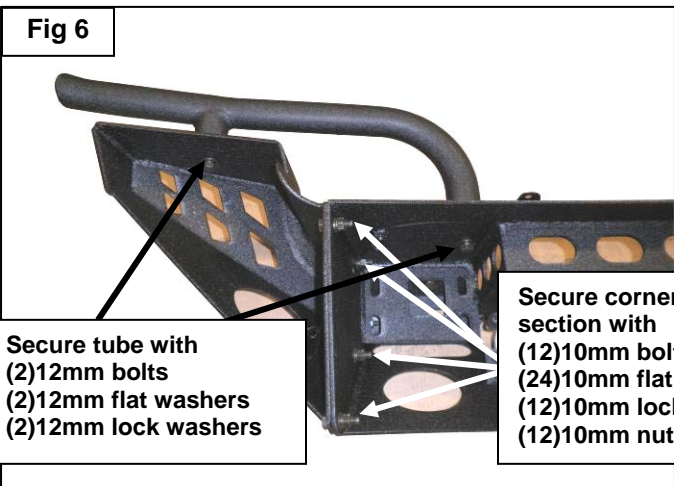

Secure tube with (2)12mm bolts (2)12mm flat washers (2)12mm lock washers

Secure corner to center section with (12)10mm bolts (24)10mm flat washers (12)10mm lock washers (12)10mm nuts

Fig 6A

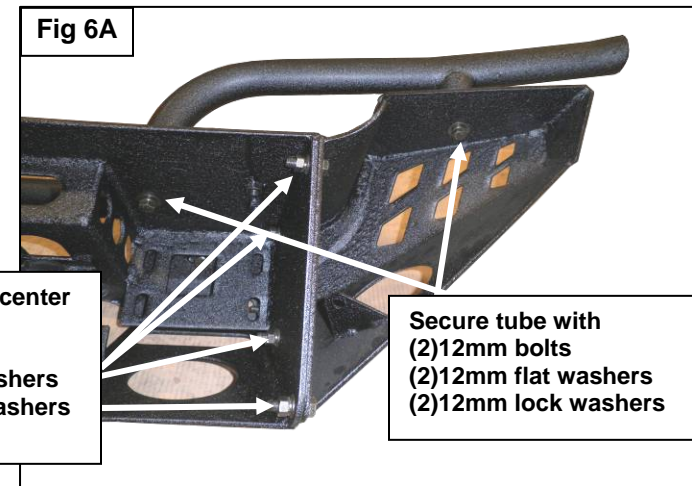

Secure tube with (2)12mm bolts (2)12mm flat washers (2)12mm lock washers

Fig 7



Secure road lights to center section with (3) 4mm Socket cap screws (3) 4mm Lock nuts (6) 4.25mm flat washers Per side

