

INSTALLATION INSTRUCTIONS

⚠ WARNING: DO NOT EXCEED PRODUCT RATING OR TOW VEHICLE LAMP LOAD RATING, WHICHEVER IS LOWER

APPLICATIONS

Make	Model
Honda	Pilot

WIRING LOCATION GUIDE

SUVs, MINI & FULL-SIZED VANS (S)

Representative vehicle shown below

S3 - Behind driver side rear access panel

S5 - Behind driver side rear bumper

CUSTOM WIRING CONNECTOR

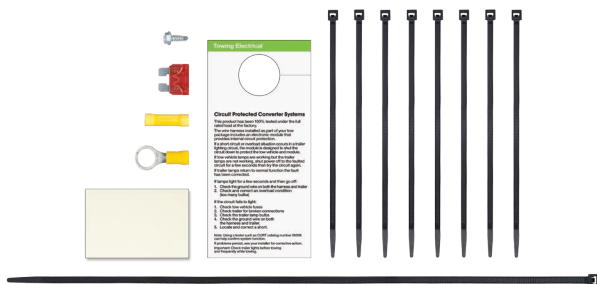
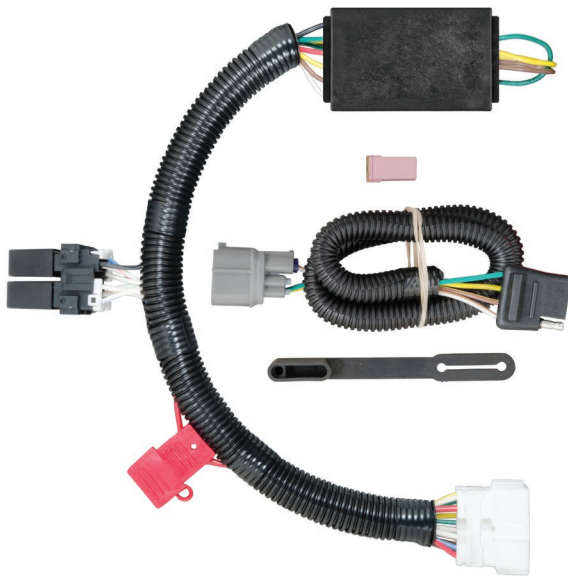

NOTICE

All steps must be followed to ensure the wiring connector will function properly. Once installed, test for proper function by using a test light or connecting a properly wired trailer.

TOOLS NEEDED

- Ratchet
- 10mm socket

⚠ WARNING

The battery connection must be fuse-protected, 10-amp max. Exceeding the product rating can cause loss of warranty, overheating and potential fire. Do not exceed product rating or tow vehicle lamp load rating, whichever is lower.

- Signal Circuits - 3.0 amps per side
- Tail / Running Circuits - 6.0 amps total

Check vehicle owner's manual or contact the vehicle manufacturer for more information.

INSTALLATION / SAFETY INSTRUCTIONS

Step 1

Open the vehicle tailgate. Fold down the driver side rear seat to access the interior trim panel (A).

Step 2

On the interior trim panel, remove the access cover labeled 'AUX FUSE' (B).

Step 3

Locate the vehicle trailer wiring harness connector. The connector will be similar to the one on the custom wiring connector (C).

Step 4

Insert the vehicle trailer wiring harness connector into the custom wiring connector. Make sure the connectors are fully inserted with locking tabs in place.

 **WARNING:** Check for miscellaneous items that may be hidden behind or under any surface before drilling to avoid damage and / or personal injury.

Step 5

Locate a flat spot behind the removed access panel. Adhere the black converter box using the provided double-sided tape. Secure the remainder of the connector with the provided cable ties.

Step 6

On the driver side, behind the rear bumper fascia, above the tail pipe, locate the grey trailer wiring harness connector. Release connector from its clip and remove the cover from the housing. Insert the 4-flat harness connector. If the cover is not present, be sure the connector and contacts are free of dirt and debris. Make sure that the housings are fully inserted with locking tabs in place (D).

Step 7

When in use, route the 4-flat along the rear bumper to the center of the vehicle. When not in use, roll up and store in a convenient, out of the way location. Secure any loose wires with the provided cable ties.

Step 8

Reinstall all items removed during install and reconnect negative battery terminal. Install the provided 4-flat dust cover to prevent corrosion.

Step 9

Locate vehicle fuse box in the engine compartment on the driver side (E). Insert tow / trailer fuse provided (F). Check the vehicle owner's manual for location or contact the vehicle manufacturer for more information.

